

Works Notification

Upcoming works at Burke Road Ringwood-bound exit ramp, Kew East

June 2026

We're upgrading the Eastern Freeway with smart technology, a new Eastern Busway, new and upgraded walking and cycling paths, and a connection to North East Link – slashing travel times and improving travel in Melbourne's east.

What we're doing

From **9pm Friday 26 June to 5am Monday 29 June** we'll close the Burke Road Ringwood-bound exit ramp to safely move traffic onto reconfigured lanes. This will create a safe work area to support construction of a new exit ramp, the Eastern Busway, express lanes, and a new walking and cycling underpass connecting to the Koonung Creek Trail.

Works include:

- Installing and adjusting temporary traffic barriers
- Removing the existing kerb and asphalt and installing new asphalt along the new exit ramp and connections
- Earthworks, pavement and drainage construction
- Installing underground cables for relocated traffic signals and lights
- Removing selected trees and vegetation under arborist supervision.

Where and when

 **24-hour day and night works from 9pm Friday 26 June to 5am Monday 29 June**
Burke Road Ringwood-bound exit ramp, Kew

What to expect

- Closure of the Burke Road Ringwood-bound exit ramp with a detour via Chandler Highway and Heidelberg Road

Sign up for updates
bigbuild.vic.gov.au/roads-subscribe

- Delays of up to 10 minutes are expected during the exit ramp closure
- Construction vehicles, machinery, equipment, and workers in the area
- Medium to high levels of noise, dust and vibration at times
- Use of directional lighting when working at night
- Traffic management on Burke Road to guide drivers, cyclists and pedestrians around our works
- Engaging qualified ecologists and arborists during tree removal to ensure appropriate measures are taken and tree protection is in place for local flora and fauna.

Keeping in touch

We'll be out talking to nearby residents and businesses about these works in more detail, including how we'll be managing any local impacts. If you have any questions, please contact the 24/7 Contact Centre on 1800 105 105.

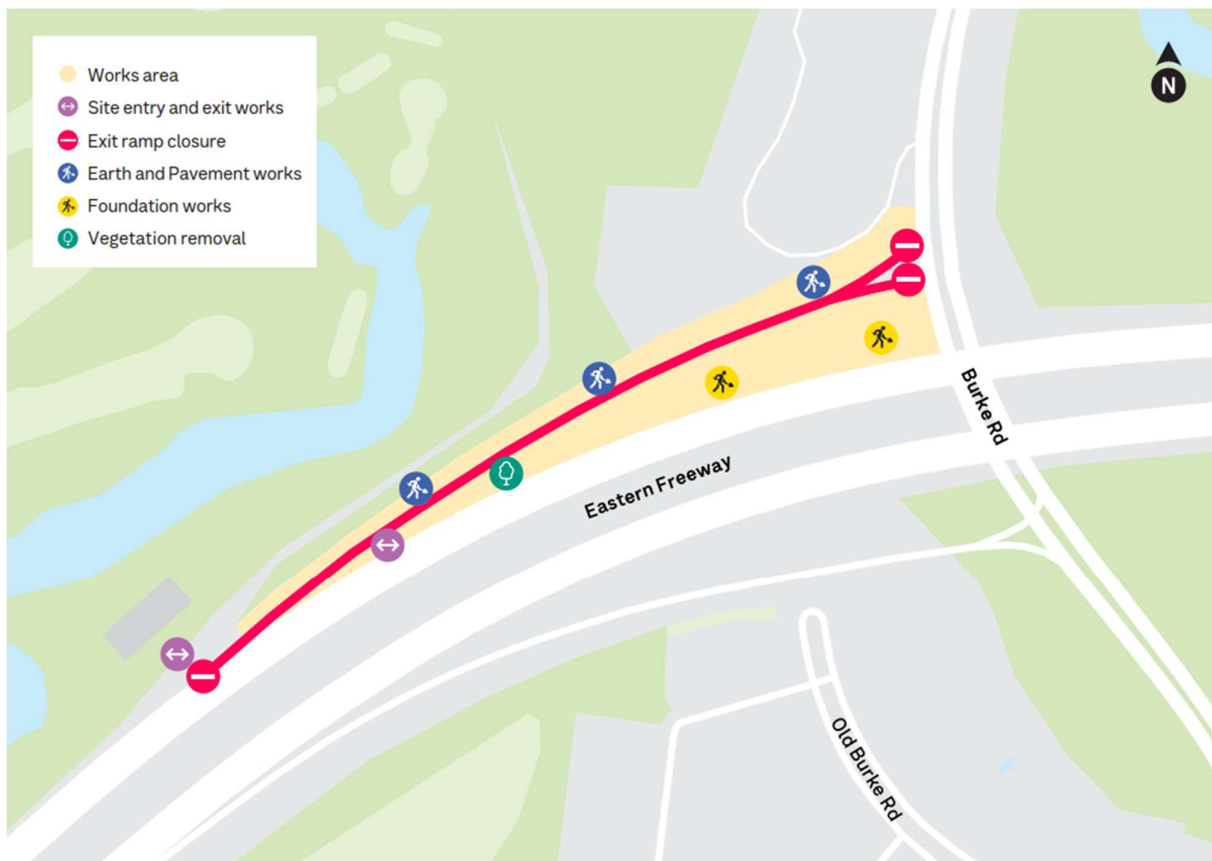

Schedule is subject to change. Visit bigbuild.vic.gov.au/works for schedule changes.
For more information call **1800 105 105** or visit the Hub at **17 Watsonia Road, Watsonia**.

bigbuild.vic.gov.au/roads

contact@bigbuild.vic.gov.au



1800 105 105 (call anytime)



For languages other than
English please call 9209 0147

Please contact us if you would like this information in an accessible format.
If you need assistance due to a hearing or speech impairment, please visit relayservice.gov.au