

17 MAY 2023

Footscray Road – eastbound closed from Saturday, 27 May

We’re building the West Gate Tunnel Project to create an alternative to the West Gate Bridge and take trucks off local roads. As part of the project, an elevated road above Footscray Road is being built to create a link between the new tunnel and the city.

Footscray Road eastbound disruptions

The six-month major construction program is in its final stages. We have spent the past two months lifting concrete segments into place above the westbound lanes on Footscray Road, meaning that around 70 per cent of the elevated road section above Footscray Road is now complete. We will now make the final move back above the eastbound lanes.

From 7am Saturday, 27 May until mid-June, we’ll:

- Reopen the westbound lanes to traffic.
- Close the eastbound/citybound lanes 24 hours, 7 days a week. Detours will be in place via Dynon Road.

Footscray Road will be closed in both directions between Dock Link Road and Appleton Dock Road overnight on Friday, 26 May from 8pm to 7am.

Footscray Road eastbound closure and detour

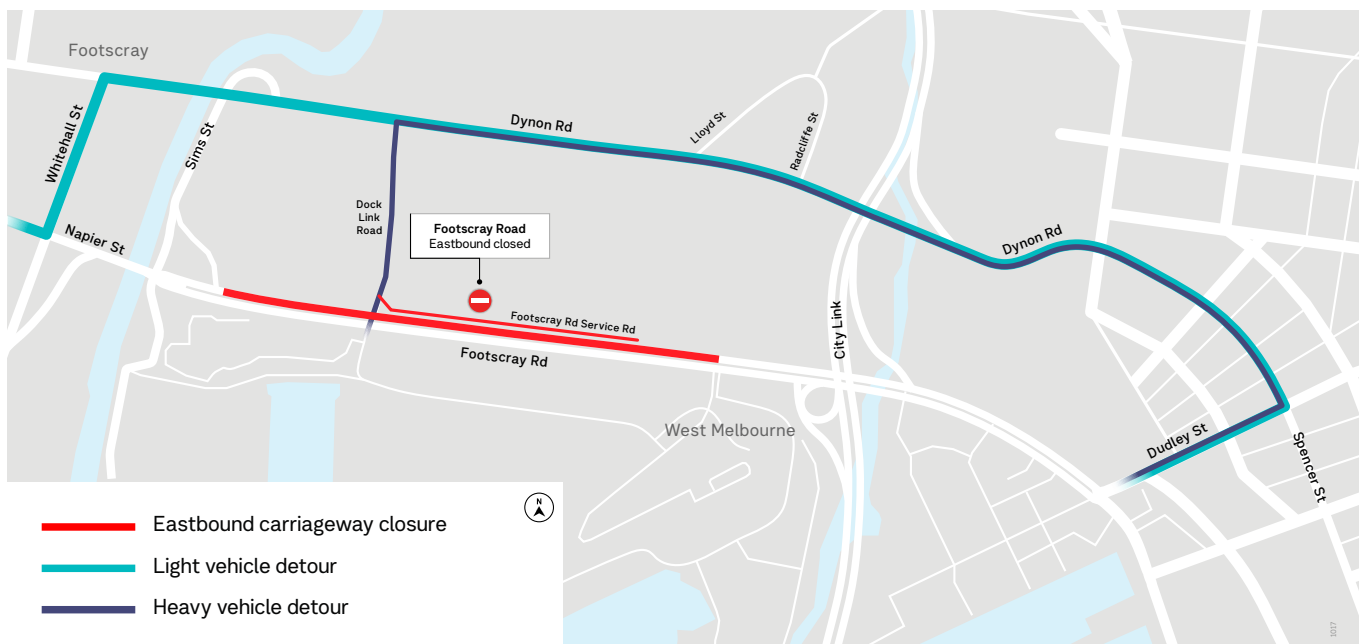

Follow the signs and lane marking, and drive with care.

Footscray Road westbound lanes changes

When Footscray Road westbound reopens, you'll notice changes to the alignment of the lanes, and a section of the walking and cycling path. They will be moved further north to under the elevated road. This allows us to create a new worksite on the existing lanes while keeping the road and path open, and drivers, pedestrians and cyclists safe while we build a new ramp which will connect Appleton Dock Road to the elevated road.

Follow the signs and lane marking, and drive with care.

We'll keep you updated at bigbuild.vic.gov.au/disruptions

Footscray Road westbound lanes changes

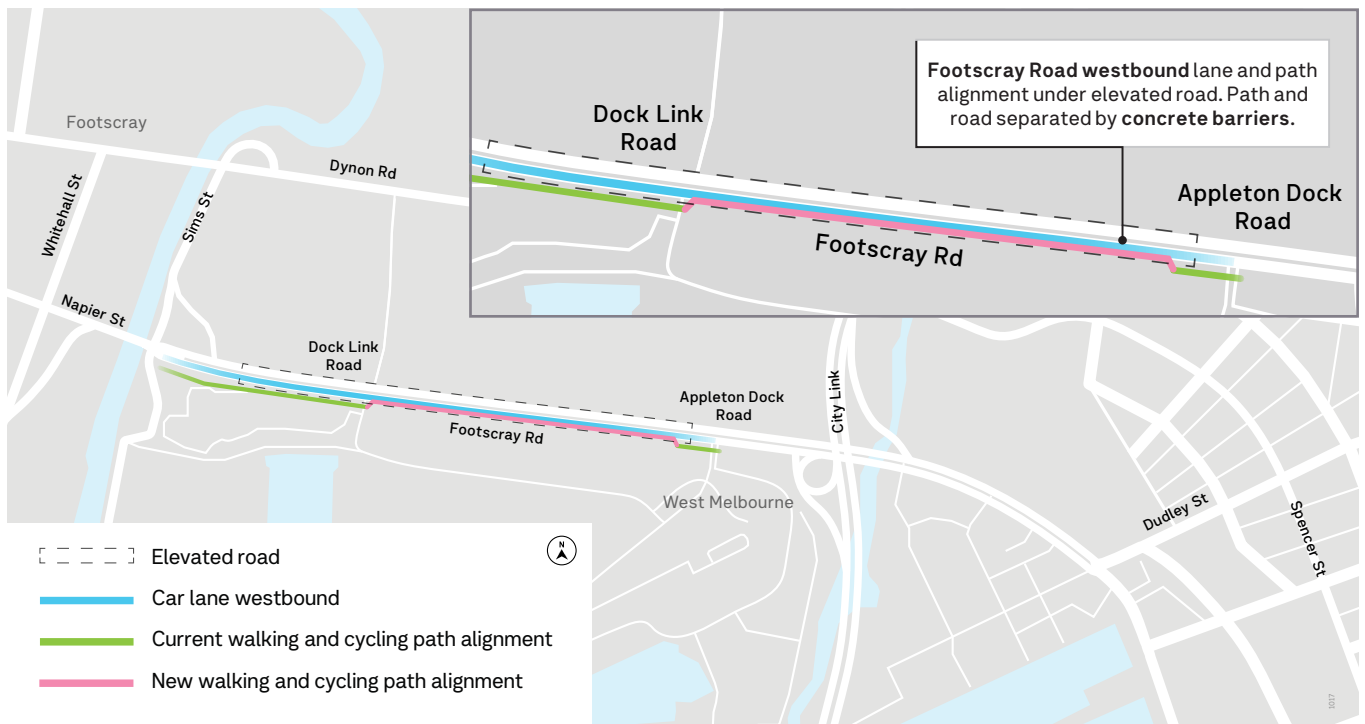

Thank you

We appreciate our work can be disruptive and thank you for your understanding.

To learn more about the impacts, or if you have any questions, please give the team a call on **1800 105 105** or email us on info@wgta.vic.gov.au

westgatetunnelproject.vic.gov.au

1800 105 105 (call anytime)



info@wgta.vic.gov.au



For languages other than English please call 9209 0147

Please contact us if you would like this information in an accessible format. If you need assistance due to a hearing or speech impairment, visit relayservice.gov.au

