

Construction update



Town Hall Station

April 2024

Construction of the Metro Tunnel Project's Town Hall Station has entered a new phase, including works on the station entrances at Swanston and Flinders streets and at City Square, as well as the fit-out of the underground station and reinstatement of community space.

Works snapshot: April

In March we completed surface works within Flinders Lane, Scott Alley, Cocker Alley and Manchester Lane, to prepare the area for future pedestrian access into Town Hall Station. We appreciate and thank nearby businesses and residents for their patience and cooperation over the last two and a half months while we undertook this work.

Construction works within the Town Hall Station precinct during April 2024 include:

- Station entrance construction within the City Square and Flinders Quarter sites
- Station build-out works

- Station passenger area and operational rooms construction and fit-out
- Campbell Arcade restoration works including fit-out of the underground passenger connection to Flinders Street Station
- Lift installations within the Degraves Subway at Flinders Street Station
- Pedestrian ramp widening works on Collins Street and Swanston Street
- Train testing through the tunnel.

Further information on these works can be found overleaf or at metrotunnel.vic.gov.au

Business support

While the new Town Hall Station will be a significant boost for the local area, construction activities can impact local businesses. In response to this, our Business Support Team assists businesses through the disruption and any permanent changes that will take place.

Please see the promotion in this notification for the **businesses on Scott Alley who have recently re-opened in the freshly paved laneway**. We look forward to promoting more local businesses as the project progresses.



Sign up for updates
Subscribe for email and SMS updates
at metrotunnel.vic.gov.au/subscribe

Construction partner:



Cross
Yarra
Partnership



When are we working?



Normal construction hours

7am to 6pm, Monday to Friday
7am to 1pm, Saturdays



Out of hours

Some works are required to take place out of normal construction hours



24 hours

24 hour works are sometimes required during peak construction activities



Concept image - City Square reopened with new landscaping and station entrance

Upcoming works in your area

City Square site

**24-hours, Monday to Friday
7am to 2pm, Saturdays (as required)**

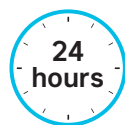

When Town Hall Station opens, the City Square station entrance will lead into an expansive underground passenger foyer, with lifts and escalators transporting passengers down to the customer and ticketing area, towards the train platforms.

Above ground, City Square will be reinstated as a public gathering space, fully landscaped for the whole community to enjoy.

Works occurring this month include:

- Construction of the passenger concourse which involves the use of the tower cranes, concrete pumps, and other tools and equipment to undertake steel fixing, waterproofing, formwork installation and concrete pours
- Installation of infrastructure to support mechanical, electrical and plumbing services
- Concrete trucks will access the loading bays on Collins Street and Flinders Lane. Concrete pours involve regular deliveries, the use of concrete trucks, concrete pumps and concrete finishing equipment
- Major concrete pours can take between 10-20 hours with all concrete pumps in use to achieve the volume of concrete required. Concrete pours must be continuous to ensure structural integrity and therefore may continue outside of normal construction hours
- Ventilation equipment operation will be required during all works below ground, and site lighting will be required for evening and overnight works

- There will be regular truck movements to deliver and remove equipment and construction materials via the Collins Street and Flinders Lane loading bays
- These works are expected to generate low to medium levels of noise
- Steel crypt branches will be installed via the Flinders Lane and Collins Street loading bays to support upcoming ground floor placements
- There will be some service investigation works within the Collins Street loading bay at night. This will require the use of a non-destructive digging truck and will generate some periods of medium level noise during the night.

Pedestrian pram ramp widening

Collins Street and Swanston Street

**8pm to 6am, Monday to Friday
Late April and early May**



- Works will take place in late April and early May to widen the pedestrian pram ramps on the northern side of Collins Street at the Swanston Street intersection
- These works will require 24-hour narrowing of the pedestrian crossing and will include concrete demolition, excavation, steel fixing and concrete pours
- These works are expected to take up to two weeks and generate some periods of high level noise and some vibration.

Flinders Quarter site

24-hours, Monday to Friday
7am to 10pm, Saturdays and Sundays
(as required)



When Town Hall Station opens, the station entrance building located on Swanston and Flinders streets will lead into an expansive underground passenger foyer, with lifts and escalators transporting passengers down to the customer and ticketing area, towards the train platforms.

Works occurring this month include:

- Construction of the passenger concourse which involves the use of the tower crane, mobile surface cranes, concrete pumps, and other tools and equipment to undertake shotcreting, steel fixing, waterproofing, formwork installation and concrete pours including hydro scabbling
- Installation of infrastructure to support mechanical, electrical and plumbing services
- Works are continuing to complete pile demolition involving excavators on the lower level of the site in preparation for the ground floor concrete pour
- Concrete pours involve regular deliveries via the loading zone on Flinders Street, and the use of concrete trucks, concrete pumps and concrete finishing equipment
- Major concrete pours can take between 10-20 hours with all concrete pumps in use to achieve the volume of concrete required. Concrete pours must be continuous to ensure structural integrity and therefore may continue outside of normal construction hours
- Ventilation equipment operation will be required during all works below ground, and site lighting will be required for evening and overnight works
- There will be regular truck movements to deliver and remove equipment and construction materials via the Flinders Street loading zone and Swanston Street driveway
- Due to road permit requirements, large plant will occasionally be delivered and demobilised from the site outside of standard construction hours
- There will be some service investigation works within the Swanston Street western footpath at the site entrance during the night. This will include the use of an NDD truck and require overnight footpath closures with diversions in place
- There will be some modification works undertaken to the overhead gantry on Swanston Street. These works will require overnight footpath closures at the site entrance on Swanston Street.
- There will be investigation works on the facades of buildings on Flinders Street between Swanston and Degraes. These works will require overnight footpath closures and will generate some periods of medium level noise.

Service investigation works

Swanston Street

8pm to 6am, Monday to Thursday
Early to mid-April



- Works will take place to investigate underground services on Swanston Street near the Flinders Quarter site entrance
- These works will include the use of a non-destructive digging truck and will require saw cutting
- There will be some periods of medium to high level noise throughout the night
- During works, the Swanston Street footpath between the Nicholas Building and Young and Jackson will be closed. Pedestrians will be detoured onto the Swanston Street eastern footpath
- Access to businesses will be maintained at all times.

Scott Alley and Cocker Alley light installation

10pm to 6am
For up to 4 nights



- Works will take place on Scott Alley and Cocker Alley to install new light fixtures
- Works will include the use of elevated work platforms and hand tools
- They will generate some periods of medium level noise.

Flinders Lane light pole installation

8pm to 6am
For up to 2 nights



- In early April works will take place over two nights to install light poles on Flinders Lane between Swanston and Degraes streets
- These works will include some short periods of saw cutting, light pole installation using a small crane and concreting of footings
- Flinders Lane will be closed to traffic between Swanston and Elizabeth streets
- Access to carparks will be maintained via Elizabeth Street during these works and pedestrians will be diverted to the northern Flinders Lane footpath.

Scott Alley and Cocker Alley gantry installation

24-hours, Monday to Friday
7am to 1pm, Saturdays (as required)



- Works to install overhead protection gantries in Scott and Cocker alleys will take place in April
- These gantries ensure the laneways are safe to access while above ground construction is underway
- These gantries will cover approximately five metres overhead from the site boundaries and will allow above ground construction at the site to take place whilst the laneways remain operational
- Once the protection gantries are installed, they will not impact on the operation or access to the laneways, or encroach on windows, doors or balconies of surrounding buildings
- Works will include the use of rattle guns, hand tools and the tower crane to erect steel to form the gantry
- These works will generate some periods of medium to high level noise. Every effort will be made to undertake noisier works during daytime hours.

Federation Square site



24-hours, Monday to Sunday

Federation Square will be an entrance point to Town Hall Station, providing passengers with new access to this vibrant public space and the nearby arts and sporting precincts.

Works occurring this month include:

- Construction and fit-out of the station passenger areas and operational rooms, including installation of waterproofing materials, steel, and concrete
- There will be regular truck movements to deliver and remove equipment and construction materials
- Works to excavate the escalator shaft at Federation Square are ongoing. This work is taking place within the acoustic shed, however, some excavation works will include the use of an excavator with a hammer attachment and are expected to generate some periods of high level noise
- As part of this work an extraction fan has been installed so that the team can work safely to excavate underground. The fan will generate some periods of medium level noise and vibration.

Flinders Street Station

7am to 6pm, Monday to Friday
7am to 1pm, Saturdays



- Works to restore Campbell Arcade and construct the future underground pedestrian connection between Town Hall Station and Flinders Street Station, known as the 'Flinders Link', are ongoing
- Works to install lifts between the Degraeves Subway and platform level at Flinders Street Station will continue. These works will be carried out behind the blue hoarding on the Flinders Street Station platforms.

Works area map

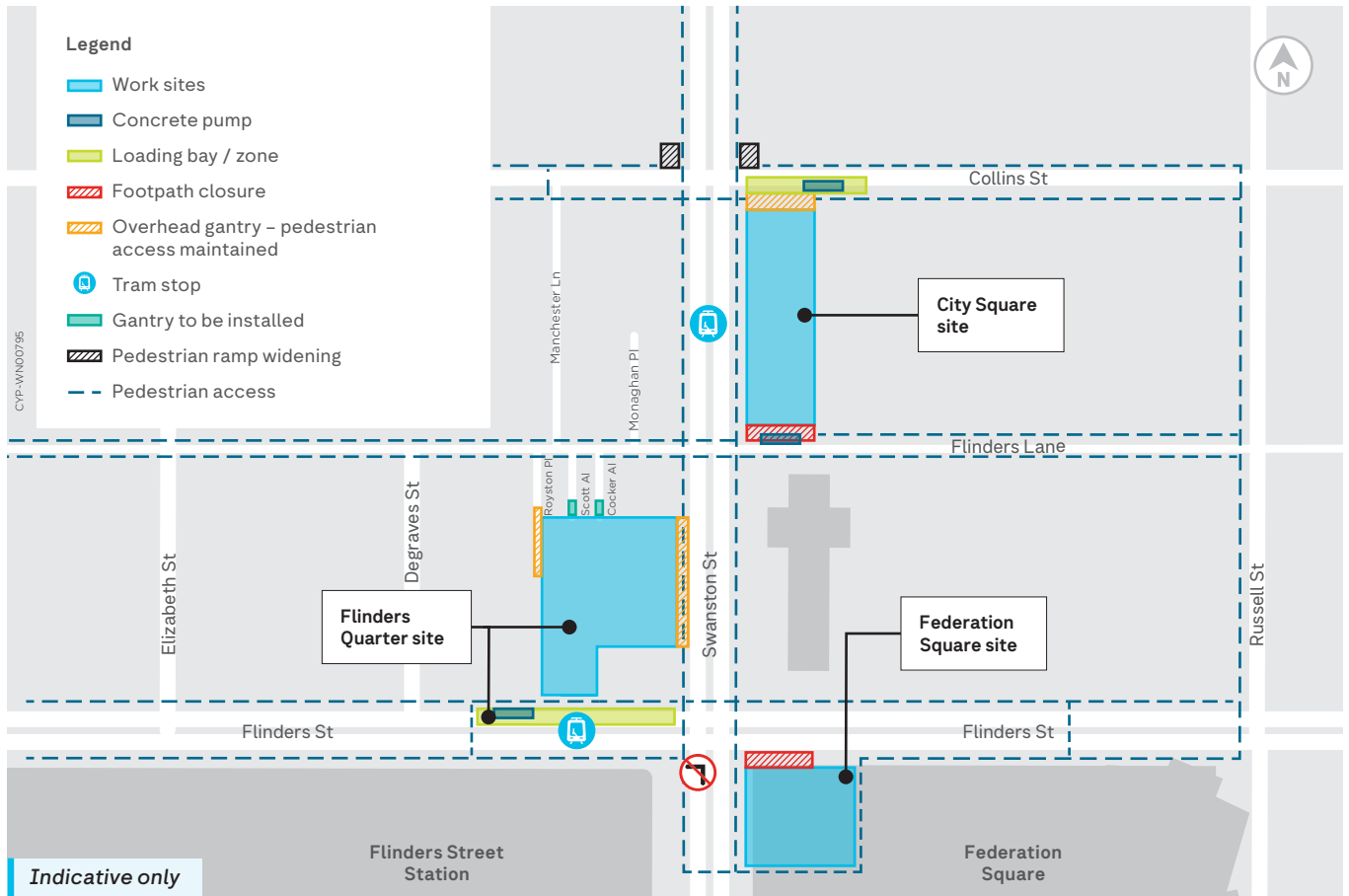

Find out more
metrotunnel.vic.gov.au

1800 105 105 (call anytime)



For languages other than English please call (03) 9209 0147



Please contact us if you would like this information in an accessible format. If you need assistance due to a hearing or speech impairment, visit relayservice.gov.au





Scott Alley is now open for business

Works are now complete on Scott Alley to prepare the laneway to be a pedestrian entrance to the new Town Hall Station. Your favourite businesses are now open and looking forward to seeing you.

Please stop by, check out the laneway and support them.

