

APPROACHING HALF WAY

Artist's impression of the Craigieburn Road Upgrade

CRAIGIEBURN ROAD UPGRADE

DECEMBER 2022



Craigieburn Road works accelerating to the half-way mark.

Road users living in the north's fastest growing community will benefit from extra lanes and upgraded intersections in the new year.

As the Craigieburn Road Upgrade powers towards the half-way mark residents will start experiencing the benefits of the upgrade at both ends of the road.

From late February residents will enjoy upgraded intersections at Hume Highway, Hardy Avenue and Walter Street.

These upgrades allow for better and safer access to key locations such as the Craigieburn Train Station, Craigieburn Plaza and surrounding

businesses, as well as improved access to Hume Highway. This will be followed by the opening of the Mickleham Road intersection at the western end of the project in March.

The southern section of Aitken Boulevard will be closed from January for several weeks to fast track the construction of the new Aitken Boulevard traffic lanes.

During this time, key local roads which are vital connections into residential areas will reopen, beginning with Vantage Boulevard, Waterview Boulevard and Bridgewater Road.

We thank the Craigieburn community for their patience. We understand the impacts can

be frustrating and while there is still a lot of work ahead, we're nearing halfway and opening roads as we go to help you move better through the local area.

Inside pages:

Upcoming closures:

- Craigieburn Road closed January to February
- Aitken Boulevard closed January for several weeks
- Bridgewater Road closed throughout January.

Back page:

Works up to Christmas.



Sign up for updates
Subscribe for email and SMS updates
at roadprojects.vic.gov.au/subscribe



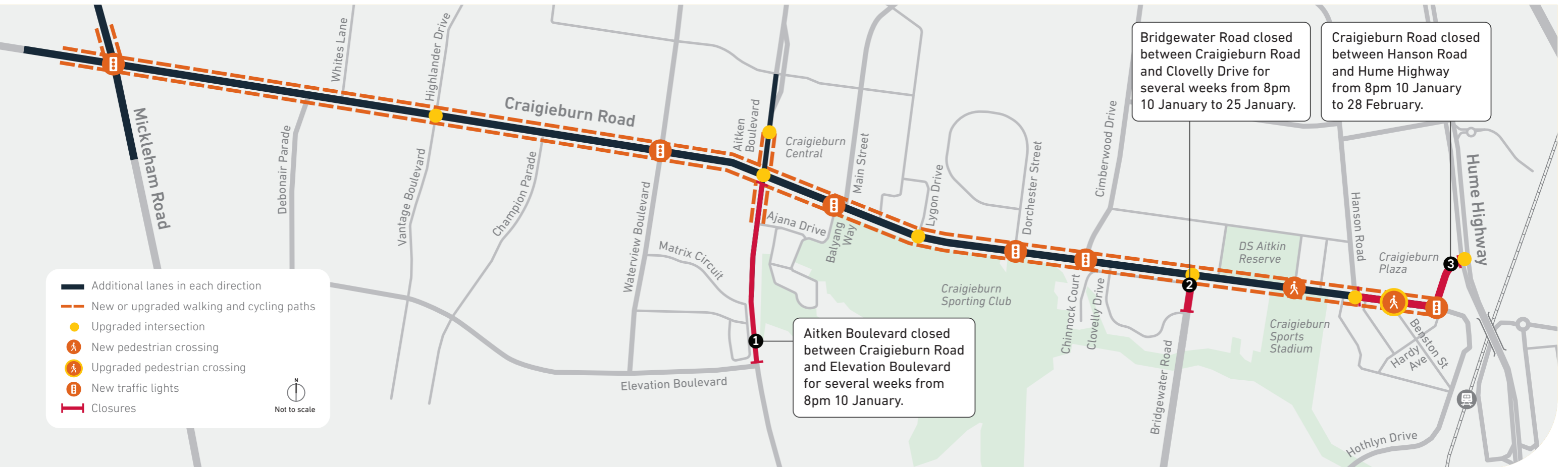

Summer closures

We're taking advantage of quieter traffic in January 2023 to accelerate the upgrade of Craigieburn Road, including works in Aitken Boulevard and Bridgewater Road.



1. Aitken Boulevard – Craigieburn Road to Elevation Boulevard

From 10 January 2023, Aitken Boulevard will be closed for several weeks between Craigieburn Road and Elevation Boulevard while we undertake major road and intersection construction works.

We're taking advantage of the holiday period and lower traffic volumes to get a head start on this important work at a significant Craigieburn intersection.

We'll be building new drainage, completing earthworks and constructing new pavement, kerbing and asphaltting the new lanes, and installing street lighting. We'll also be building new shared use paths to connect local neighbourhoods.



2. Bridgewater Road at Craigieburn Road

From 10 January to 25 January, Bridgewater Road will be closed between Craigieburn Road and Clovelly Drive with some short-term closures of Craigieburn Road between Glade Avenue and Selwyn Avenue, at the Bridgewater Road intersection.

During this closure we'll undertake major construction works at the intersection of Craigieburn Road and Bridgewater Road.

Bridgewater Road will reopen with lane restrictions in time for the start of the new school year.



3. Craigieburn Road – Hume Highway to Hanson Road

From 10 January to 28 February 2023, Craigieburn Road will be closed between Hanson Road and Hume Highway while we work 24/7 to "blitz" through nine months' worth of road construction work in seven weeks.

These works will include earthworks and drainage, pavement works, installing traffic signals and street lights, and asphaltting. We're planning to complete all of the major works at this end of Craigieburn Road in one go, so that we don't need to disturb these residents, shops and businesses again. We'll come back later to complete landscaping, finishing works and a final, finishing layer of asphalt.

There will be no access to Hume Highway from Craigieburn Road during the summer works and there will be changes to traffic, pedestrian and bus access. Please allow up to 20 minutes extra travel time during peak travel times.

Craigieburn's

OPEN

FOR BUSINESS

Works are on. Shops are open!

There may be some temporary changes to how you access businesses along Craigieburn Road as works progress.

Thank you for continuing to support local businesses during the Craigieburn Road Upgrade.

Work up to Christmas

Work at the Hume Highway end of Craigieburn Road has ramped up in the lead up to Christmas, in preparation for a big summer push in January.

Hardy Avenue remains closed at Craigieburn Road until **28 February 2023**, with local access maintained via a detour along Newbold Avenue and Carlisle Street.

In late November we temporarily reduced Craigieburn Road to one lane in each direction between Hume Highway and Hanson Road to do critical drainage works in the lead up to summer works.

Craigieburn Road is also closed overnight from 8pm to 5am, Hume Highway to Hanson Road, until **Thursday 22 December**.

From **5am Friday 9 December** at times there will be no left turns from Craigieburn Road onto

Hume Highway. Detours will be in place via Hanson Road and Kingswood Drive. Please follow on-road detour directions.

Traffic on Walter Street North remains under temporary traffic lights until **Wednesday 21 December**. Motorist should expect some delays at peak times.

Christmas break

Thanks for your patience this year. We'll give you a break from construction from **22 December 2022 to 10 January 2023**, with a sitewide holiday shut-down. Security patrols will remain in place in case any issues come up.

If you have any queries over the holidays, please phone the Major Road Projects Victoria on 1800 105 105.

From our families to yours, we wish you a happy and safe festive season.

Find out more

With an increase in activity across the project, we will be relying more on our digital platforms to bring you the most up-to-date information.

We encourage you to sign up to receive email and SMS project updates by roadprojects.vic.gov.au/signup

Our website also provides information about upcoming works and the latest progress bigbuild.vic.gov.au/projects/mrpv/craigieburn-road-upgrade/project-update

See the design of the Craigieburn Road Upgrade at our interactive map. Visit maps.roadprojects.vic.gov.au/suburban-roads-upgrade-program/craigieburn-road-upgrade

Visit ptv.vic.gov.au for changes to bus stops.

roadprojects.vic.gov.au



For languages other than English please call 9209 0147

1800 105 105 (call anytime)

contact@roadprojects.vic.gov.au



Please contact us if you would like this information in an accessible format. If you need assistance due to a hearing or speech impairment, visit relayservice.gov.au



Australian Government

