

Works notice

Road resurfacing works – intersection closure

Laurens and Queensberry streets,
North Melbourne

Saturday 11 November, 6am to 6pm

On Saturday 11 November, there will be temporary changed traffic conditions on Laurens, Queensberry and Miller streets to enable road resurfacing works at the intersection of Laurens and Queensberry streets.

On **Saturday 11 November**, there will be a single day closure of the intersection of Laurens and Queensberry streets from 6am to 6pm.

The single day closure is required to support road resurfacing and asphaltting works at the intersection of Laurens and Queensberry streets.

During this time, traffic controllers will be in place to maintain local access for vehicles to properties on Laurens Street and sections of Miller and Queensberry streets.

What we are doing

- Profiling and asphaltting the road surface at the intersection of Laurens and Queensberry streets.

What to be aware of

- To safely undertake road resurfacing works, Laurens Street will close to vehicles and cyclists at the intersection of Laurens and Queensberry streets on Saturday 11 November from 6am to 6pm
- During the single day road closure, vehicles and cyclists will be detoured via Dryburgh and Anderson streets
- Traffic controllers will be positioned at the intersection of Miller and Anderson streets, Laurens and Arden streets and Queensberry Street and Munster Terrace to maintain local access for vehicles to properties on Laurens Street and sections of Miller and Queensberry streets
- Local access to Barwise, Laurens, Queensberry and Miller streets will be maintained, with traffic controllers on hand to assist
- Local access to properties will be maintained at all times
- These works are expected to generate periods of low to medium level noise.

When

- 6am to 6pm, Saturday 11 November 2023

Further information on these works can be found at metrotunnel.vic.gov.au

Construction partner:



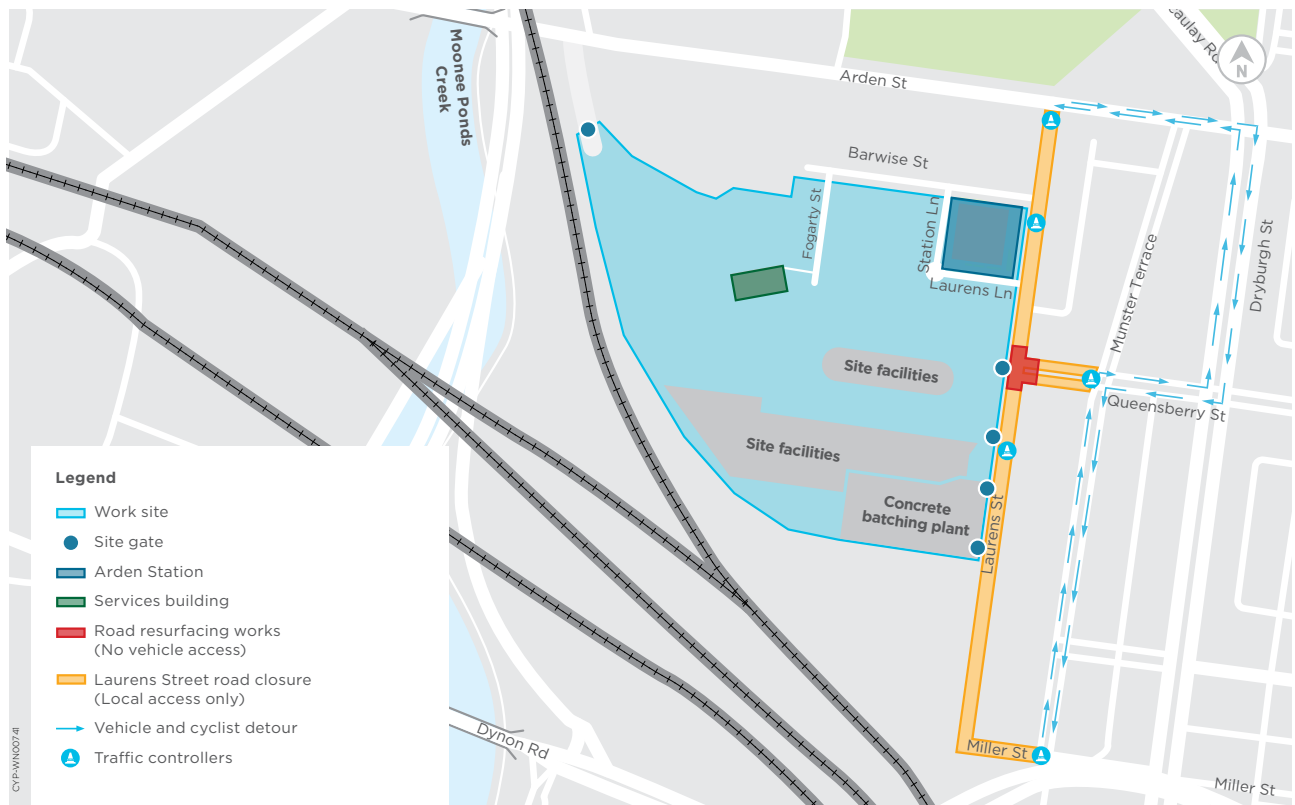

Indicative only

More information

 metrotunnel.vic.gov.au

 1800 105 105
(24 hours a day, 7 days a week)

Rail Projects Victoria
PO Box 2392, Melbourne, VIC 3001



Interpreter Service (03) 9209 0147

It should be noted that this information is current at the time of printing, however due to unforeseen circumstances, changes may occur. Please visit railprojects.vic.gov.au for the latest updates.