

Construction update

South Yarra

November 2023

Major construction of key structures for the Metro Tunnel's tunnel entrance in South Yarra are nearing completion, with construction works now beginning to complete the surrounding infrastructure and roads. This update provides an outline of current and upcoming works in your area throughout November 2023.

Construction snapshot

In October works to reinstate surrounding roads, kerbs and seating were completed along William Street, Arthur Street and in parts of Osborne Street.

Over November works within the South Yarra precinct will focus on internal fit out works at the egress building and continuing reinstatement works. Construction on the Osborne Street shared use path bridge will begin. In November, works within the South Yarra precinct will include:

- Egress building internal fit out and commissioning
- Osborne Street shared-use path (SUP) bridge works
- Removal and alteration of site facilities along Osborne Street
- Landscape maintenance works and installation of public artwork
- 24-hour rail works.

Further information on these works can be found overleaf or at metrotunnel.vic.gov.au

When are we working?



Normal construction hours

7am to 6pm, Monday to Friday
7am to 1pm, Saturdays



Out of hours

Some works are required to take place out of normal construction hours.



24 hours

24 hour works are sometimes required during peak construction activities.

Works in your area

Osborne Street

Egress building internal fit out and commissioning

Ongoing until the end of November 2023



- Building and fit out trades will continue within the egress building 24 hours a day
- During this time you may notice some noise or lights associated with power generators required to safely complete fit out and commissioning works within the egress building.

Osborne Street shared-use path bridge works

November 2023 to March 2024



- Remaining works to complete the Osborne Street shared-use path (SUP) bridge will start in November
- Pre-works will involve establishing the construction site by locating underground services, constructing retaining walls, fencing, backfilling and levelling the site. Once the site has been established, works to construct the foundation for the bridge and ramp will commence before delivering and installing the precast ramp on Osborne Street
- Other works will include installing lighting, pavements, conduits, pits, and hard and soft landscaping
- These activities will involve the use of excavators, Non-destructive digging (NDD), concrete trucks, cranes, watercarts, roller, crews with hand tools and other construction machinery
- Works are expected to generate medium to high levels of noise with low to medium vibration.

South Yarra Siding Reserve, William Street and Arthur Street

Maintenance and remaining works

Ongoing to late-2023



- Maintenance and landscaping works within the parks will continue in November
- Works will involve the use of NDD trucks, concrete trucks and handheld tools
- Works are expected to generate medium levels of noise with some high-level peaks during excavation.

To know more about the South Yarra precinct artwork, please visit bigbuild.vic.gov.au/projects/metro-tunnel/community/art/legacyartwork

Cranbourne and Pakenham lines

Rail maintenance works between South Yarra and Hawksburn stations

Thursday 23 November to Monday 27 November



- Rail maintenance activities will be undertaken including removing and relocating existing rail and signalling assets and upgrading signalling software along the rail corridor
- These works also include testing and commissioning of signalling assets
- These activities will require the use of NDD, excavators, elevated work platforms, cable trucks, tandems, delivery trucks and crews with hand tools
- For the safety of rail users and our workers, these activities can only be performed when trains are not running, therefore bus replacements will operate throughout the duration of these works
- These works are expected to generate medium levels of noise with intermittent periods of high-level noise. Where possible, higher impact works will be scheduled to take place during the day and noise reduction mats will be placed around generators
- Generator-powered lighting towers are required while we complete night works. Where possible, lights will be positioned to face away from residential properties.

Visit ptv.vic.gov.au or call **1800 800 007** for more information and to plan your journey.

High Capacity Signalling technology testing

- Out of hours testing will continue intermittently on the Cranbourne and Pakenham lines throughout 2023 to enable High Capacity Signalling testing.
- Testing of the High Capacity Signalling technology is expected to generate low levels of noise.

To know more about the High Capacity Signalling technology, please visit bigbuild.vic.gov.au/projects/metro-tunnel/about/technology/high-capacity-signalling.

What is Non-destructive digging (NDD?)

Non-destructive digging, or NDD, uses high-pressure water to excavate the ground.

This method enables digging without damaging or impacting the existing ground services, allowing for careful investigation of existing services.

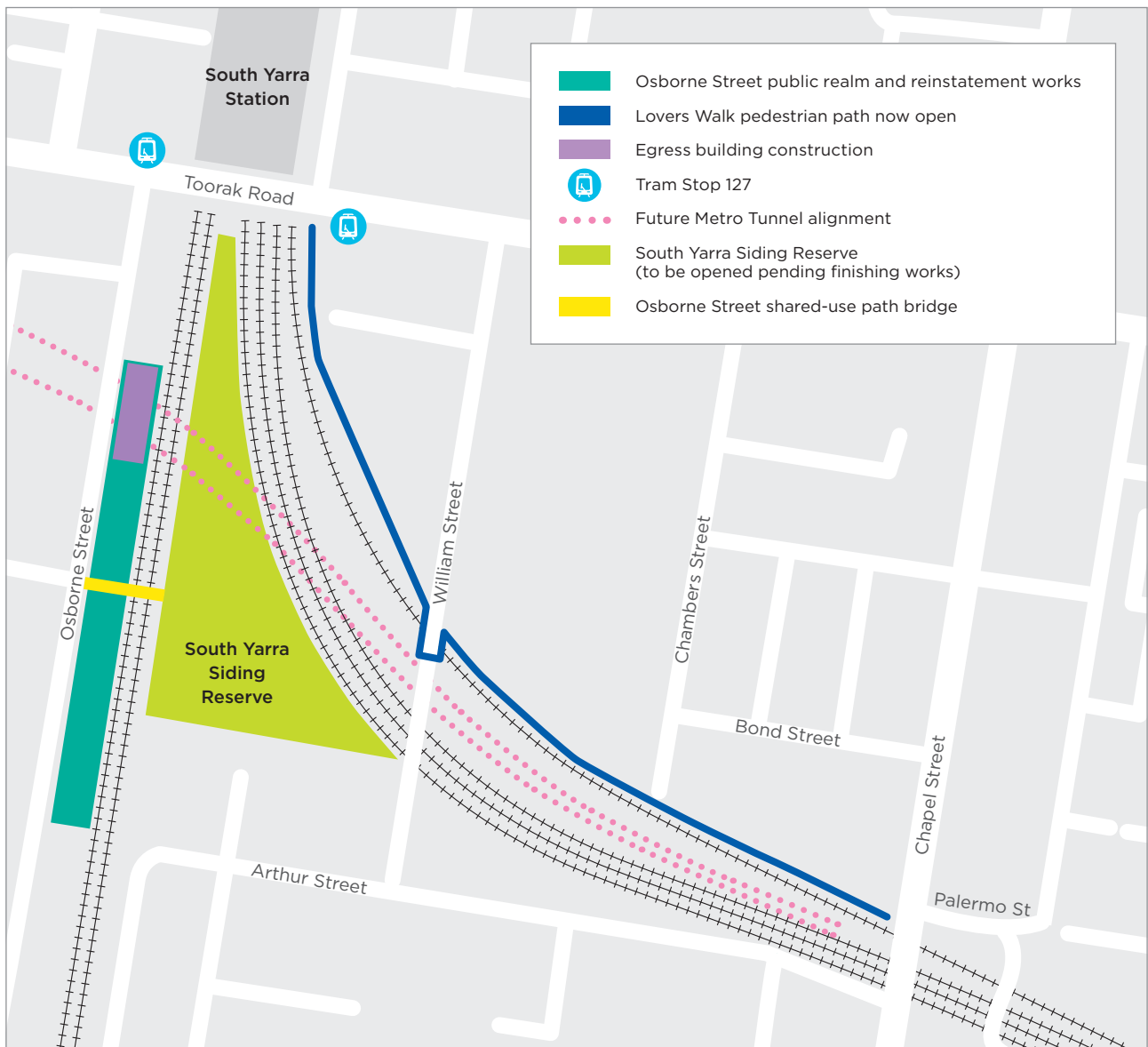

Construction works at the South Yarra eastern tunnel entrance - Indicative only.

Look ahead for 2023

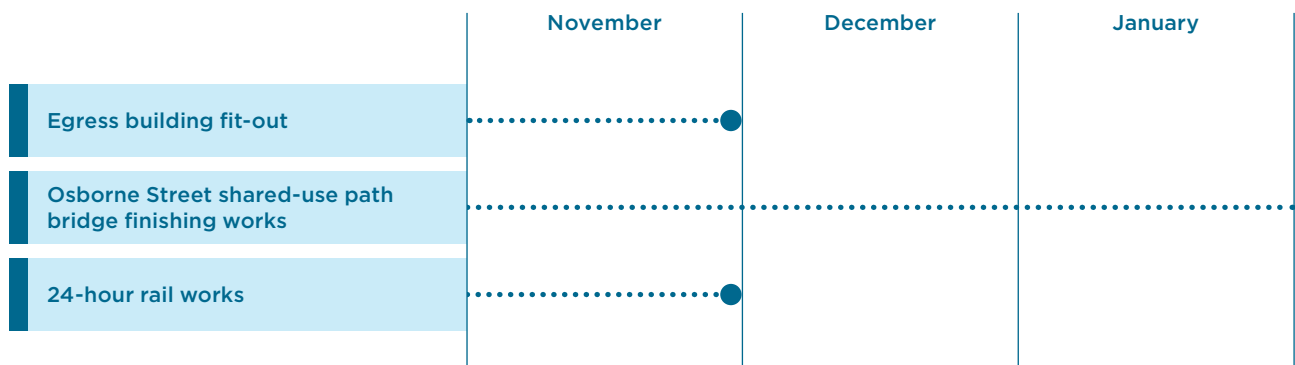



South Yarra precinct

Lovers Walk and William Street reopened

We've upgraded and reopened Lovers Walk and William Street as part of the Metro Tunnel Project.

To enable works at the eastern tunnel entrance, Lovers Walk was closed in October 2018 and William Street bridge was demolished in April 2019.

This allowed the rebuilding of Lovers Walk and William Street bridge to accommodate a widened rail corridor.

At the end of October 2023, we reopened Lovers Walk and William Street bridge as part of works to complete the surrounding infrastructure and roads.

You can now take William Street between Toorak Road and Arthur Street, or Lovers Walk between South Yarra Station and Chapel Street.

More information

 metrotunnel.vic.gov.au

 1800 105 105
(24 hours a day, 7 days a week)

Rail Projects Victoria
PO Box 2392, Melbourne, VIC 3001



Interpreter Service (03) 9209 0147

It should be noted that this information is current at the time of printing, however due to unforeseen circumstances, changes may occur. Please visit railprojects.vic.gov.au for the latest updates.