

# Monthly construction update

## Town Hall Station

November 2023

Construction of the Metro Tunnel Project's new Town Hall Station is entering a new phase, including works on the station entrances at Swanston and Flinders streets and at City Square, as well as the fit-out of the underground station and reinstatement of community space.

### Construction snapshot

Construction works within the Town Hall Station precinct during November 2023 include:

- Station entrance construction within the City Square and Flinders Quarter sites
- Station build-out works
- Station passenger area and operational rooms construction and fit-out
- Protection gantry installations within Cocker Alley, Scott Alley and Royston Place
- Campbell Arcade restoration works including fit-out of the underground passenger connection to Flinders Street Station
- Lift installations within the Degraves Subway at Flinders Street Station
- Reinstatement of the Flinders Street pedestrian crossing between Federation Square and St Paul's Cathedral
- Train testing through the tunnel

Further information on these works can be found overleaf or at [metrotunnel.vic.gov.au](https://metrotunnel.vic.gov.au)

### When are we working?



#### Normal construction hours

7am to 6pm, Monday to Friday  
7am to 1pm, Saturdays.



#### Out of hours

Some works are required to take place out of normal construction hours.



#### 24 hours

24 hour works are sometimes required during peak construction activities.

### Business support

While the new Town Hall Station will be a significant boost for the local area, construction activities can impact local businesses.

In response to this, our Business Support Team assists businesses through the disruption and any permanent changes that will take place.

Please see the promotion in this notification for **Un Pezzo Di Milano** located at 272a La Trobe Street, Melbourne. We look forward to promoting more local businesses as the project progresses.

Construction partner:



# Works in your area

## City Square site

24-hours, Monday to Friday  
7am to 2pm, Saturdays

### Collins Street and Flinders Lane concrete pump operation

24-hours, Monday to Saturday (as required)



When Town Hall Station opens, the City Square station entrance will lead into an expansive underground passenger foyer, with lifts and escalators transporting passengers down to the customer and ticketing area, towards the train platforms.

Works being undertaken this month include:

- Construction of the passenger concourse which involves the use of the tower cranes, concrete pumps, and other tools and equipment to undertake steel fixing, waterproofing, formwork installation and concrete pours
- Installation of infrastructure to support mechanical, electrical and plumbing services
- Concrete trucks will access the loading bays on Collins Street and Flinders Lane. Concrete pours involve regular deliveries, the use of concrete trucks, concrete pumps and concrete finishing equipment
- Major concrete pours can take between 10-20 hours with all concrete pumps in use to achieve the volume of concrete required. Concrete pours must be continuous to ensure structural integrity and therefore may continue outside of normal construction hours
- Ventilation equipment operation will be required during all works below ground, and site lighting will be required for evening and overnight works
- There will be regular truck movements to deliver and remove equipment and construction materials via the Collins Street and Flinders Lane loading bays
- These works are expected to generate low to medium levels of noise
- Steel crypt branches will be installed via the Flinders Lane loading bay to support upcoming ground floor placements
- Escalators are being delivered via Collins Street to be installed on the central platform.

## Pre-cast panel deliveries from Flinders Lane loading bay

7am to 4pm for up to 2 days in November



- Pre-cast deliveries will be lifted off trucks by a mobile crane and then lifted into site by the tower crane
- During these lifts, Flinders Lane will be closed to traffic from 7am to 4pm between Russell Street and Swanston Street
- Driveway access will be maintained to properties on Flinders Lane between Russell Street and Regent Place, and vehicles exiting carparks on Flinders Lane will be required to travel east to Russell Street
- Traffic management and a detour using Flinders Street or Collins Street will be in place
- Access to properties on Flinders Lane between Swanston and Elizabeth streets will need to enter Flinders Lane via Elizabeth Street under a contraflow arrangement.

## Flinders Quarter site

24-hours, Monday to Friday  
7am to 10pm, Saturdays  
7am to 10pm, Sundays

### Flinders Street concrete pump operation

24-hours, Monday to Sunday (as required)



When Town Hall Station opens, the station entrance building located on Swanston and Flinders streets will lead into an expansive underground passenger foyer, with lifts and escalators transporting passengers down to the customer and ticketing area, towards the train platforms.

Works being undertaken this month include:

- Construction of the passenger concourse which involves the use of the tower crane, mobile surface cranes, concrete pumps, and other tools and equipment to undertake shotcreting, steel fixing, waterproofing, formwork installation and concrete pours including hydro scabbling
- Installation of infrastructure to support mechanical, electrical and plumbing services
- Concrete pours involve regular deliveries via the loading zone on Flinders Street, and the use of concrete trucks, concrete pumps and concrete finishing equipment
- Major concrete pours can take between 10-20 hours with all concrete pumps in use to achieve the volume of concrete required. Concrete pours must be continuous to ensure structural integrity and therefore may continue outside of normal construction hours. Every effort will be made to undertake concrete pours during standard construction hours to minimise disruption to surrounding properties
- Ventilation equipment operation will be required during all works below ground, and site lighting will be required for evening and overnight works
- There will be regular truck movements to deliver and remove equipment and construction materials via the Flinders Street loading zone and Swanston Street driveway. Due to road permit requirements, large plant will occasionally be delivered and demobilised from the site outside of standard construction hours
- These works are expected to generate low to medium levels of noise.

## Service investigations

### Cocker Alley, Scott Alley, Royston Place

8pm to 6am, Monday to Friday  
Late November to early December  
for up to 5 nights



- Works will take place to investigate services beneath Cocker Alley, Scott Alley and Royston Place
- Work will include the use of a non-destructive digging truck, demo saw and high pressure hose
- These works need to take place at to limit impact on businesses and will generate some periods of medium to high level noise
- Access to properties will be maintained under traffic management.

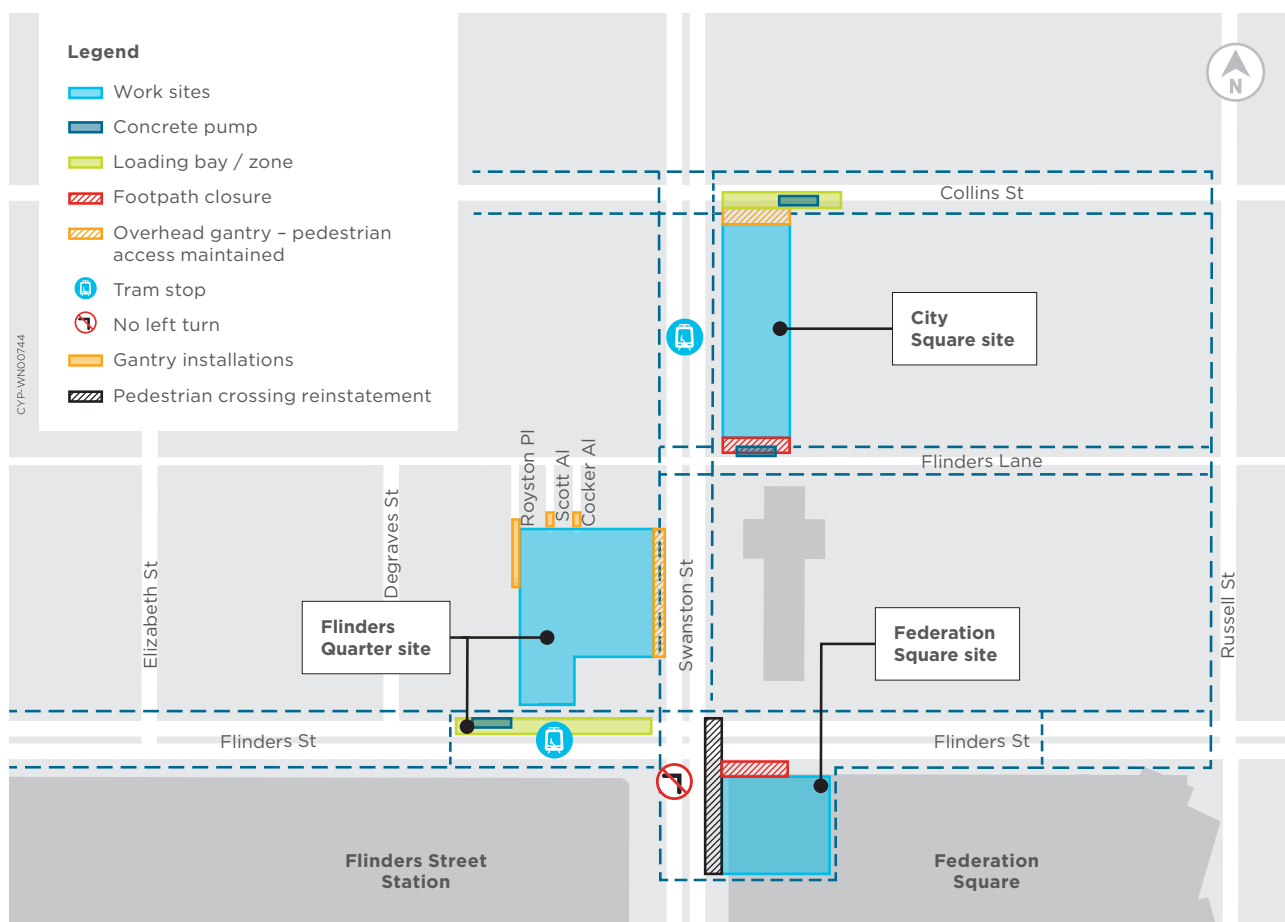

Indicative Only

## Royston Place, Scott Alley and Cocker Alley gantry installations

24-hours



- Overhead protection gantries will be installed to ensure the laneways are safe to access while above ground construction is underway
- These gantries will cover approximately five metres overhead from the site boundaries and will allow above ground construction at the site to take place whilst the laneways remain operational
- Once the protection gantries are installed, they will not impact on the operation or access to the laneways, or encroach on windows, doors or balconies of surrounding buildings
- Works will include the use of rattle guns, hand tools and the tower crane to erect steel to form the gantry
- These works will generate some periods of medium to high level noise. Every effort will be made to undertake noisier works during daytime hours.

## Underground passenger connection to Flinders Street Station

7am to 6pm, Monday to Friday  
7am to 1pm, Saturdays



- Works to restore Campbell Arcade and construct the future underground pedestrian connection between Town Hall Station and Flinders Street Station, known as the 'Flinders Link', are ongoing
- Works to install lifts between the Degraives Subway and platform level at Flinders Street Station will continue. These works will be carried out behind the blue hoarding on the Flinders Street Station platforms.

## Federation Square site

24-hours, Monday to Sunday



- Works continue in the acoustic shed to construct and fit-out the station passenger areas and operational rooms, including installation of waterproofing materials, steel, and concrete
- There will be regular truck movements to deliver and remove equipment and construction materials
- Works will take place to demolish the eastern driveway access into the Federation Square shed, the majority of work taking place within the site boundary however some work will take place outside the site
- Slab demolition works will include the use of a jackhammer and an excavator with a hammer attachment and are expected to generate some periods of high-level noise.

## Flinders Street pedestrian crossing reinstatement

10pm to 6am, Monday to Saturday



- We are reinstating the Flinders Street pedestrian crossing between Federation Square and St Paul's Cathedral
- Works will include asphaltting, road profiling, line marking and rephasing of lights at the intersection of Flinders Street and the Princes Bridge/Swanston Street
- These works will require some overnight lane closures during the rephasing of traffic lights.

## Flinders Street eastbound closure

The Flinders Street eastbound lane – between Elizabeth and Swanston streets – will remain closed until July 2024 so crews can continue undertaking critical work on Town Hall Station.

Keeping the eastbound traffic lane closed for longer allows trucks, construction materials and equipment to access the site more efficiently, and will help keep the community and road users safe while this critical work takes place.

We thank everyone for their patience while we progress closer to completing Town Hall Station.



*Concept image of Town Station's City Square entrance on the corner of Swanston and Collins streets.*

## New modern trains commence on the Sunbury Line

Melbourne's new bigger, better trains have started taking passengers on the Sunbury Line in preparation for the opening of the Metro Tunnel.

This follows months of testing to ensure the High Capacity Metro Trains (HCMTs) run safely and reliably on the Sunbury Line. The new trains will run on two morning peak services every weekday from Sunbury Station to Flinders Street Station.

A further 34 HCMTs will complete the Sunbury Line fleet when the Metro Tunnel opens in 2025.

To find out more about HCMTs, visit [metrotunnel.vic.gov.au](https://www.metrotunnel.vic.gov.au)

# About the Metro Tunnel

The Metro Tunnel will create a new end-to-end rail line from Sunbury in the west to Cranbourne and Pakenham in the south-east, with high capacity trains and five new underground stations at Arden, Parkville, State Library, Town Hall and Anzac.

It is the first step towards a metro-style rail network for Melbourne, with turn-up-and-go rail services that are the hallmark of the world's great cities.

The Metro Tunnel will transform Melbourne's train network, delivering more trains to and from the suburbs and slashing travel times by up to 50 minutes a day.

It will give Victorians rail access to Parkville's medical and education precinct and the St Kilda Road employment hub for the first time, and will include Melbourne's first tram/train interchange.

Opening in 2025, the Metro Tunnel will also pave the way for future expansion of Victoria's public transport network and help to maintain Melbourne's status as one of the world's most liveable cities.

To find out more about the Metro Tunnel, visit [metrotunnel.vic.gov.au](https://metrotunnel.vic.gov.au)

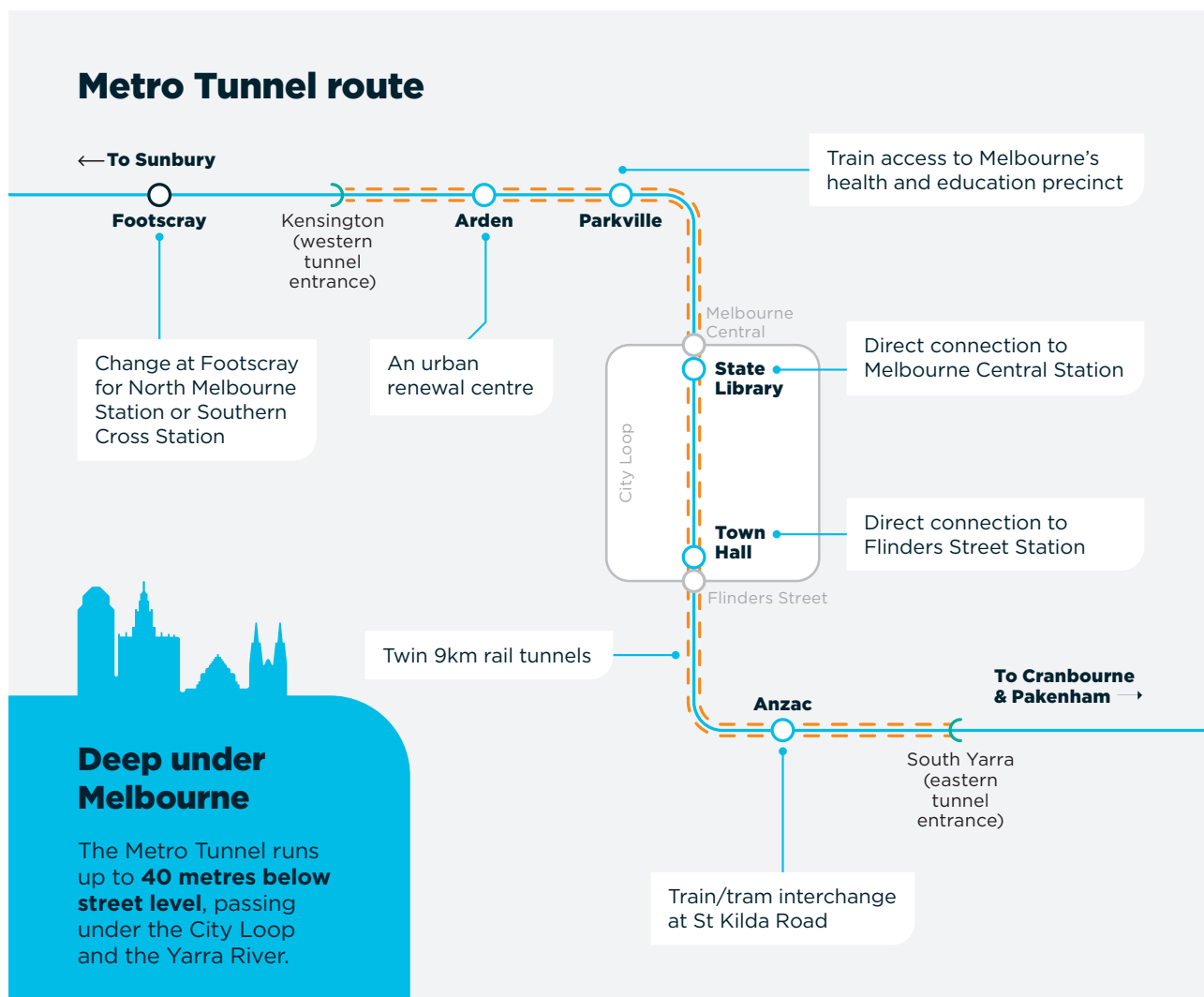

## More information

[metrotunnel.vic.gov.au](https://metrotunnel.vic.gov.au)

1800 105 105  
(24 hours a day, 7 days a week)

Rail Projects Victoria  
PO Box 2392, Melbourne, VIC 3001



Interpreter Service (03) 9209 0147

It should be noted that this information is current at the time of printing, however due to unforeseen circumstances, changes may occur. Please visit [railprojects.vic.gov.au](https://railprojects.vic.gov.au) for the latest updates.

# UN PEZZO DI MILANO

**MILAN-INSPIRED ITALIAN EATERY &  
PATISSERIE SERVING FRESHLY BAKED  
PIZZA, AROMATIC COFFEE AND A  
SELECTION OF DELICIOUS PASTRIES**



**UNPEZZODIMILANO.COM.AU @UNPEZZODIMILANO**  
272a La Trobe St, Melbourne VIC 3000

