

# Upcoming works

Box Hill North, Blackburn North,  
Doncaster, Doncaster East,  
Donvale & Nunawading

Works Notification

August / September 2025

**BIG BUILD**

**EASTERN FREEWAY**

We're upgrading the Eastern Freeway with new express lanes, new Eastern Busway, smart technology and a connection to North East Link – slashing travel times and improving travel in Melbourne's east.

## What we're doing

We're rolling out traffic barriers between Tram Road and Middleborough Road to safely separate work areas from motorists. We'll work at night to keep traffic moving freely during the day.

We're also continuing site investigations along the Eastern Freeway and in surrounding areas between Tram Road and Springvale Road to further inform our design, planning and construction staging.

## When are we working?

● **Day works** 7am to 6pm Monday to Friday and 7am to 1pm Saturdays

● **Night works** 7pm to 6am at times Monday to Friday

Schedule is subject to change.

Visit [bigbuild.vic.gov.au/roads](https://bigbuild.vic.gov.au/roads) for schedule changes.

## Keeping you up to date

We'll be out talking to nearby residents and businesses about these works in more detail, including how we'll manage any local impacts.

## Get in contact

If you have any questions, please contact the 24/7 Contact Centre on **1800 105 105** or to sign up to our email and SMS updates, visit [bigbuild.vic.gov.au/projects/roads/email-and-sms-update](https://bigbuild.vic.gov.au/projects/roads/email-and-sms-update)

## Traffic changes

From September 2025, speed limits on the freeway will reduce to 80km/h between Tram Road and Middleborough Road as we work safely behind barriers. The reduced speed limit will be extended to Springvale Road later this year and will be in place until works are complete in 2028.



Sign up for updates

[bigbuild.vic.gov.au/roads-subscribe](https://bigbuild.vic.gov.au/roads-subscribe)



Australian Government

BUILDING AUSTRALIA



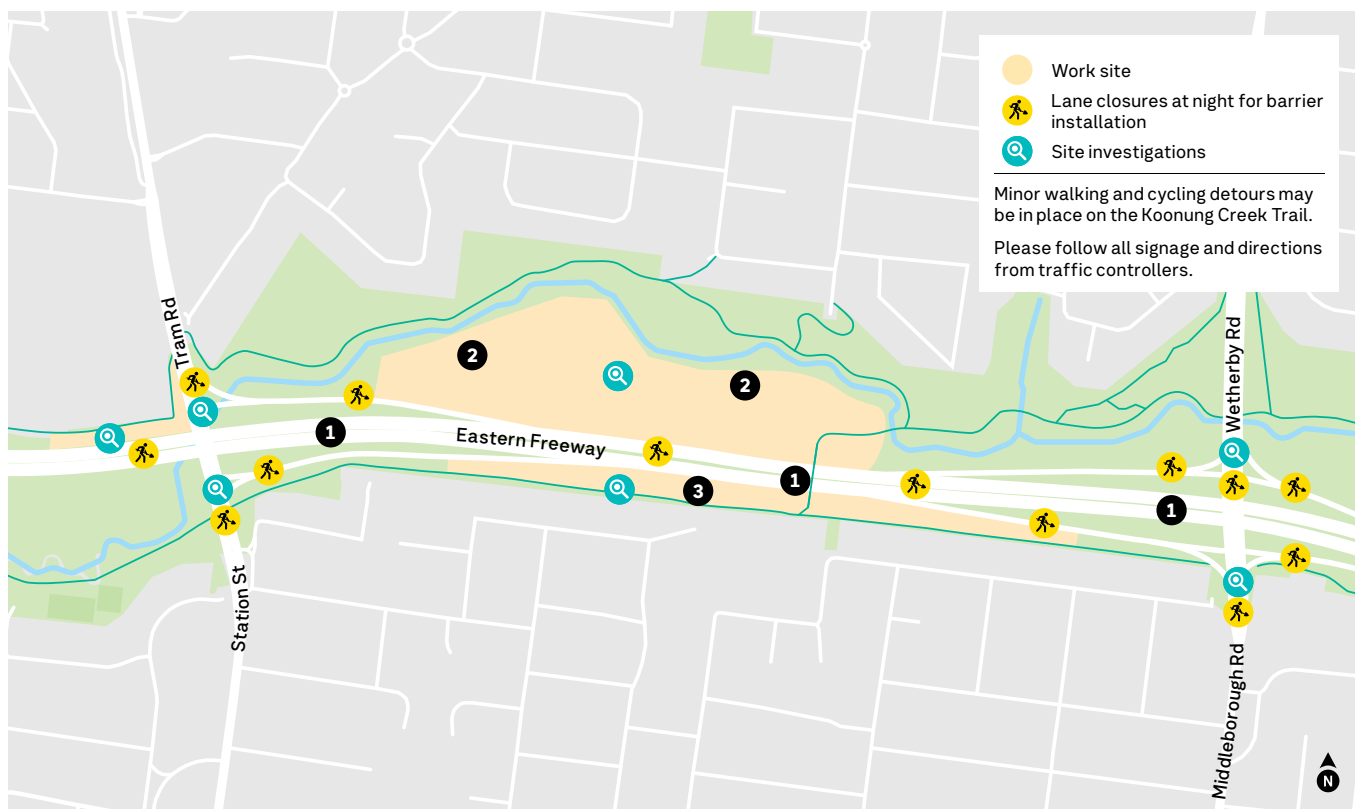

## Zone 1: Tram Road to Middleborough Road

### New and ongoing works

● Work site
 🔍 Site investigations
 🚶 Lane closures at night for barrier installation
 ● Day works
 ● Night works
 ● Day / night works

Where	Activity	What to expect
<b>1</b> Between Tram and Middleborough roads	<ul style="list-style-type: none"> <li>● Traffic barrier installation along freeway ramps and shoulders</li> <li>– Structural inspections and survey works</li> <li>– Removing guardrails and kerbs</li> <li>– Adjustments to line marking</li> <li>● Locating underground services using high-pressure hoses</li> <li>– Digging into the ground using construction machinery</li> </ul>	<ul style="list-style-type: none"> <li>– Overnight freeway lane and ramp closures</li> <li>– Overnight access changes to the freeway from Middleborough Road</li> <li>– Construction vehicles and equipment in the area</li> <li>– Low to medium levels of noise, dust and vibration</li> <li>– Use of directional lighting</li> </ul>
<b>2</b> Eram Park	<ul style="list-style-type: none"> <li>● Locating underground services using high-pressure hoses</li> <li>– Digging into the ground using construction machinery</li> <li>– Structural inspections and survey works</li> </ul>	<ul style="list-style-type: none"> <li>– Traffic controllers and signage to guide cyclists and pedestrians around our works</li> <li>– Construction vehicles and equipment in the area</li> <li>– Temporary access tracks for vehicles and equipment</li> <li>– Low levels of noise, dust and vibration</li> <li>– Use of directional lighting</li> </ul>
<b>3</b> Koonung Creek Trail	<ul style="list-style-type: none"> <li>● Locating underground services using high-pressure hoses</li> <li>– Digging into the ground using construction machinery</li> </ul>	<ul style="list-style-type: none"> <li>– Traffic controllers and signage to guide cyclists and pedestrians around our works</li> <li>– Construction vehicles and equipment in the area</li> <li>– Temporary access tracks for vehicles and equipment</li> <li>– Low levels of noise, dust and vibration</li> </ul>

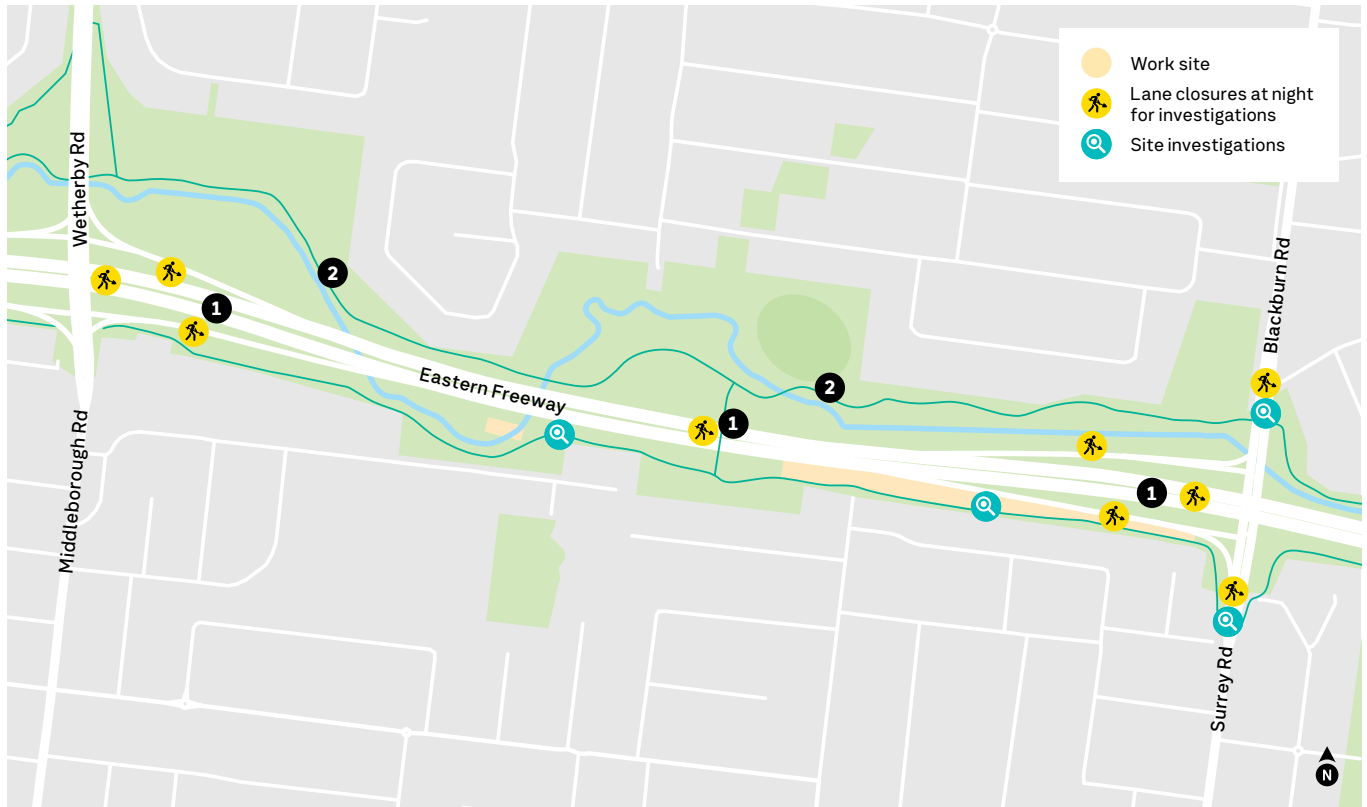

## Zone 2: Middleborough Road to Blackburn Road

### Ongoing / existing works

● Work site 
 🔍 Site investigations 
 🚶 Lane closures at night for site investigations 
 ● Day works 
 ● Night works 
 ● Day / night works

Where	Activity	What to expect
<b>1</b> Between Middleborough and Blackburn roads	<ul style="list-style-type: none"> <li>● Locating underground services using high-pressure hoses</li> <li>– Digging into the ground using construction machinery</li> <li><span style="color: orange;">●</span> Structural inspections and survey works</li> </ul>	<ul style="list-style-type: none"> <li>– Overnight freeway lane closures</li> <li>– Construction vehicles and equipment in the area</li> <li>– Low levels of noise, dust and vibration</li> <li>– Use of directional lighting</li> </ul>
<b>2</b> Koonung Creek Trail	<ul style="list-style-type: none"> <li><span style="color: orange;">●</span> Locating underground services using high-pressure hoses</li> <li>– Digging into the ground using construction machinery</li> </ul>	<ul style="list-style-type: none"> <li>– Vehicles crossing the Koonung Creek Trail</li> <li>– Construction vehicles and equipment in the area</li> <li>– Low to medium levels of noise, dust and vibration</li> <li>– Use of directional lighting</li> </ul>

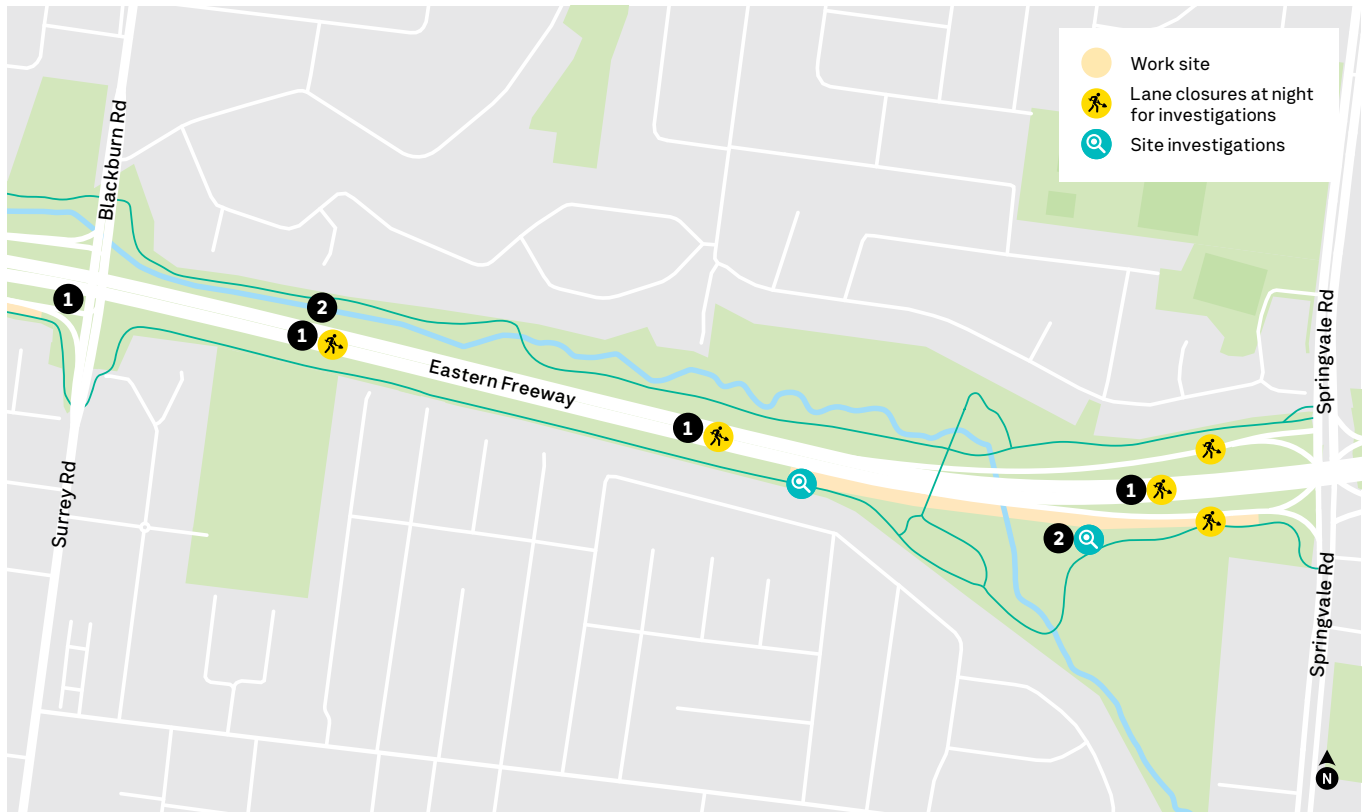

## Zone 3: Blackburn Road to Springvale Road

### Ongoing / existing works

● Work site
 🔍 Site investigations
 🚶 Lane closures at night for site investigations
 ● Day works
 ● Night works
 ● Day / night works

Where	Activity	What to expect
<b>1</b> Between Blackburn and Springvale roads	<ul style="list-style-type: none"> <li>● Locating underground services using high-pressure hoses</li> <li>– Digging into the ground using construction machinery</li> <li>● Structural inspections and survey works</li> </ul>	<ul style="list-style-type: none"> <li>– Construction vehicles and equipment in the area</li> <li>– Low to medium levels of noise, dust and vibration</li> <li>– Use of directional lighting</li> </ul>
<b>2</b> Koonung Creek Trail	<ul style="list-style-type: none"> <li>● Locating underground services using high-pressure hoses</li> <li>– Digging into the ground using construction machinery</li> </ul>	<ul style="list-style-type: none"> <li>– Vehicles crossing the Koonung Creek Trail</li> <li>– Construction vehicles and equipment in the area</li> <li>– Medium levels of noise, dust and vibration</li> <li>– Use of directional lighting</li> </ul>

Schedule is subject to change. Visit [bigbuild.vic.gov.au/roads](https://bigbuild.vic.gov.au/roads) for schedule changes.  
For more information call 1800 105 105.

**[bigbuild.vic.gov.au/roads](https://bigbuild.vic.gov.au/roads)**

[contact@bigbuild.vic.gov.au](mailto:contact@bigbuild.vic.gov.au)

**1800 105 105 (call anytime)**

Please contact us if you would like this information in an accessible format.

If you need assistance due to a hearing or speech impairment, please visit [relayservice.gov.au](https://relayservice.gov.au)



For languages other than English please call 9209 0147

如需获取英语以外的其它语言的协助, 请致电9209 0147。

Για γλώσσες εκτός της αγγλικής Καλέστε το 9209 0147

Per lingue diverse dall'inglese Chiamare il numero 9209 0147