

20 October 2021



Works Notification: Nightworks on Wurundjeri Way

Night road works will be undertaken on Wurundjeri Way in Docklands from 8 November until 17 December between 7:00 pm to 5:00 am to prepare for construction of the new bridge connection from Dynon Road.

The works, which will include excavating and compacting, will be completed at night behind safety barriers, with lane closures in place for the duration. Through traffic will be maintained throughout these periods.

What to expect

We don't expect noise from the works to be disruptive, but we will be monitoring the works to ensure acceptable noise levels over their duration.

| | Impact | Date |
|---|---|-------------------------------|
|  | Occasional nightwork noise. <i>We don't expect noise to be disruptive.</i> | 8 November – 17 December 2021 |
|  | Occasional nightwork lighting. <i>Lighting will be angled away from residences wherever possible during nightworks.</i> | 8 November – 17 December 2021 |
|  | Nightly lane closures around the worksite. <i>Traffic management will be in place to guide vehicles safely around the work site.</i> | 8 November – 17 December 2021 |

When the works will happen

These works will be conducted nightly, from 7:00pm to 5:00am, from Monday 8 November until Friday 17 December 2021.

If the weather is poor, or there are any unexpected events, we may need to reschedule the works.

Thank you

We appreciate our work can be disruptive and thank you for your understanding.

For updates or questions, please call 1800 105 105, email us at info@wgta.vic.gov.au or visit westgatetunnelproject.vic.gov.au

Nightly lane closures around the work site

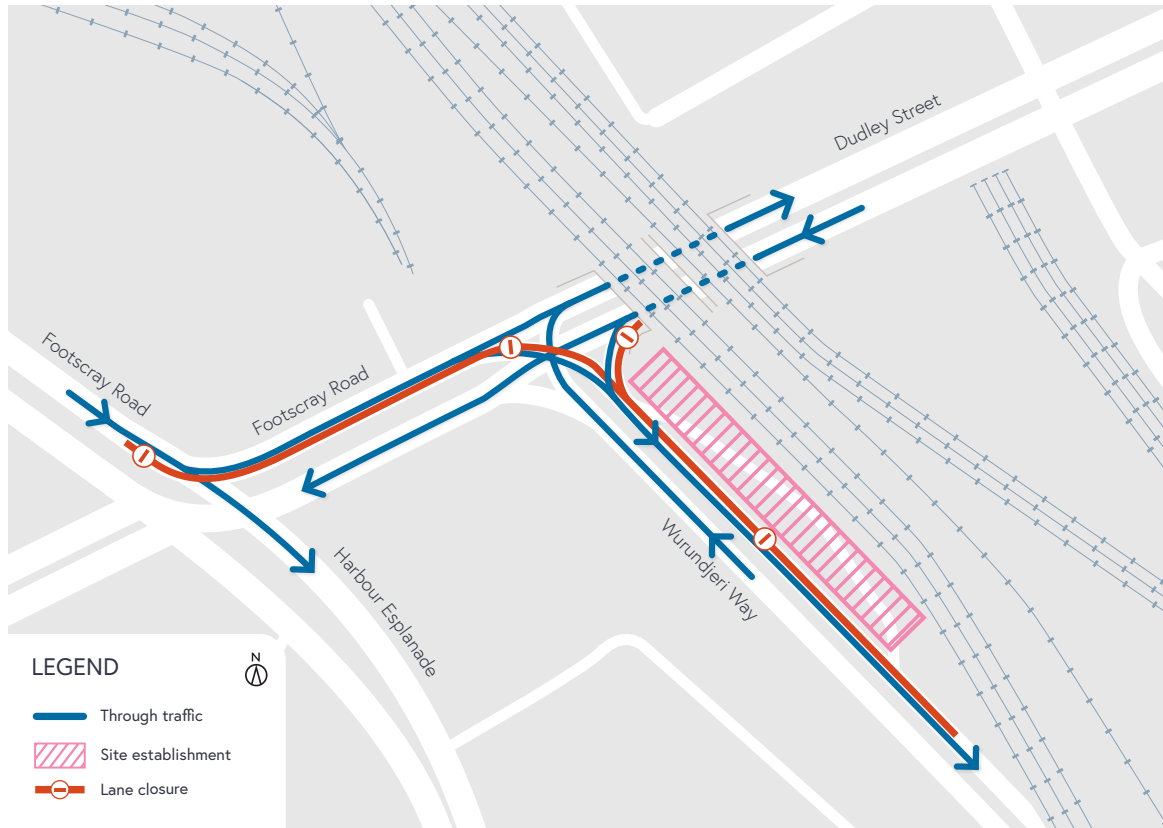

LEARN MORE

To learn more about the impacts above, or any of the construction activities mentioned above, please don't hesitate to give the team a call on **1800 105 105** or email us on info@wgta.vic.gov.au.

westgatetunnelproject.vic.gov.au
info@wgta.vic.gov.au
 1800 105 105

West Gate Tunnel Project Info Centre
 Corner of Somerville Rd and Whitehall St
 Yarraville VIC 3013

Follow us on social media

Please contact us if you would like this information in an accessible format.

Translation service – For languages other than English, please call 13 14 50.

In partnership with:

