

Works notification

Reminder: Queensberry Street closure

Queensberry Street westbound lane,
between Laurens Street and Munster Terrace

From Monday 14 February until Monday 14 March

As part of works for the future Arden Station in North Melbourne, a water main line that runs up Queensberry Street needs to be upgraded. These works will require a westbound closure of Queensberry Street for one month.

What we are doing

- Closing the westbound lane of Queensberry Street between Munster Terrace and Laurens Street
- Closing the on-street car parking spaces on the westbound side of Queensberry Street, and three parking spaces in the Queensberry Street median
- Using excavators, non-destructive digging trucks, and road saws to cut and excavate the road surface to the water main line
- Upgrading the water main line and reconnecting it to existing mains.

What you should be aware of

- For the duration of these works, Queensberry Street westbound between Munster Terrace and Laurens Street will be closed. Both the traffic and bike lane will be closed during these works
- In addition to this closure, northbound egress from Munster Terrace onto and across Queensberry Street will be closed. A local detour via Dryburgh Street will be in place
- Local pedestrian and driveway access for businesses on the southern side of Queensberry Street will be maintained

- The southern footpath of Queensberry Street may be closed at times during the works, with the pedestrian access via the northern side of Queensberry Street
- The use of road saws, non-destructive digging trucks and excavators will generate periods of high level noise
- Once the work is complete, the road surface will be reinstated and Queensberry Street reopened to traffic.

Water supply

- During the works, some properties will be switched to a temporary water supply. Greater Western Water will advise properties directly of the process to switch to a temporary supply
- Customers who are on dialysis, life support or who have other special needs, please register as a Special Needs Customer by calling 13 44 99 so Greater Western Water can put in place measures to assist you
- If you wish to report a fault or emergency relating to your water supply, you can call Greater Western Water on 13 44 99 (24/7)
- For any other queries related to the works, please contact the project team via the details overleaf
- Affected properties will be connected to the new water main as soon as the work is completed.

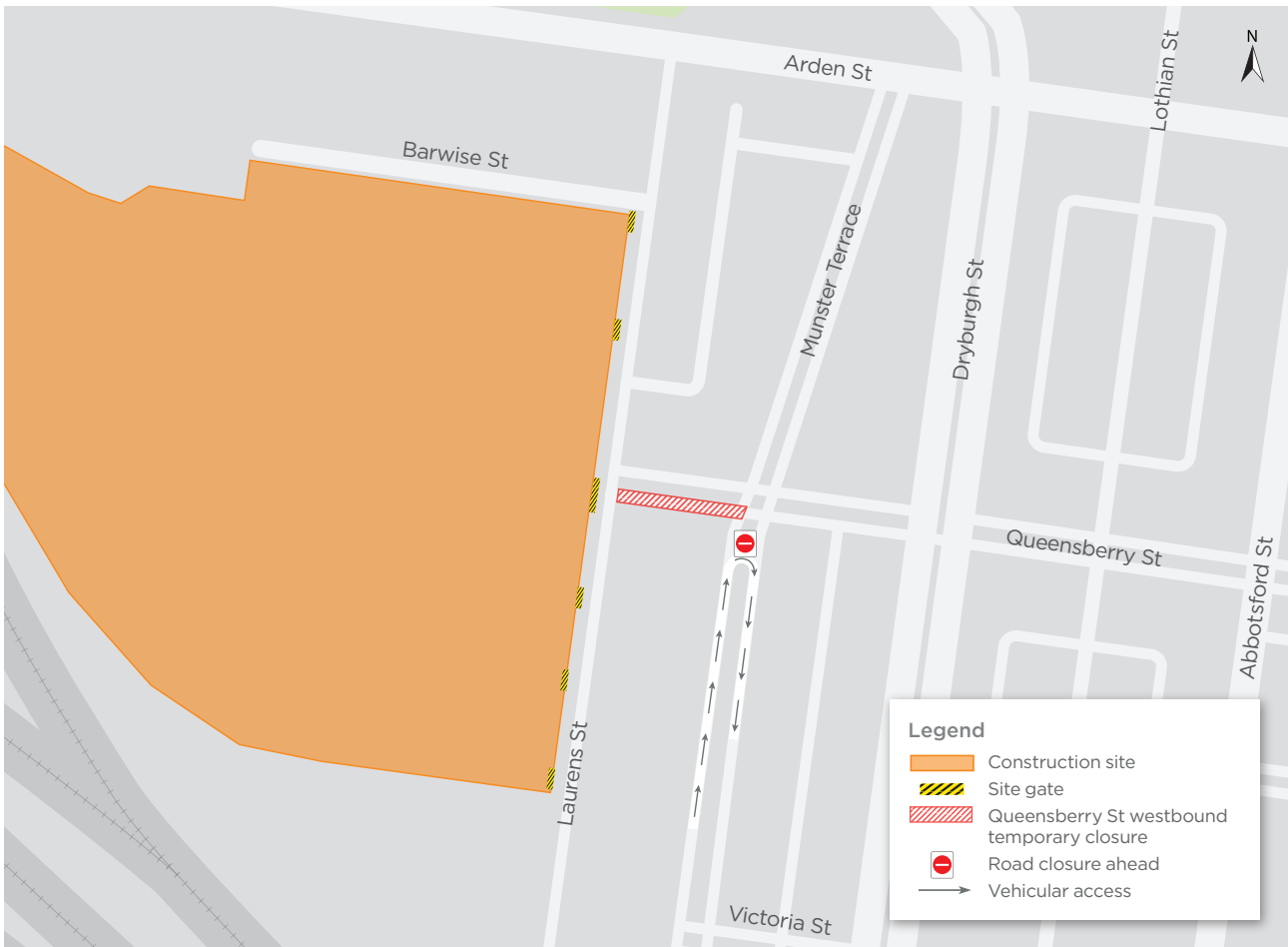

Indicative only

When

Water main upgrade works

7am to 6pm Monday to Fridays,
and 7am to 5pm Saturdays

Queensberry Street westbound lane closure

from 7am Monday 14 February
until Monday 14 March

Local detours will be in place for these four weeks.

Health and safety

Works on the Metro Tunnel project are being carried out with COVIDSafe Plans in place to help protect workers and the community.

For more information and advice about the coronavirus (COVID-19), please visit <http://coronavirus.vic.gov.au>.

More information

To find out more about the Metro Tunnel Project:

 metrotunnel.vic.gov.au

 1800 105 105 (24 hours a day, 7 days a week)

Rail Projects Victoria
PO Box 4509, Melbourne, VIC 3001



Interpreter Service (03) 9209 0147

It should be noted that this information is current at the time of printing, however due to unforeseen circumstances, changes may occur. Please visit railprojects.vic.gov.au for the latest updates.