

Public artworks at the stations

A curator and arts manager, Gippsland born-and-bred artist **Melanie Caple** has created public artworks for Bunyip and Longwarry stations as part of the Gippsland Line Upgrade.

The aluminium sheeting clads the balustrades for accessible pedestrian ramps and stair entrances to the new platforms at each station.

Melanie was selected following a "Expression of Interest" process seeking local artists. Her original, vibrant, contemporary designs reflecting the character of the local area were chosen by our Creative Design Panel.

The theme for the artworks of local flora and fauna was selected by the local community through consultation.

Melanie's designs feature the surrounding town, heritage and community elements in her designs.

Melanie developed unique artworks for each upgraded station, imprinted on to custom-

designed, perforated aluminium sheeting – also known as *pic perf*.

These artworks are part of the Regional Rail Revival Creative Strategy which supports working with regional artists and cultural organisations, engaging local communities, and celebrating the creative culture of Victoria's First Peoples.



Bunyip Station artwork



Artist Melanie Caple

Providing employment and learning opportunities

The Gippsland Line Upgrade is delivering opportunities for young locals, with the project exceeding its commitments under the Victorian Government's Major Project Skills Guarantee.

More than 63,000 hours had been worked by apprentices, trainees and cadets on the project to date, representing more than 13% of the total hours worked on the project.

This is almost 6500 hours in excess of the project's 11.71% target, which is itself greater than the minimum requirement of 10% of the total hours worked on the project.

The project has spent approximately \$13 million with Victorian Aboriginal businesses, with more than 25 different Aboriginal businesses engaged on the project, and is significantly exceeding its targets for Aboriginal employment, as well as priority job seekers.



Bunyip upgraded northern car park

Tell us what you think

Thank you for your patience while we completed these major works.

Take our survey

to have your say

To assist the project team with future rail improvements, we would appreciate your feedback on our management of communications and community engagement, to support construction activities and help minimise impacts on frontline residents.



Complete our online survey at regionalrailrevival.vic.gov.au/feedback

The survey will be open from **Monday 19 August until 5pm Friday 6 September 2024.**

regionalrailrevival.vic.gov.au 1800 105 105 (call anytime)
regionalrailrevival@railprojects.vic.gov.au

 For languages other than English please call (03) 9209 0147

Please contact us if you would like this information in an accessible format. If you need assistance due to a hearing or speech impairment, visit relayservice.gov.au



Bunyip Station

Community update



Bunyip and Longwarry
Winter 2024

Thank you for having us

Trains are operating from the new second platforms at Bunyip and Longwarry stations.

New infrastructure between Pakenham and Drouin delivered as part of the Gippsland Line Upgrade was completed while coaches replaced trains during May and early June.

The new second platforms at Bunyip and Longwarry improve journeys for passengers and provide V/Line with more operational flexibility, boosting reliability.

Whilst trains weren't running on the line, more than 575 people worked a total of 85,000 hours carrying out complex signalling work, safety testing and driver training.

At Bunyip, the duplicated track was installed at the station and the pedestrian crossing was relocated to better connect the town's north and south. 30 new car parking spaces also opened to station users.

In Longwarry, the second track was installed along with new signal masts and boom gates at the Kennedy Street level crossing. Upgrades to the pedestrian crossing and footpaths were also completed.

We thank passengers, residents, and the wider community for your patience while these important works took place.



Longwarry pedestrian connections

 Sign up for updates
regionalrailrevival.vic.gov.au/subscribe

VICTORIA'S BIG BUILD

Station upgrades

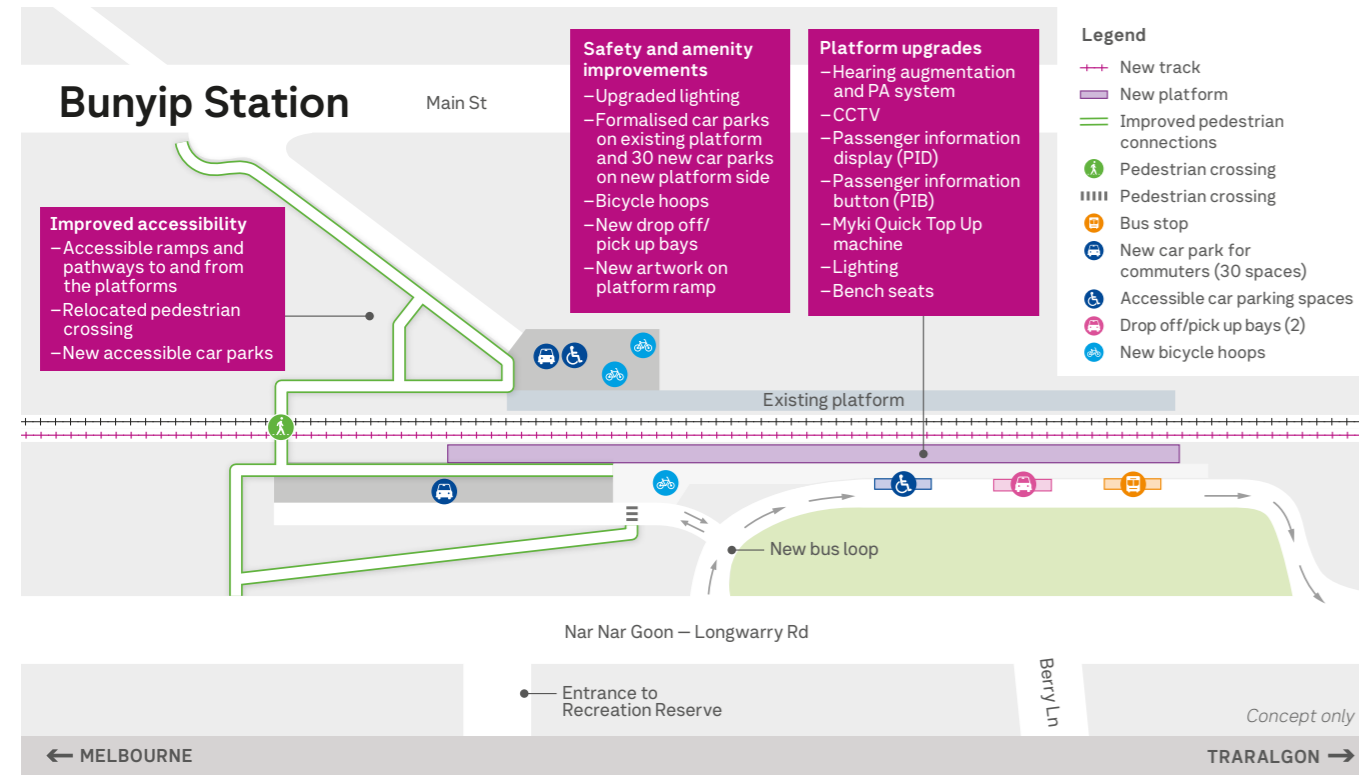

Easier access to station platforms and facilities

The upgraded stations have been designed to make it safer and easier to access the platforms, with the Bunyip and Longwarry precincts now accessible for people of all abilities. Each station features well-lit formalised carparks, accessible paths, handrails and seating.

Safer pedestrian connections

At Bunyip, we have relocated the pedestrian crossing to the western end of the platforms to better connect the town's north and south. In Longwarry an upgraded, accessible pedestrian crossing and path have been installed.

Safer, more accessible car parking

At Bunyip, we have delivered 30 new car parking spaces as part of the Victorian Government's Car Parks for Commuters program, and asphalted the car park on the north side. In Longwarry a 15-space asphalted car park, which includes two accessible car parking spaces has been delivered.

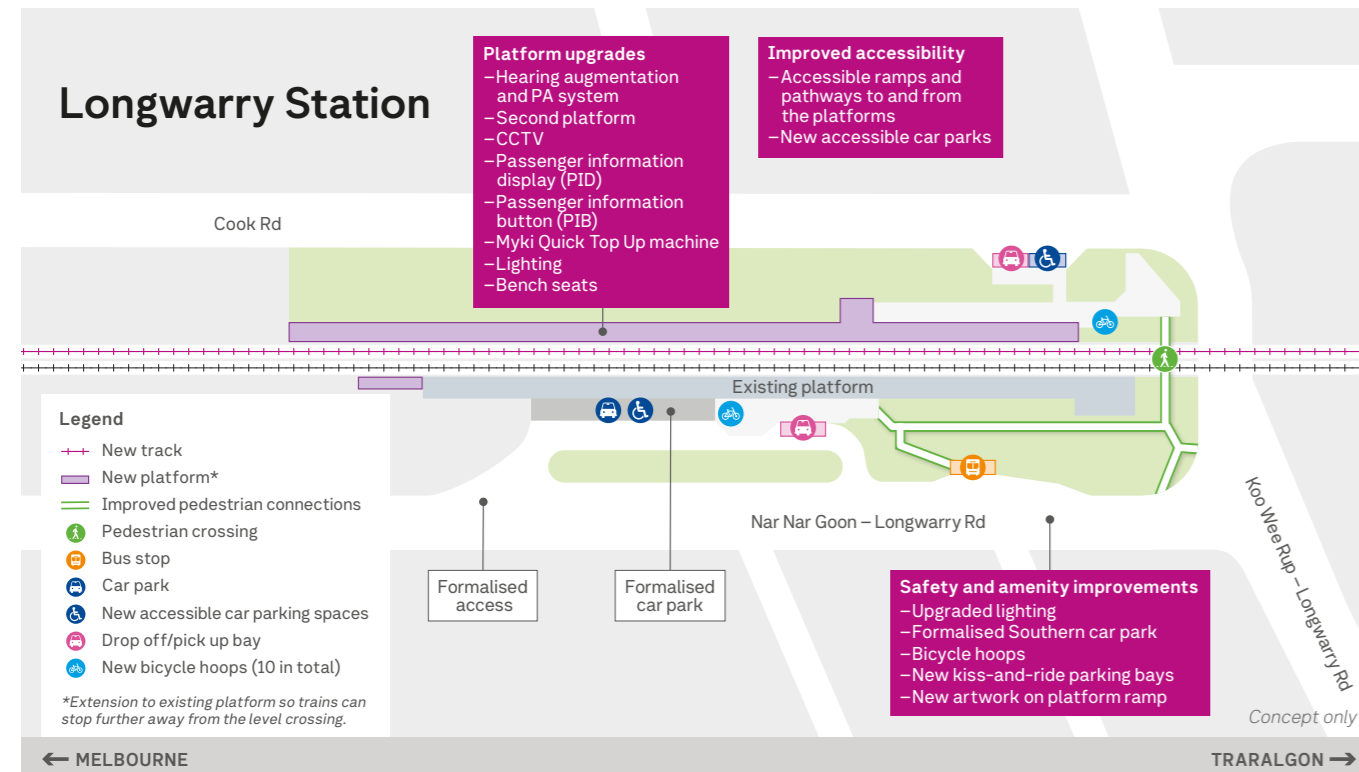

Cheers to you, Gippsland!

We are grateful to the communities of Bunyip and Longwarry for your support as we upgrade the Gippsland Line. The project team has worked with local businesses, community groups, schools and early learning centres to keep them informed and provide support.

We have contributed to the community via donations to community organisations and business support and initiatives, in the form of materials, school engagement activities, local competitions, vouchers, rail safety education and emergency service donations. A big thank you on behalf of the Gippsland Line Upgrade for involving us in your community and schools.



Community groups and schools:

- Bunyip Junior Football Club
- Bunyip CFA
- Bunyip Recreation Reserve
- Bunyip Community Market
- Sparrow Early Learning Centre
- Birches Early Learning Centre
- Bunyip Kindergarten
- Bunyip Primary School
- Columba Catholic Primary School
- Longwarry CFA
- ILO Longwarry Early Learning Centre
- Longwarry Kindergarten
- Longwarry Primary School

Environment and sustainability

On the Gippsland Line Upgrade we take pride in minimising the impact of our important works on the environment while contributing to sustainability. With efficient segregation of plastics, timber, metals, concrete and cardboard onsite we've successfully diverted over 95 per cent of waste produced by weight from landfill.

Planting and vegetation

A total of 18,928 shrubs and grasses, along with 52 trees have been planted as part of the landscaping in the Bunyip and Longwarry station precincts.

Protecting Southern brown bandicoots

The Gippsland Line Upgrade team worked closely with students at Bunyip Primary School and Koo Wee Rup Secondary College to help protect the endangered Southern Brown Bandicoots.

The project team tasked Koo Wee Rup Year 10 students with building nesting boxes for the Southern Brown Bandicoot and challenged the Bunyip preps to paint the boxes to make them feel more like home.

The boxes have been installed along the Gippsland Line between Nar Nar Goon and Longwarry.

