

Combined services
route works in Newport.

Construction works update

Major construction is kicking off to remove the dangerous level crossings at Maddox Road and Champion Road, Newport.

In the coming months, large machinery will continue to arrive on site, including piling rigs to work on the new passenger rail bridges that will replace the Maddox Road boom gates. The rail bridges will start to rise near Blenheim Road and return to ground near Challis Street.

At Champion Road, we'll start building a new pedestrian and cycling bridge over the rail line soon. This new bridge will keep the community connected and make it safer and easier for people to walk and ride in the area.

Excavators will get to work clearing and moving large amounts of dirt and rock to extend Akuna Drive, linking

Maddox Road and Champion Road. This new link road will open before the level crossing at Champion Road is closed, ensuring the community can continue to move safely through the area.

Thank you for your patience as we deliver these important safety upgrades in Newport.



Why these level crossings need to go



Up to 48 trains pass through the level crossings during the morning peak



Boom gates down for around 50 minutes of the morning peak



When the Metro Tunnel opens this year, there will be two additional trains per hour in the mornings and afternoons, resulting in more boom gate down time



Improved safety for drivers, bike riders and pedestrians



Did you know?

We've removed 86 level crossings across metropolitan Melbourne. This has resulted in:

- 80% drop in the number of train and driver collisions and near misses since 2018
- 55 hours of boom gate down time saved every weekday morning



Sign up for updates
levelcrossings.vic.gov.au

**VICTORIA'S
BIG BUILD**

Changes to the way you travel

There will be changes to the way you travel around Newport in the coming months.



Roads

- At times throughout July there will be traffic changes on Maddox Road and Kororoit Creek Road. We'll keep you informed via on-road signage and detour information.



Rail

- Throughout 2025, Metro Trains Melbourne will be testing new trains, which will result in buses replacing trains on sections of the Werribee Line.
- Plan your journey at ptv.vic.gov.au/disruptions or the PTV app. Please allow extra time for your travel.



Sign up for SMS updates for the latest information by texting **NEWPORT** to **0429 839 892** or find out more by visiting levelcrossings.vic.gov.au/newport-disruptions



Overhead shot of track inspection works in Newport.

Upgrading the local road network

To support the redistribution of traffic from Champion Road, we're upgrading the intersection at Maddox Road and Kororoit Creek Road.

Improvements include:

- extending the dedicated right turn lane
- adjusting traffic signals, allowing more drivers through the intersection and onto Maddox Road and Kororoit Creek Road
- installing a dedicated U-turn at this intersection, allowing more drivers to access businesses without blocking the intersection.

We're also working with the Department of Transport and Planning to optimise traffic signalling for the nearby pedestrian crossing at Adeline Street to further improve traffic movement along Kororoit Creek Road.

Upgrading the Maddox Road and Kororoit Creek Road intersection

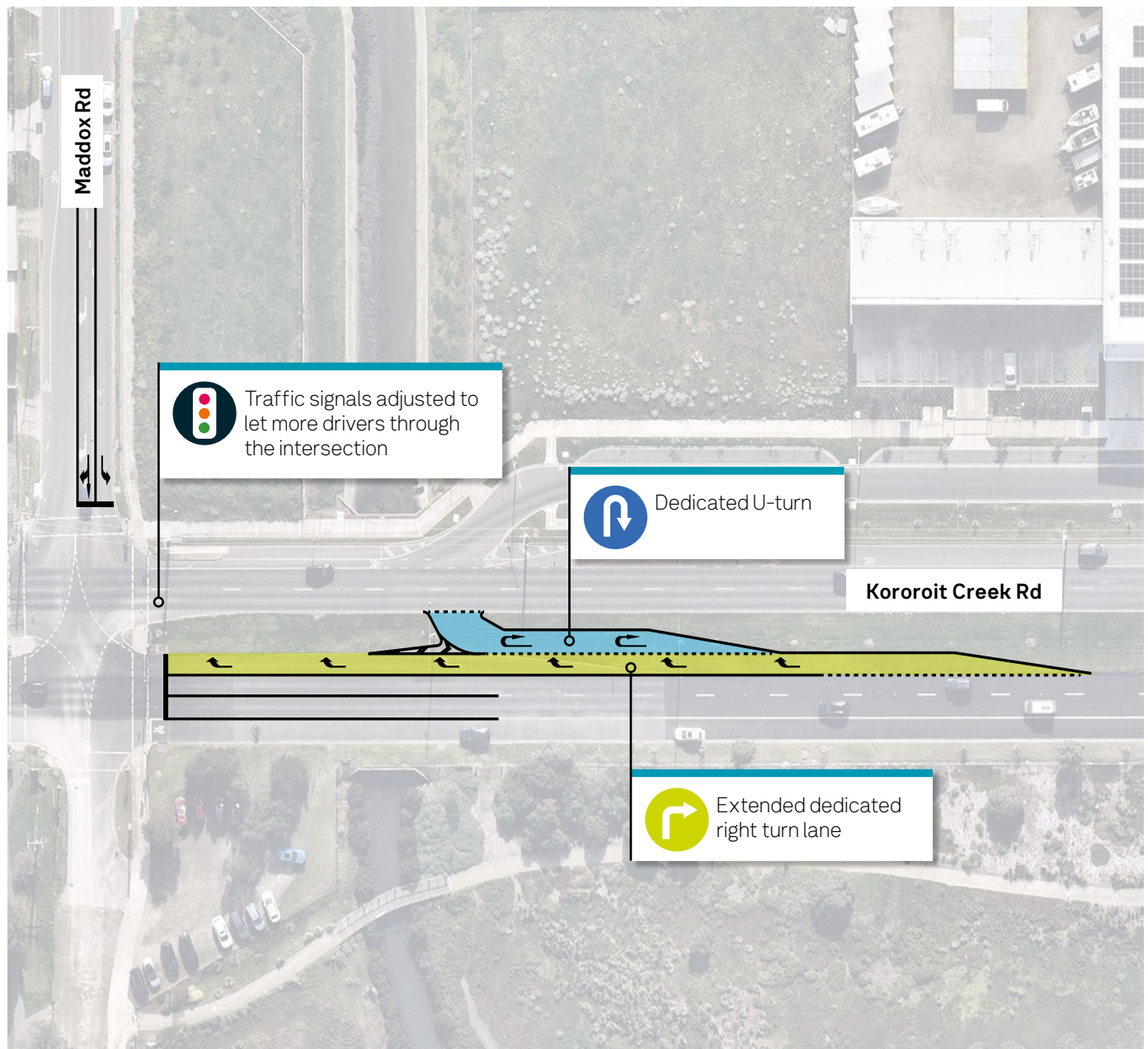

What we are doing

As major construction ramps up in Newport, you'll notice more construction equipment on site and a growing workforce as we deliver this significant safety upgrade.

The increased activity marks a key step forward in making Maddox Road and Champion Road boom gate free for good.

Building bridges

Piling works will begin in July to create solid foundations for the new passenger rail bridges over Maddox Road and the pedestrian and cycling bridge over the rail line at Champion Road.

Two 133 tonne piling rigs, each about the weight of twenty elephants, will be working on site. One rig will drill 16 holes, nine to 17 metres deep, to anchor the passenger rail bridges at Maddox Road, while the second rig will drill four holes, roughly eight metres deep, for the pedestrian and cycling bridge at Champion Road. Steel reinforcement cages will be lowered into the drilled holes and filled with concrete, creating deep foundations to support each new bridge.

Passenger trains are expected to run on the new rail bridges by mid 2026. The pedestrian and cycling bridge will open before the Champion Road level crossing closes next year.

Construction of the rail bridge for freight trains will start in mid 2026. When this is complete, Maddox Road will be level crossing free.

Linking Maddox Road to Champion Road

To keep locals moving, we're extending Akuna Drive to link Maddox Road to Champion Road. The new Akuna link road will open before we close Champion Road at the level crossing in 2026.

Crews will relocate power and water services to make way for excavators and bulldozers that will safely start leveling the ground, to create a strong, even base for the new road.

Graders and rollers will then be used to add layers of crushed rock before the asphalt is placed to create the final road surface.

The new link road will be ready for drivers to use in 2026.



Did you know?

Once we've removed the level crossings in Newport, we'll plant 145 mature trees and up to 30,000 large plants, shrubs and grasses. This will increase the tree canopy and contribute to greening the local area.



Combined services route works in Newport.



Ballast removal in Newport.



Stay up to date

While we undertake these critical works there will be temporary road and pedestrian crossing closures.

Detours will be in place to help you get around. There will also be traffic management in place near the work sites.

Scan the QR code to view up-to-date disruptions: levelcrossings.vic.gov.au/newport-disruptions



Or sign up for SMS updates by texting **NEWPORT** to **0429 839 892**

When you subscribe for SMS updates in June and July, you will also go into the running to **win 1 of 2 \$100 vouchers** to spend at a local trader. For full terms and conditions, visit: levelcrossings.vic.gov.au/terms-and-conditions

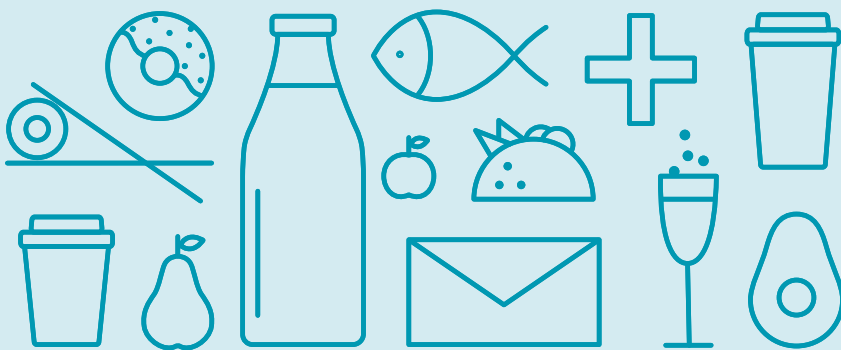

Works are on, traders are open

It's important to support local traders, and that's why we encourage the community and our workforce to shop locally as much as possible.





Nikki Eyes - Owner.

Come celebrate with Little Ginger

Little Ginger is a custom-built event venue, perfect for weddings, private functions, and corporate events.

Located in Williamstown North, Little Ginger is a modern-industrial event space that can be transformed to celebrate any occasion.

Founded by local Nikki Eyes, Little Ginger has been bringing people together since 2016 for everything from birthdays and baby showers to weddings and business workshops. With a background in branding and hospitality Nikki uses her expertise to offer stylish and stress-free ways to celebrate life's moments.

From curated in-house food and beverage packages to flexible DIY options that allow external catering and styling, Nikki's goal is to give her clients the freedom to create events that feel uniquely theirs. **Little Ginger is the go-to place for celebrations that feel personal, stylish and effortless.**

Call Nikki and her team to create your next unforgettable event on **03 9942 9585**. You can explore Little Ginger's food and beverage packages by visiting **littleginger.com.au** or you can also find her on socials **@littlegingerco**

Project timeline



* Timeline subject to change.

Stay in touch

Email updates

SMS alerts

levelcrossings.vic.gov.au/subscribe

Text **NEWPORT** to **0429 839 892**

levelcrossings.vic.gov.au

contact@levelcrossings.vic.gov.au



For languages other than English, please call 9209 0147.

1800 105 105 (call anytime)

Please contact us if you would like this information in an accessible format. If you need assistance due to a hearing or speech impairment, visit **relayservice.gov.au**

