



**LEVEL  
CROSSING  
REMOVAL  
PROJECT**

# LEVEL CROSSING REMOVAL UPDATE

GLENROY ROAD  
GLENROY  
MAY 2020

## Removing the Glenroy Road level crossing

We're getting rid of the dangerous and congested level crossing at Glenroy Road by lowering the rail line under the road, as well as building a new Glenroy Station.

**We want your feedback as the design to remove the level crossing begins to take shape.**

We've been working to develop a design that not only eases congestion and improves safety, but also reflects the character of Glenroy and creates a space that locals can call their own.

### Leave your feedback online

To help achieve the best outcome for Glenroy, we want your feedback on some key aspects of the station precinct design. While there are some site constraints that will influence parts of the design, we want to know what you want to see in the new station precinct.

Visit us online at [bigbuild.engage.vic.gov.au/lxrp-glenroy](https://bigbuild.engage.vic.gov.au/lxrp-glenroy) to learn more and provide your feedback until **Monday 18 May**.



*The existing road layout in Glenroy is one constraint of the project*



**SIGN UP FOR PROJECT UPDATES**  
[levelcrossings.vic.gov.au](https://levelcrossings.vic.gov.au)

Authorised and published by the Victorian Government, 1 Treasury Place, Melbourne





# STATION PRECINCT DESIGN

In 2019 you told us what's important to you when you move around the station precinct and surrounding areas.

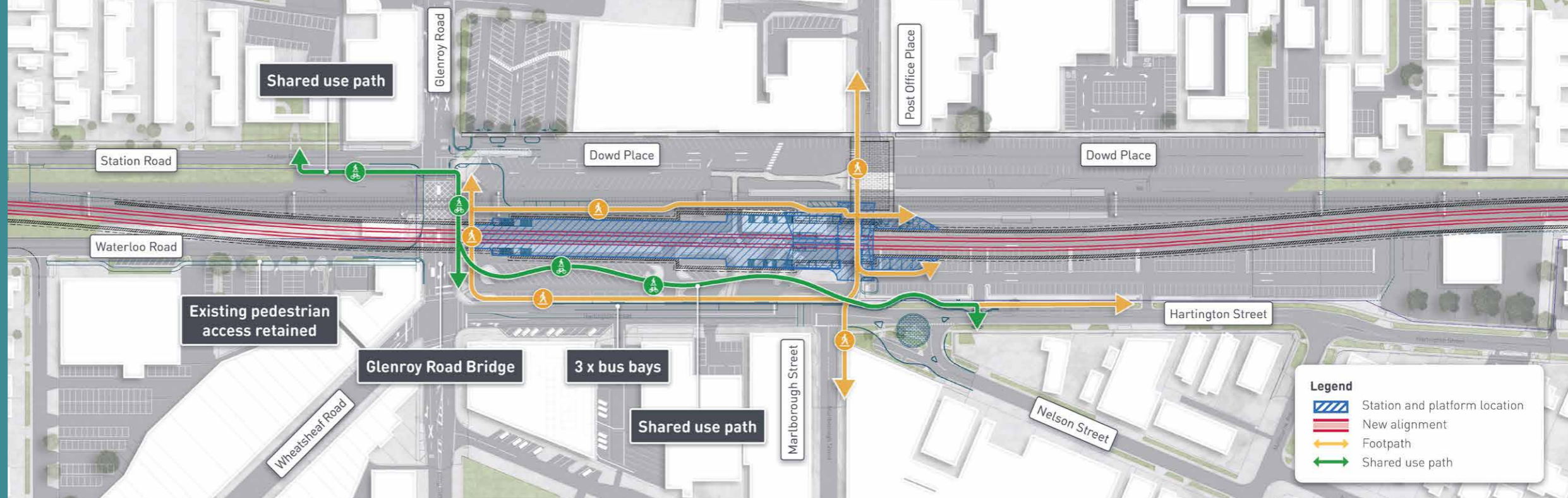

Artist impression only - subject to change.

We've taken your feedback on board and included some changes to the precinct design including:

- shifting the rail alignment east to allow trains to run on the existing tracks during the majority of construction
- moving the station to allow better east-west connectivity between Post Office Place and Hartington Street
- a new linear bus interchange on Hartington Street to improve safety and visibility between bus drivers and pedestrians
- introducing separated pedestrian and shared use paths to improve connectivity for pedestrians and cyclists
- closing southbound access to Waterloo Road, removing congestion caused by vehicles attempting to turn right from Glenroy Road.

## Thanks for your feedback

We had 175 people complete our survey. As well as letting us know you're looking forward to life without the level crossing, your feedback helped highlight some important aspects about the local area.

- Traffic flow
- Pedestrian and cycling connections
- Parking
- Safety
- The Glenroy Station precinct

This feedback has been invaluable to help us better understand the community and what you value about the local area.

## Working with local traders

We're committed to working with local traders during works to remove the level crossing.

Community feedback from late last year highlighted the value of having Glenroy Station located in the centre of the vibrant shopping precinct. While removing the level crossing will ease congestion, we understand our works may impact local traders during construction.

We will work closely with local traders to implement a range of campaigns encouraging people to support local businesses during construction.

On other level crossing removal projects, we've used a range of trader support strategies including:

- social media competitions with prizes sourced from local traders
- seasonal promotional activities such as Easter egg hunts and festivals featuring local traders
- trader profiles in our community newsletters
- trader directories featuring discounts and promotional offers
- partnering with local traders to supply goods and services for our project team.



Local traders in Glenroy

Contact us for more information on how you can get involved or how we can work with your business during the project.

## Planning approvals

LXRP is seeking community feedback on a range of planning matters, including:

- construction-related impacts
- environmental impacts
- amenity impacts
- native vegetation
- heritage.

Planning approval for this project will proceed under Clause 52.03 – Level Crossing Removal Project of the Moreland and Hume planning schemes. This clause facilitates the use and development of the project land without the need to obtain multiple planning permits.

The formal consultation period is now open. In addition to the matters listed above, we welcome submissions relating to any aspect of the project.

All feedback received will be included in a public consultation summary report. This report will inform the Minister for Planning's assessment of the project under Clause 52.03.

Planning submissions can be made online at [bigbuild.engage.vic.gov.au/lxrp-glenroy](http://bigbuild.engage.vic.gov.au/lxrp-glenroy) by 5pm Monday 18 May. If you would like a hard copy submission form sent to you, please contact us on 1800 105 105 or email us at [contact@levelcrossings.vic.gov.au](mailto:contact@levelcrossings.vic.gov.au)



Community feedback will help shape the design

## Site Investigations

To further refine the technical aspects of the rail under road design, the project team needs to undertake some further investigations in the area.

This work will include locating utility services as well as testing water and ground conditions. You may notice some machinery and workers in the area while this is happening.

You can keep up to date on any upcoming works via our disruptions page [levelcrossings.vic.gov.au/disruptions](http://levelcrossings.vic.gov.au/disruptions) and we'll be notifying nearby residents and businesses ahead of any works.





# COVID-19 update

Due to the current COVID-19 outbreak, we've had to change the way in which we'd normally consult with the community.

While we cannot conduct our usual community drop-in sessions, there are still a number of ways you can engage with us on the project. Visit our online engagement hub at [bigbuild.engage.vic.gov.au/lxrp-glenroy](http://bigbuild.engage.vic.gov.au/lxrp-glenroy) to find out more.

Work on the project is continuing and we are closely monitoring the health of our workforce. We have strict health and safety protocols across all level crossing removal sites including social distancing and we are committed to helping to slow the spread of coronavirus and will continue to implement guidelines provided by the Department of Health and Human Services.

# Next steps

The feedback from our next round of consultation will help us refine aspects of the project, including the look and feel of the station precinct.

Along with our technical investigations, we'll use your feedback to further progress the design for the project.

We'll be coming back out to the community before major works begin to share concept designs and show you how your feedback has been incorporated.

The best way to stay up to date on the project and any developments is by signing up to email updates at [levelcrossings.vic.gov.au/subscribe](http://levelcrossings.vic.gov.au/subscribe)

## Project timeline

- 2018**
  - Site investigation
- 2019**
  - Community engagement on what's important to the Glenroy community
  - Design development on the rail under road solution
- Early 2020**
  - Further community engagement on key elements of the design
- Late 2020**
  - Further community consultation
  - Finalise design
  - Works proposed to start

*\*Timeline above subject to change*

## CONTACT US

contact@levelcrossings.vic.gov.au  
1800 105 105  
Level Crossing Removal Project  
GPO Box 4509, Melbourne VIC 3001

Follow us on social media  
[@levelcrossings](https://www.facebook.com/levelcrossings)



Translation service – For languages other than English, please call 9280 0780.

Please contact us if you would like this information in an accessible format.

If you need assistance because of a hearing or speech impairment, please visit [relayservice.gov.au](http://relayservice.gov.au)