



WARRIGAL ROAD, MENTONE
PARKERS ROAD, PARKDALE

CONSULTATION REPORT

July 2022



*New Parkdale Station.
Artist impression,
subject to change.*

Contents

Consultation summary	2
What we heard	2
How community feedback has shaped the design	3
Design feedback survey	4
The new station precinct	4
Materials	4
Paving	5
Landscaping	5
Planting	6
Parking	6
Artwork	7
The existing Parkdale Station	8
Thank you and next steps	9
Keeping in touch	9
Project timeline	9



*New Parkdale Station – station forecourt.
Artist impression, subject to change.*

Warrigal Road, Mentone and Parkers Road, Parkdale

The Level Crossing Removal Project is removing 85 dangerous and congested level crossings by 2025, with 67 already gone for good. Another 8 level crossing removals on the Upfield line have recently been added, and these will be gone in 2027.

The Victorian Government is removing 20 dangerous level crossings and building 13 new stations as part of upgrades on the Frankston line that will improve safety, reduce congestion and allow more trains to run more often.

We're removing the dangerous and congested Warrigal Road and Parkers Road level crossings by building a rail bridge over the roads and a new Parkdale Station.

A new rail bridge will reduce local congestion and allow more trains to run more often, as well as deliver new open space and better local connections for the community.

Works are due to start in 2023, with boom gates removed and the project completed by 2025.

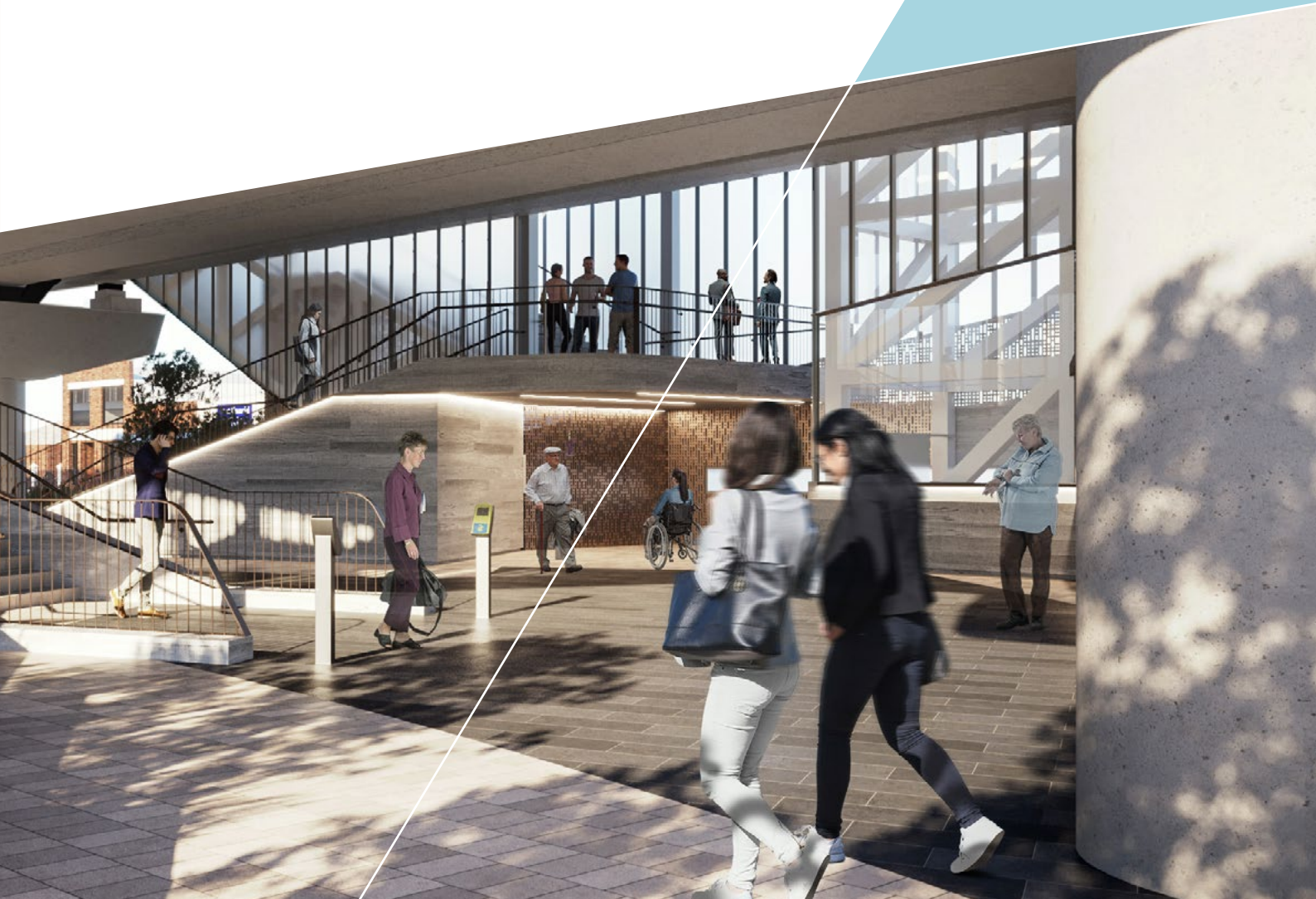

CONSULTATION SUMMARY

In June 2022, we released early concept designs for the new station precinct and open space.

We asked you to share your ideas and feedback on aspects of the early designs, including the overall look and feel, materials and style of landscaping.

We received more than 400 online and hard-copy submissions.

Community feedback has helped shape our updated designs and we thank everyone for their input.

401 design feedback surveys completed



2 Parkdale Open Space Advisory Panel meetings



170 people attended nine face-to-face and two virtual community information sessions



What we heard

New station precinct and open space

- More than half of respondents told us they would like the new station precinct to have a more subdued look and feel that incorporates characteristics and features of the local area.
- Around 60 per cent of respondents expressed a preference for timber to be used in the new station precinct, followed by warm-coloured concrete with a timber pattern, brick and glass.
- Bluestone and warm-toned and lighter-coloured granite were the most popular paving options for the new station precinct and open space.

Landscaping and planting

- More than half of respondents would like to see a mix of landscaping styles throughout the open space corridor and around a third expressed a preference for an informal landscaping style.
- Around half of respondents would like to see native bush and flowering plants, with 42 per cent opting for a mix of native and exotic trees for local character.

Car parking

- More than a third of respondents think car parking at Parkdale Station is very important, while there is a relatively even split between those who think it is not important (27 per cent) and those who think it is somewhat important (26 per cent).
- A total of 28 per cent of respondents would like all the gravel car parks along the corridor north of Parkdale Station to be reinstated and used for station parking. Around 22 per cent would prefer some of these car parks to be reinstated for trader/mixed use/time restricted parking and 19 per cent would like some of these car parks to be reinstated for station car parking, with some of the area used for open space.

Other design elements

- Almost two thirds of respondents expressed a preference for artwork that reflects the history and heritage of Parkdale. There is also some interest in artwork with Indigenous themes.
- More than half of respondents told us they would like to see the existing Parkdale Station repurposed.

How community feedback has shaped the design

	What we heard	How we're delivering on your feedback
Overall look and feel of station precinct and open space design	<ul style="list-style-type: none"> • Many locals would like the new station precinct design to have a more subdued look and feel that incorporates the characteristics and features of the local area. • There is a preference for warm-toned natural materials to be used in the new station precinct and open space. 	<ul style="list-style-type: none"> • The design of the station precinct and open space aims to enhance the coastal character of Parkdale and maximise the opportunity for new trees, greenery, landscaping and natural light. • We will use warm and light-toned materials such as timber, granite and stone in the station precinct and open space design.
New open space	<ul style="list-style-type: none"> • People love the trees, parks and gardens in Parkdale and local birdlife. We heard that locals would like to see more trees and greenery in the area, including native species. • Popular recreational items for the new open space included gathering places, walking and cycling paths, nature-based play spaces, a village green and sporting facilities. 	<ul style="list-style-type: none"> • We will create a green corridor with trees and planting throughout, including canopy trees and reinstated palm trees. • Landscaping will focus on native and indigenous plantings in an informal style, with pockets of exotic species. • The open space includes various gathering places, a village green, nature-based play areas, and a children's garden, a basketball half court and open-air gym. • A new walking and cycling path will link with the shared path from Mentone and meander through the centre of the linear park.
Existing station building	<ul style="list-style-type: none"> • Many locals said they would like to see the existing Parkdale Station repurposed and included in the open space. 	<ul style="list-style-type: none"> • The existing Parkdale Station will be repurposed and located in the new open space.
Car parking	<ul style="list-style-type: none"> • Car parking will be included within the station precinct. 	<ul style="list-style-type: none"> • We are refining car parking plans and further information will be available as part of final design.

Como Parade West. Artist impression, subject to change. Trees and plants depicted at 10 years from planting.



DESIGN FEEDBACK SURVEY

The new station precinct

The new station precinct will have a station forecourt and gathering spaces, as well as walking and cycling paths.

We asked you what you would like the overall look and feel of this area to be.

More than half of respondents told us they would like the new station precinct to have a more subdued look and feel that incorporates characteristics and features of the local area.

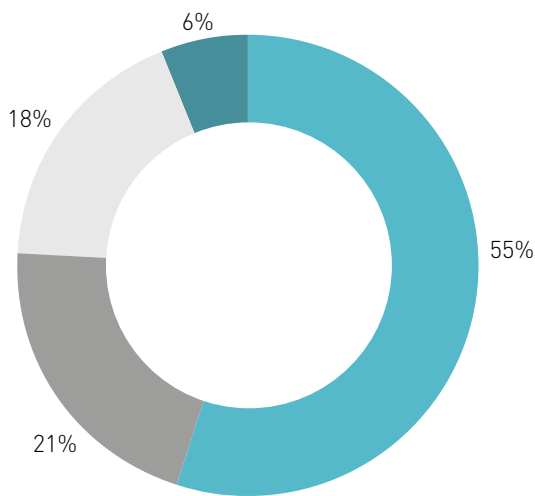

- A more subdued look and feel that incorporates characteristics and features of the local area
- A contemporary look and feel that incorporates characteristics and features of the local area
- A blend of the above
- A vibrant look and feel that is unique and distinctive

Materials

We asked you what types of materials you would like to see used in the new station precinct.

More than half of respondents would like to see timber used in the new station precinct, followed by warm-coloured concrete with a timber pattern and brick.

Note that multiple responses could be made.

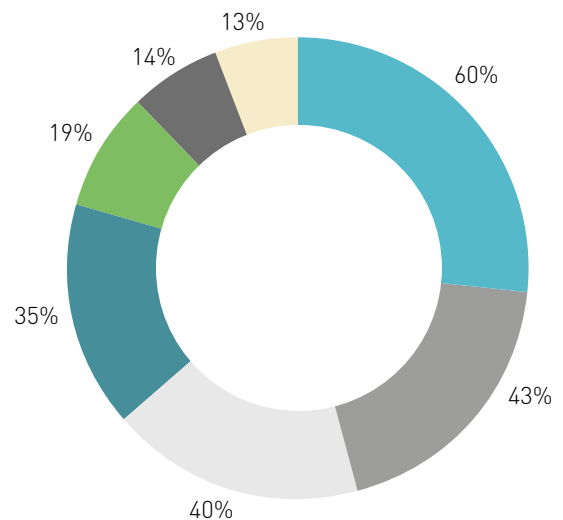

- Timber
- Warm-coloured concrete with a timber pattern
- Brick
- Glass
- Perforated metal screening
- Aluminium/painted steel screening
- Other (please specify)

Paving

We asked you what type of paving you would like to see in the new station precinct and open space.

Almost half of respondents expressed a preference for bluestone paving in the new station precinct and open space, the second preference was for warm-toned and lighter-coloured granite.

There was also some interest in exposed aggregate concrete and warm-coloured concrete, while there was less support for other options.

Note that multiple responses could be made.

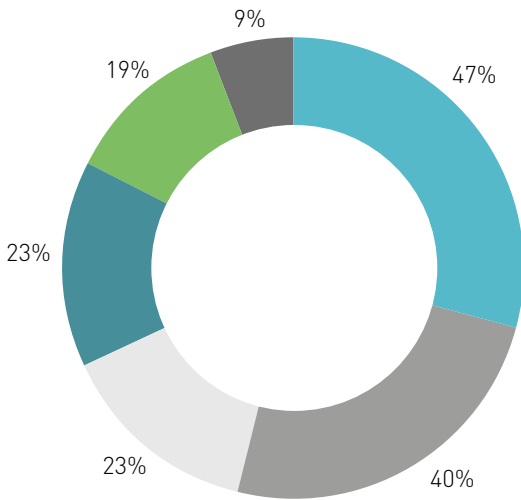

- Bluestone
- Warm toned and lighter coloured granite
- Exposed aggregate concrete
- Warm coloured concrete
- Brick
- Other (please specify)

Landscaping

As part of the new station precinct and open space, we will be planting new trees and greenery.

We asked you what style of landscaping you would like to see.

More than half of respondents would like to see a mix of landscaping styles throughout the open space corridor. Around a third of respondents expressed a preference for an informal landscaping style. There was less support for other options.

Note that multiple responses could be made.

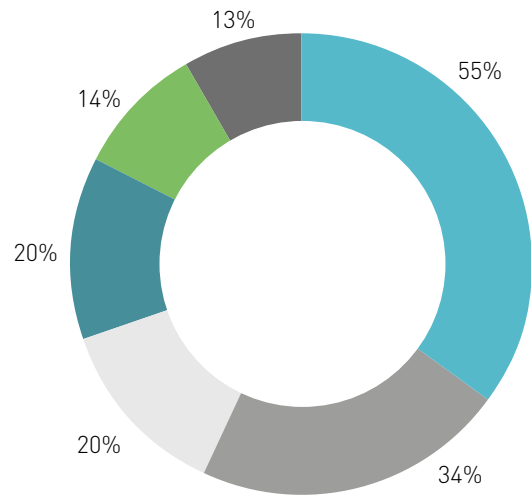

- A mix of landscaping styles throughout the open space corridor
- Informal landscaping style
- Featured landscape areas
- Raised planter boxes and/or garden beds
- Formal landscaped and garden areas
- Other (please specify)

Planting

We asked you what types of plants you would like to see.

Half of respondents would like to see native bush and flowering plants, as well as both native and exotic trees in the new station precinct and open space.

Note that multiple responses could be made.

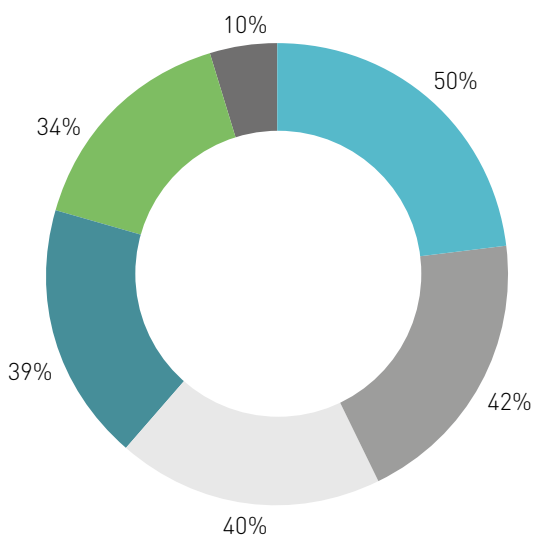

- Native bush and flowering plants
- A mix of native and exotic trees for local character
- Native trees
- Indigenous trees and planting (plants typical to the area)
- Existing mature exotic plants (e.g. palm trees)
- Other (please specify)

Parking

We asked you how important car parking is to you at Parkdale Station.

More than a third of respondents told us that car parking at Parkdale Station is very important. There was a close split between those who think that it is not important and those who think it is somewhat important. Around 10 per cent of people told us parking was not relevant to them.

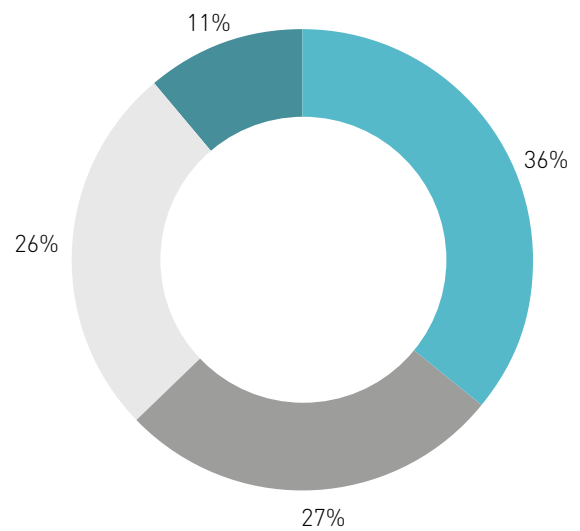

- Very important
- Not important
- Somewhat important
- Not relevant

Public artwork at Bayswater Station.

There are currently gravel car parks along the corridor to the north of Parkdale Station which are used as all-day parking.

We asked you what you would like to see us do with these car parks as part of the project.

A total of 28 per cent of respondents would like all of this car parking to be reinstated and used for station parking.

More than 40 per cent of respondents expressed a preference for some of it to be reinstated, either as station parking or as trader/mixed-use/time-restricted parking, with some of the area used for open space.

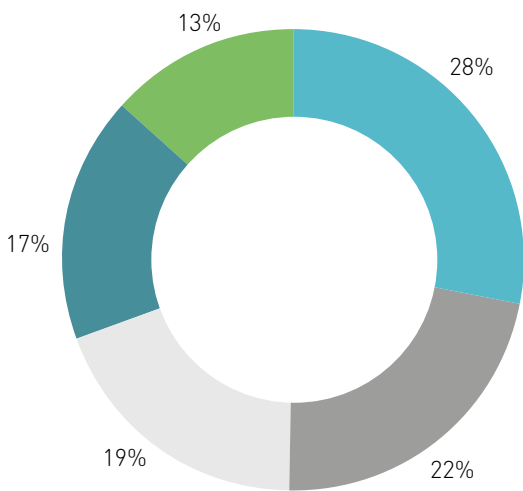

- Reinstate all as part of the open space, and used for station parking
- Reinstate some for trader/mixed use/time restricted parking, with some of the area used for open space
- Reinstate some for station parking, with some of the area used for open space
- Reinstate none with all of the area used for open space
- Reinstate all to be used for trader/mixed use/time restricted parking

Artwork

We asked you what types of artwork you would like to see.

More than 60 per cent of respondents expressed a preference for artwork that reflects the history and heritage of Parkdale. There was also some interest in artwork with Indigenous themes. There was less interest in artwork with community themes or that is unique and/or abstract.

Note that multiple responses could be made.

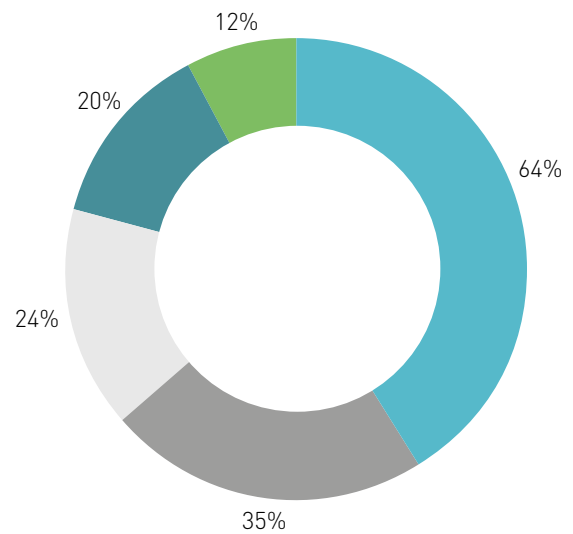

- Artworks that reflect the history and heritage of Parkdale
- Artworks with Indigenous themes
- Artworks with community themes
- Unique and/or abstract artworks
- Other (please specify)

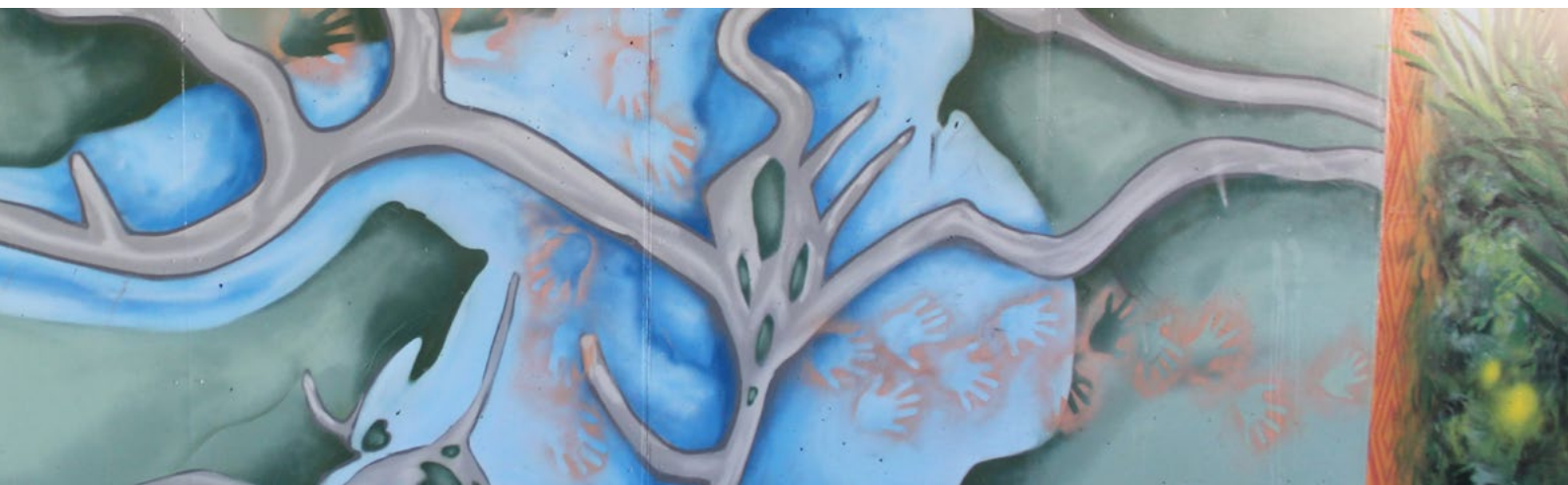

The existing Parkdale Station

We asked you if you would like to see the existing Parkdale Station repurposed and included in the new station precinct or open space as part of the project.

More than half of the respondents told us they want to see the station repurposed. Around a third do not want it to be repurposed, while the remainder are unsure.

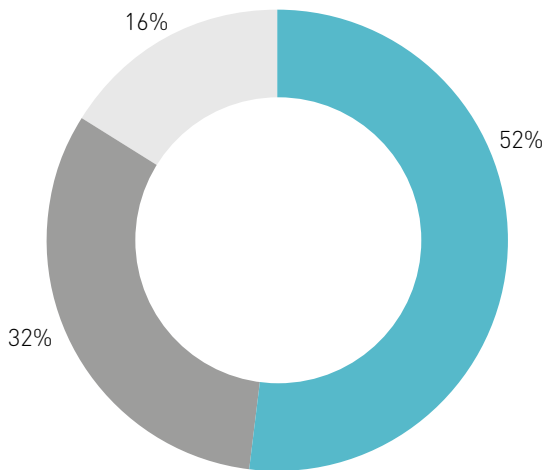

- Yes
- No
- Not sure



The old Clayton Station repurposed as a community waiting area.

New village green. Artist impression, subject to change. Trees and plants depicted at 10 years from planting.

THANK YOU AND NEXT STEPS

Thank you to everyone who took the time to provide feedback on the new station precinct and open space.

Your feedback has helped shape the updated designs.

We look forward to sharing final designs in early 2023.

Keeping in touch

To stay up to date subscribe to our email updates, at levelcrossings.vic.gov.au/subscribe and select **Parkdale**.

If you have any questions or would like more information, call **1800 105 105** or email contact@levelcrossings.vic.gov.au 24 hours a day, seven days a week.

Follow us on social media or send us a private message on our **Facebook** page.

Project timeline



Mid 2022

- Early concept designs released
- Community engagement sessions
- Open Space Advisory Panel meetings continue
- Site investigations continue



Late 2022

- Updated designs released
- Community engagement sessions
- Stakeholder liaison group nominations



Early to mid-2023

- Start of works
- Final designs released
- Stakeholder Liaison Group meetings begin



2024

- Level crossings gone
- New Parkdale Station open



2025

- Project completion

Timeline above subject to change.



CONTACT US

contact@levelcrossings.vic.gov.au
1800 105 105

Level Crossing Removal Project
GPO Box 2392, Melbourne VIC 3001

Follow us on social media
[@levelcrossings](#)



Translation service – For languages other than English, please call 9209 0147.

Please contact us if you would like this information in an accessible format.

If you need assistance because of a hearing or speech impairment, please visit relayservice.gov.au