

**WELCOME**

**TO YOUR NEW**

**CROYDON**

**STATION**



*Looking towards the new Croydon Station forecourt from Wicklow Avenue. Artist impression only, subject to change.*

# The Lilydale Line is now level crossing free!

**The Lilydale Line is the first metropolitan Melbourne train line to be level crossing free – one year ahead of schedule.**

Trains are now up and running on the Lilydale Line after major construction works in Ringwood East and Croydon to remove the last two remaining level crossings on the line and build new two new stations.

In Croydon, the new station is now open, trains are running along the new 687-metre-long rail bridge and vehicles are driving on the new Kent Avenue to Lacey Street connection.

## **Works will continue into spring to:**

- finish the new Croydon Station and Transport Hub
- build the new Devon Street to Wicklow Avenue and Main Street to Coolstore Road connections
- complete landscaping and finishing works.

The new road connections will link Croydon's retail precincts and create more options to cross the rail line.

**We thank residents, commuters and traders for their patience while we delivered the biggest upgrade to the Lilydale Line since it was electrified in the 1920s.**



**Union Station**



**Manchester Road level crossing removal and Mooroolbark Station**

# Your new Croydon Station

## The new Croydon Station is now open to passengers.

Passengers are now able to catch Lilydale Line trains from the new Croydon Station.

Station facilities available include lifts, stairs, station waiting room and myki facilities.

Passengers can access the station platforms from the main entrance, adjacent to Wicklow Avenue and the Croydon Town Square.

Pedestrians are able to walk from Main Street through to Wicklow Avenue via the station concourse.

The new Croydon Transport Hub car parks will open in late 2024. Alternative commuter parking is available at the Devon Street multi-level car park.

**Works will continue on the new Croydon Station and Transport Hub into spring. Over the coming months we will continue working to:**

- add the finishing touches to the station
- open the new Devon Street to Wicklow Avenue and Coolstore Road to Main Street connections
- open the new Croydon Transport Hub car parks
- open the new Croydon Transport Hub 14-bay bus interchange
- build the new shared use paths and pedestrian connections
- plant more than 70,000 new trees, shrubs and grasses.

Temporary fencing will be in place around the station precinct to keep passengers safe while we continue working on the new Croydon Station and Transport Hub.

When complete, the new Croydon Transport Hub will feature CCTV and improved lighting, a 14-bay bus interchange, as well as a new waiting room, toilets, lifts and stairs to access the station platforms.

*New landscaping linking Croydon town square to the new Croydon Transport Hub. Trees and plants depicted at 3 to 5 years from planting. Artist impression only, subject to change.*



# How to access Croydon Station

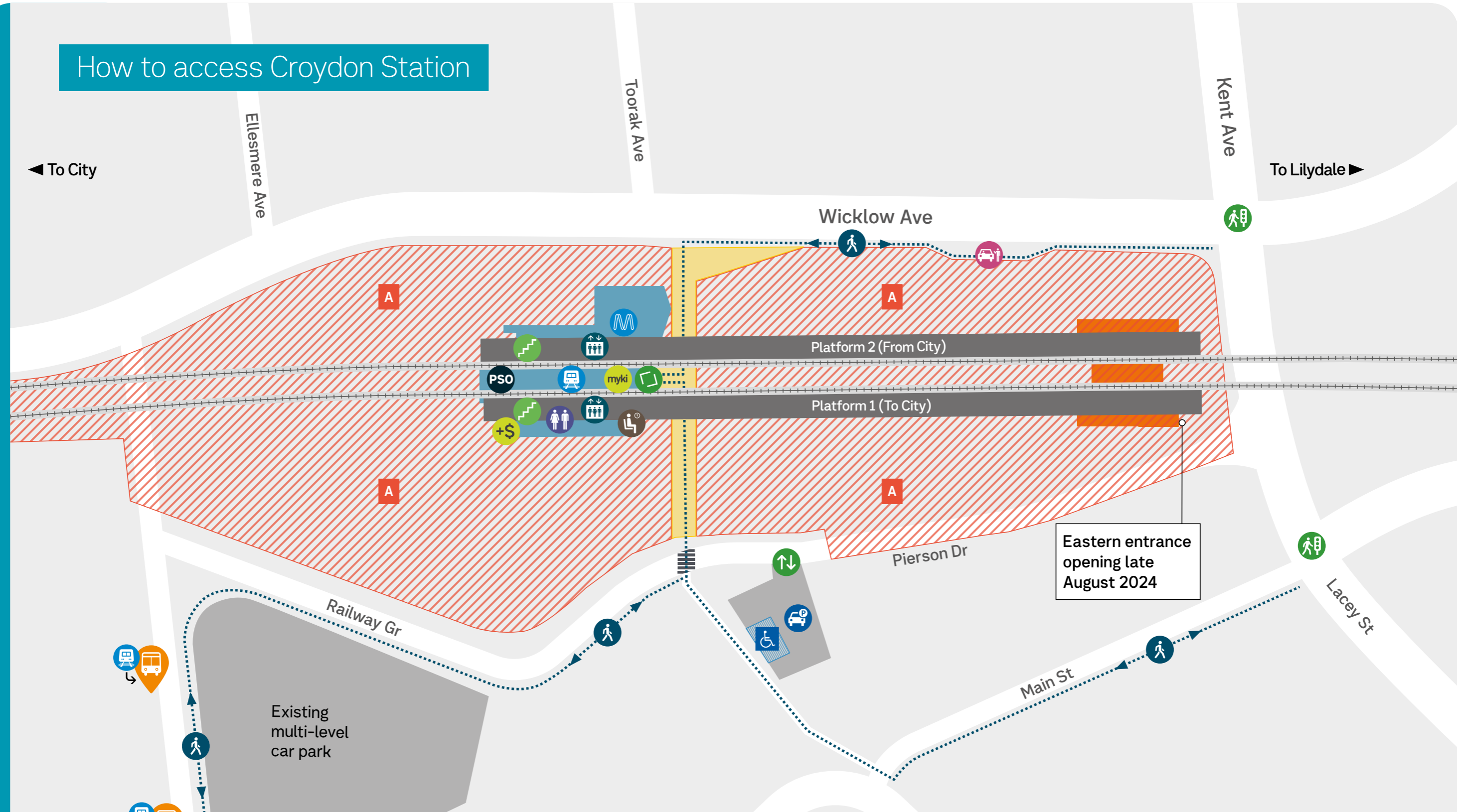

Croydon Station	Elevators	Construction area (no public access)	Accessible parking	Pick up and drop off zone	Station entrance	Car park access
Pedestrian path	Stairs	Station forecourt	Staff parking	Signalised crossing	myki top up machine	Pedestrian crossing
Toilets	Waiting room	myki card machine	Temporary train replacement bus stop	PSO office	Customer service office	

NOT TO SCALE

# New Kent Avenue to Lacey Street connection opens

More than 10,000 vehicles are now enjoying safer and less congested journeys through Croydon town centre, with the new Kent Avenue to Lacey Street connection open.

In a full circle moment for Croydon, the new road connection is in almost the same location as the old level crossing from the 1940's.

Thank you to everyone who came out and celebrated this milestone and joined us to walk, drive or cycle across the new road connection for the first time on Friday 5 July.

The milestone was commemorated with a vintage car drive-through, before the road officially opened to traffic.

Works will continue into spring on the new Devon Street to Wicklow Avenue and Coolstore Road to Main Street road connections.



Kent Avenue level crossing – Image courtesy of Ringwood & District Historical Society



Cars travelling over the new Kent Avenue to Lacey Street connection

## Project timeline



### 2022

- Early designs announced
- Community consultation
- Contract awarded



### 2023

- Updated designs released
- Early works begin
- Major works begin



### Early 2024

- Croydon Station closed
- Coolstore Road closed at the level crossing



### Mid 2024

- Major construction blitz
- Lilydale Line level crossing free
- New Kent Avenue to Lacey Street road connection opens
- New Croydon Station opens to passengers



### Late 2024

- New Croydon Transport Hub opens
- Croydon Transport Hub car parks open
- New road connections open
- Plant more than 70,000 new trees, shrubs and grasses
- Finishing works complete

\* Timeline subject to change.

[levelcrossings.vic.gov.au](https://levelcrossings.vic.gov.au)

[contact@levelcrossings.vic.gov.au](mailto:contact@levelcrossings.vic.gov.au)



For languages other than English, please call 9209 0147.

1800 105 105 (call anytime)

Please contact us if you would like this information in an accessible format. If you need assistance due to a hearing or speech impairment, visit [relayservice.gov.au](https://relayservice.gov.au)

