

Updated works notice

Surface works requiring Flinders Lane and alley way closures

Flinders Lane, Cocker Alley, Scott Alley and Royston Place

From Monday 15 January 2024

What we are doing

Works are progressing to prepare the laneways around the Flinders Quarter site for pedestrian access into the new Town Hall Station.

Both Cocker Alley and Scott Alley will become station entrances while Royston Place will become a service point for the station's waste facility.

During an eight week program of works:

- While Flinders Lane is closed, the southern footpath will be widened so more pedestrians can safely access the new station when it opens
- While Cocker Alley and Scott Alley are closed, essential utility services will be installed and connected to the new station, key equipment will be installed, and laneways re-levelled and paved
- While Royston Place is closed, road resurfacing and a traffic management system for waste vehicles will be installed.

Flinders Lane traffic

The Project team will reopen Flinders Lane to traffic, when it is safe to do so, Monday to Friday 12:30am to 6:30am, Saturday 1:30pm until Monday 6:30am.

There may be times where it is not safe to reopen Flinders Lane during these times, for example following a concrete pour that needs to set.

Cocker Alley and Scott Alley will remain closed.

What to be aware of

- The section of Flinders Lane between Swanston Street and Royston Place will be closed to traffic from 15 January for up to eight weeks
- Cocker Alley and Scott Alley will also be closed from 15 January for up to eight weeks and arrangements will be in place for businesses and tenants during this period
- Royston Place will be closed for up to two weeks and arrangements will be in place for businesses, carpark and residential access during this time
- Access to residential buildings will be maintained
- Emergency egress from the Nicholas Building onto Cocker Alley will be maintained
- See overleaf for further details on traffic and pedestrian arrangements, parking impacts, and noise and vibration impacts.

When

- Monday 15 January for up to 8 weeks
- Monday to Friday, 6:30am to 12:30 am
- Saturday, 6:30am to 1:30pm.

We appreciate your patience while we undertake these works. If you have any questions or concerns, please contact the Metro Tunnel Project Information Line on **1800 105 105**.

Further information on Town Hall Station works can be found at metrotunnel.vic.gov.au

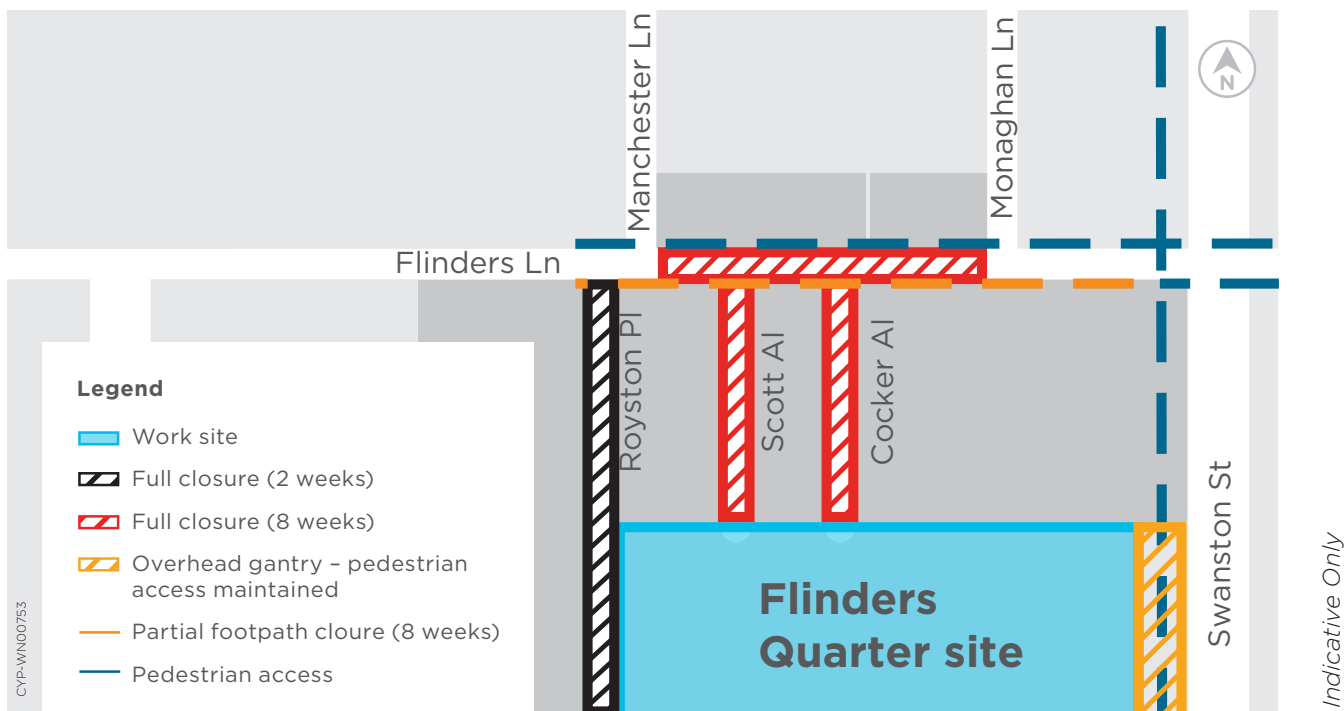

Traffic arrangements

- During the closure, Flinders Lane will be closed to vehicles between Swanston Street and Royston Place. Drivers travelling from Russell Street down Flinders Lane will be able to access driveways and delivery areas under traffic management
- Driveway access will be maintained to properties between Russell Street and Regent Place, and vehicles exiting carparks on Flinders Lane will be required to travel east to Russell Street under traffic management and a detour using Flinders Street or Collins Street
- For access to properties on Flinders Lane between Swanston and Elizabeth streets, drivers will need to enter Flinders Lane via Elizabeth Street
- Cyclists should observe detour routes and will be able to access properties or delivery areas under traffic management.

Pedestrian arrangements

- Pedestrian access will be maintained along Flinders Lane on the northern footpath
- Residential building access will be maintained to properties on Flinders Lane
- Cocker Alley, Scott Alley and Royston Place will be closed to pedestrians during works. Alternative arrangements will be made with residents and businesses during this time.

Noise and vibration

- Some of the work, such as demolition of the paving and excavation to install utilities, will create high levels of noise. The project team will make every effort to schedule noisy work at times when there is minimum impact to the community
- The majority of these works will take place from 7am to midnight, Monday to Saturdays, with some works required beyond these hours where necessary
- There will be some periods of high-level noise and vibration during day shifts and some periods of medium level noise beyond these hours.

Parking

- During these works parking spaces on Flinders Lane between Swanston Street and Royston Place will be unavailable
- As part of these works we are widening the southern footpath along Flinders Lane outside Cocker and Scott alleys, so more people can use the footpath to access Town Hall Station when it opens
- Two parking spaces will be permanently removed (one loading bay in front of Ashdown House and one disabled parking space in front of Bible House) to accommodate the wider footpath
- The two disabled parking spaces in front of Ross House will remain.

More information

metrotunnel.vic.gov.au

1800 105 105
(24 hours a day, 7 days a week)

Rail Projects Victoria
PO Box 2392, Melbourne, VIC 3001



Interpreter Service (03) 9209 0147

It should be noted that this information is current at the time of printing, however due to unforeseen circumstances, changes may occur. Please visit railprojects.vic.gov.au for the latest updates.