

PORT PHILLIP

PLAN TO DESIGNATE THE PROJECT AREA PURSUANT TO SECTION 95(2) MAJOR TRANSPORT PROJECTS FACILITATION ACT 2009
 Lodged in Central Plan Office
 Dated this 30th day of JANUARY 2018

 Craig Leslie Sandy, Survey General

LEGEND
 PROJECT AREA

SEAFORD ROAD, SEAFORD
 All coordinates expressed on the plan, unless otherwise indicated, are expressed in GDA94 MGA94 ZONE 55.
 Doc No: SPA-043-D-LXA-MAP-00-CGS-XGS-0001 Version 3-00



LEVEL CROSSING REMOVAL PROJECT

0 250 500 750 1,000
 Paper Size A3 Scale 1:25,000 metres

Index
 Sheet 1 of 22
LEGL/17-354

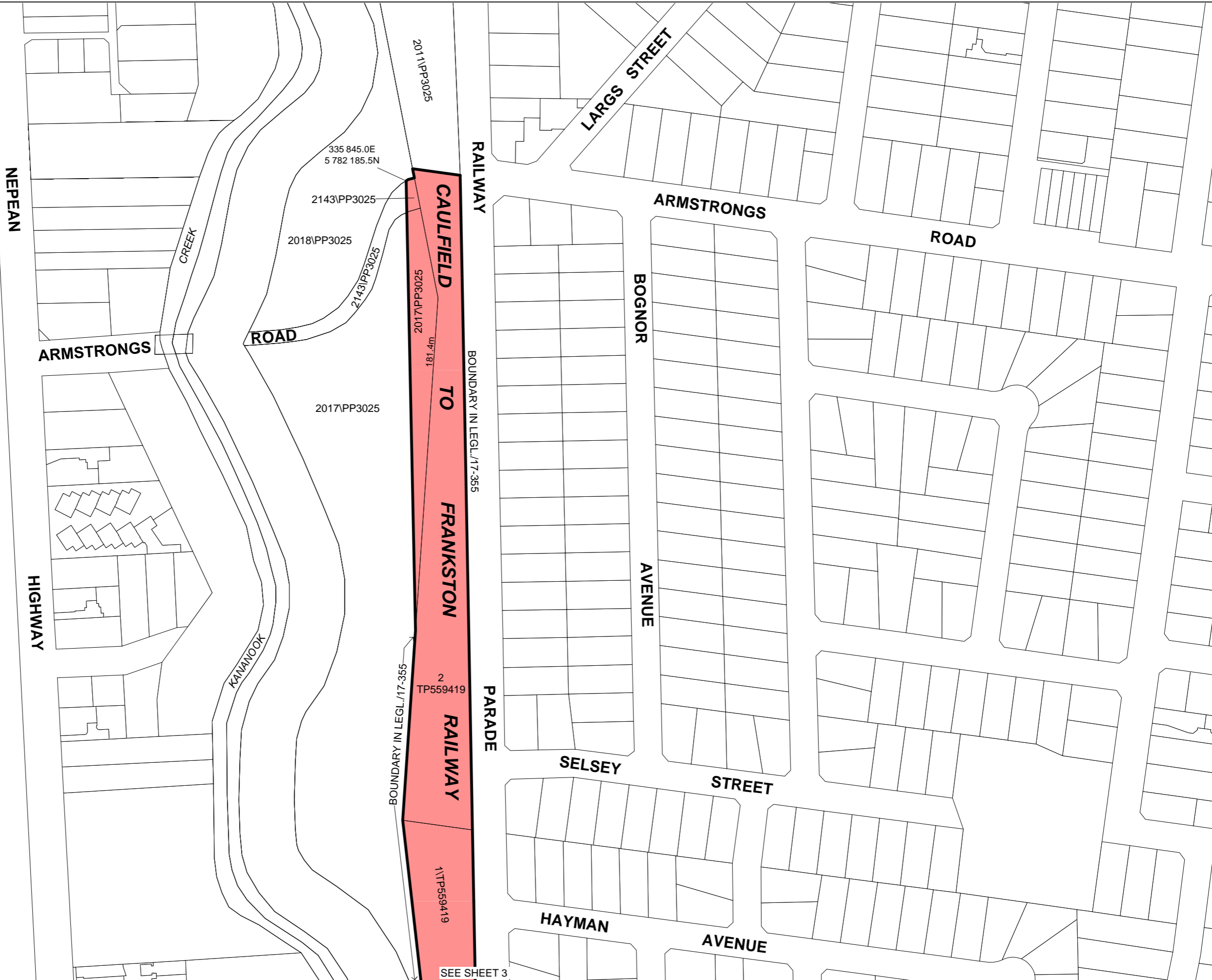

LEGEND
 PROJECT AREA

SEAFORD ROAD, SEAFORD

Doc No: SPA-043-D-LXA-MAP-00-CGS-XGS-0001 Version 3-00



LEVEL CROSSING REMOVAL PROJECT

0 20 40 60 80
 Paper size: A3 Scale 1:2,000 metres

Sheet 2 of 22
LEGL./17-354

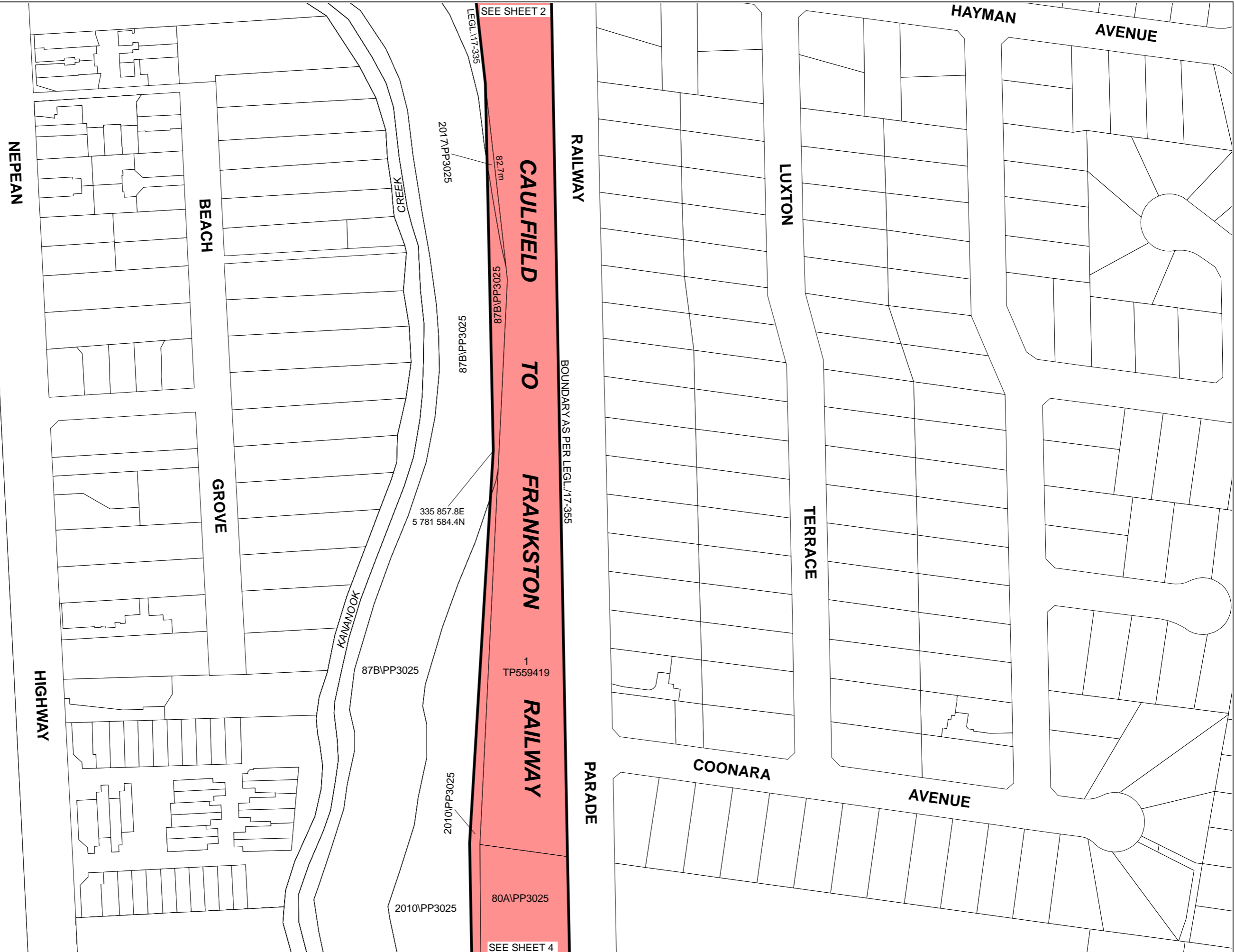

LEGEND
 PROJECT AREA

SEAFORD ROAD, SEAFORD

Doc No: SPA-043-D-LXA-MAP-00-CGS-XGS-0001 Version 4-00



LEVEL CROSSING REMOVAL PROJECT

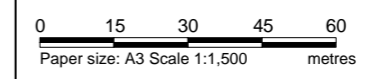

GDA94 MGA ZONE 55



HIGHWAY

VICTOR AVENUE

KANANOOK

CREEK

NEPEAN

2010\PP3025

SEE SHEET 3

2010\PP3025

BOUNDARY IN LEGL./17-355

87B\PP3025

177°9'

2

87°46' 267°46'

RAILWAY

FRANKSTON

TO

CAULFIELD

PARADE

BOUNDARY IN LEGL./17-355

SEAFORD NORTH RESERVE

87B\PP3025

80B\PP3025

80A\PP3025

2102\PP3025

3

4

SEE SHEET 5

TABLE OF CO-ORDINATES

1	335 849.4E	5 781 347.4N
2	335 837.9E	5 781 266.5N
3	335 847.6E	5 781 141.5N
4	335 855.7E	5 781 141.8N

LEGEND

PROJECT AREA

SEAFORD ROAD, SEAFORD

Doc No: SPA-043-D-LXA-MAP-00-CGS-XGS-0001 Version 4-00



LEVEL CROSSING REMOVAL PROJECT

0 10 20 30 40 50
Paper size: A3 Scale 1:1000 metres

Sheet 4 of 22
LEGL./17-354

GDA94 MGA ZONE 55



HIGHWAY

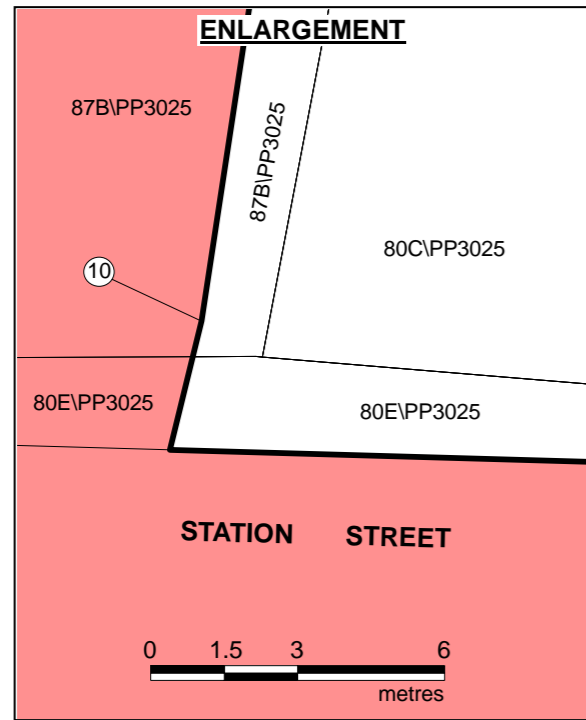

STATION

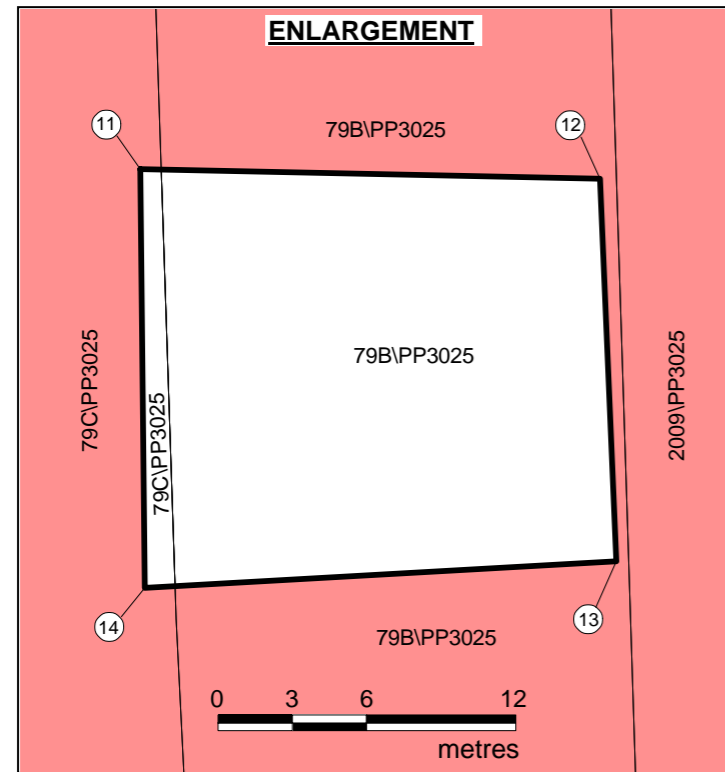

NEPEAN

AVENUE

CHAPMAN

KANANOOK

CREEK

SEE SHEET 4

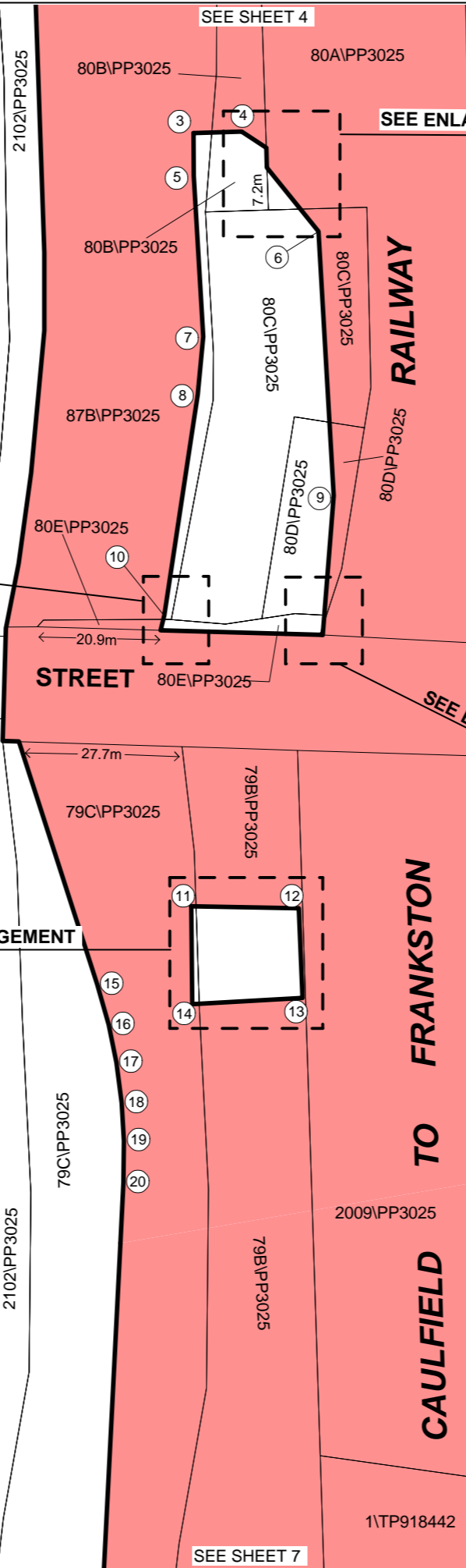

SEE SHEET 7

RAILWAY

CAULFIELD TO FRANKSTON RAILWAY

PARADE

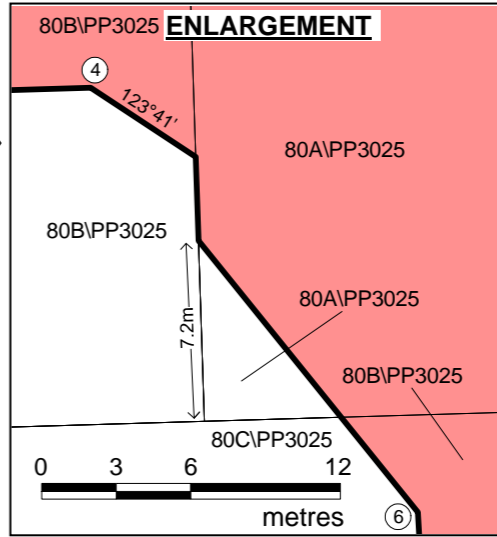

TABLE OF CO-ORDINATES

3	335 847.6E	5 781 141.5N
4	335 855.7E	5 781 141.8N
5	335 847.6E	5 781 134.1N
6	335 868.8E	5 781 124.7N
7	335 849.1E	5 781 106.9N
8	335 848.3E	5 781 097.1N
9	335 871.3E	5 781 079.9N
10	335 842.6E	5 781 059.6N
11	335 847.1E	5 781 010.3N
12	335 865.5E	5 781 009.8N
13	335 866.0E	5 780 994.6N
14	335 847.3E	5 780 993.6N
15	335 831.2E	5 780 996.9N
16	335 833.1E	5 780 990.1N
17	335 834.4E	5 780 983.7N
18	335 835.3E	5 780 976.8N
19	335 835.7E	5 780 970.4N
20	335 835.6E	5 780 963.3N

MCKENZIE STREET

MCKENzie STREET

STREET

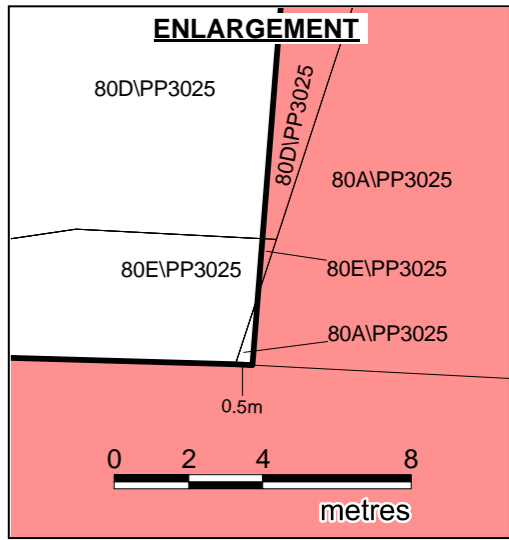

LEGEND

PROJECT AREA

SEAFORD ROAD, SEAFORD

Doc No: SPA-043-D-LXA-MAP-00-CGS-XGS-0001 Version 4-00



LEVEL CROSSING REMOVAL PROJECT

0 10 20 30 40 50 metres

Sheet 5 of 22
LEGL./17-354

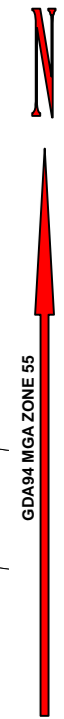

SEE SHEET 5

LEGEND
 PROJECT AREA

SEAFORD ROAD, SEAFORD
 Doc No: SPA-043-D-LXA-MAP-00-CGS-XGS-0001 Version 3-00

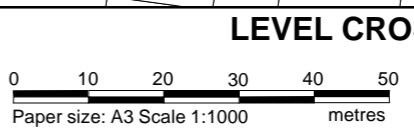

LEVEL CROSSING REMOVAL PROJECT
 Sheet 6 of 22
LEGL./17-354



SEE SHEET 5

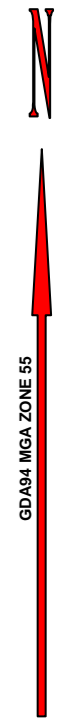

ENLARGEMENT

SEE ENLARGEMENT

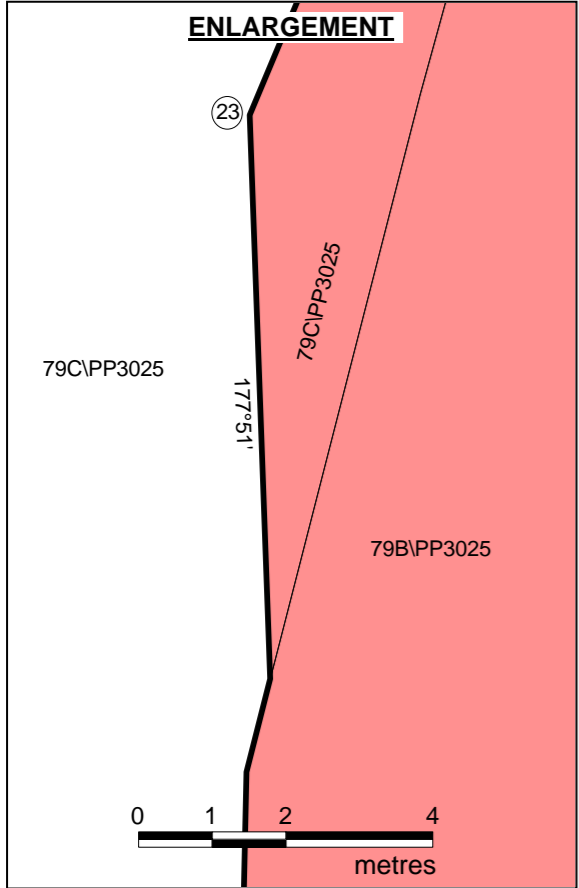
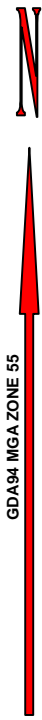
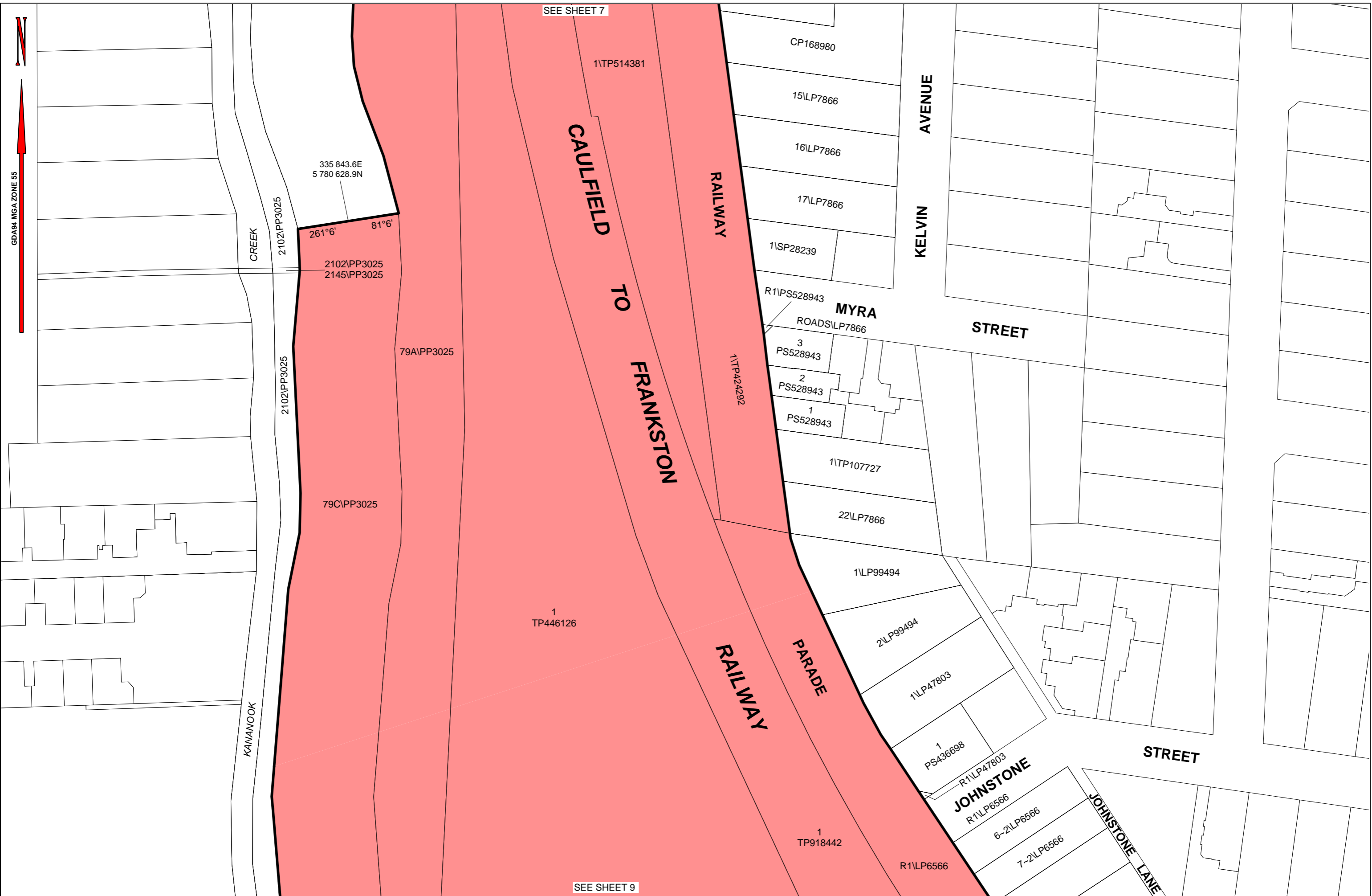

TABLE OF CO-ORDINATES			
21	335 827.4E	5 780 801.4N	
22	335 827.4E	5 780 796.8N	
23	335 825.5E	5 780 792.3N	
24	335 827.0E	5 780 752.6N	



GDA94 MGA ZONE 55



SEE SHEET 7

SEE SHEET 9

LEGEND

 PROJECT AREA

SEAFORD ROAD, SEAFORD

Doc No: SPA-043-D-LXA-MAP-00-CGS-XGS-0001 Version 3-00



LEVEL CROSSING REMOVAL PROJECT

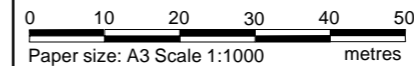



GDA94 MGA ZONE 55

SEE SHEET 8

79A\PP3025

79C\PP3025

1\TP446126

RAILWAY

CAULFIELD

1
TP918442

TO

FRANKSTON

R1\LP6566

1\TP940282

2126\PP2619
ROAD

WEATHERSTON

R1\LP6566
ROAD

PARADE

94-2\LP6566

CREEK

2101\PP2619

KAMANOOK

2101\PP2619

2103\PP2619

48A-A\PP2619

SEAFORD

GOVT. ROAD
2094\PP2619
2101\PP2619
2094\PP2619

CM1\PS432540

4\LP7138

5\LP7138

6\LP7138

7\LP7138

8\LP7138

9\LP7138

1\RP11011
2\RP11011

R1\LP56271
AVENUE

1
SP22845
2
SP22845

FORTESCUE

ROADS\LP10697

1\TP159975

RAILWAY

1
LP12548

1\TP107806

SEE SHEET 11

ELSIE

2\LP77783

46\LP10597

2
LP10597

2
TP918442

SEE SHEET 10

SEE SHEET 10

LEGEND

PROJECT AREA

SEAFORD ROAD, SEAFORD

Doc No: SPA-043-D-LXA-MAP-00-CGS-XGS-0001 Version 4-00



LEVEL CROSSING REMOVAL PROJECT

0 10 20 30 40 50
Paper size: A3 Scale 1:1000 metres

Sheet 9 of 22
LEGL./17-354

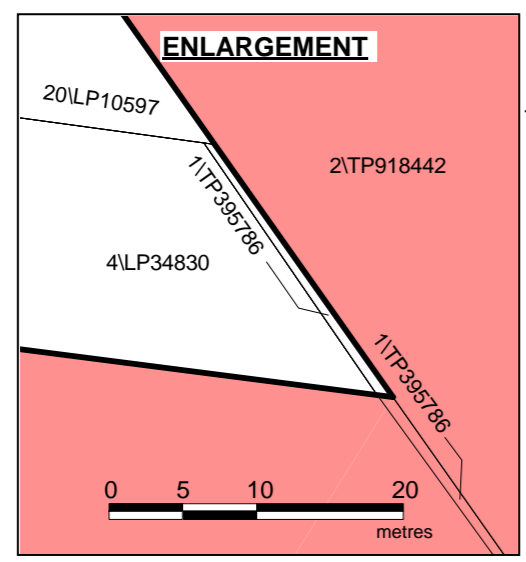

LEGEND
 PROJECT AREA

SEAFORD ROAD, SEAFORD
 Doc No: SPA-043-D-LXA-MAP-00-CGS-XGS-0001 Version 4-00



LEVEL CROSSING REMOVAL PROJECT
 0 15 30 45 60
 Paper size: A3 Scale 1:1,500 metres
 Sheet 10 of 22
LEGL./17-354



LEGEND
 PROJECT AREA

SEAFORD ROAD, SEAFORD
 Doc No: SPA-043-D-LXA-MAP-00-CGS-XGS-0001 Version 4-00



LEVEL CROSSING REMOVAL PROJECT
 0 10 20 30 40 50
 Paper size: A3 Scale 1:1000 metres

Sheet 11 of 22
LEGL./17-354

GDA94 MGA ZONE 55

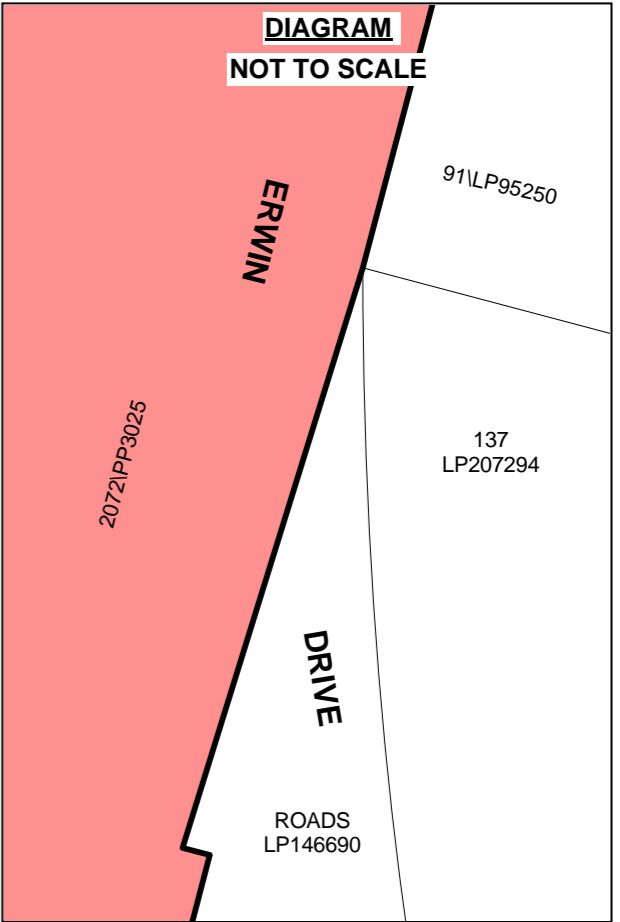

LEGEND
PROJECT AREA

SEAFORD ROAD, SEAFORD

Doc No: SPA-043-D-LXA-MAP-00-CGS-XGS-0001 Version 4-00



LEVEL CROSSING REMOVAL PROJECT

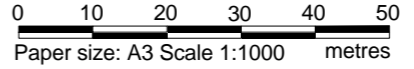



LEGEND
 PROJECT AREA

SEE SHEET 12

SEAFORD ROAD, SEAFORD
 Doc No: SPA-043-D-LXA-MAP-00-CGS-XGS-0001 Version 4-00



LEVEL CROSSING REMOVAL PROJECT

0 10 20 30 40 50
 Paper size: A3 Scale 1:1000 metres

Sheet 13 of 22
LEGL./17-354



SEE SHEET 10

SEE SHEET 15

LEGEND
 PROJECT AREA

SEAFORD ROAD, SEAFORD
 Doc No: SPA-043-D-LXA-MAP-00-CGS-XGS-0001 Version 4-00



LEVEL CROSSING REMOVAL PROJECT
 0 20 40 60 80
 Paper size: A3 Scale 1:2,000 metres
 Sheet 14 of 22
LEGL./17-354

GDA94 MGA ZONE 55

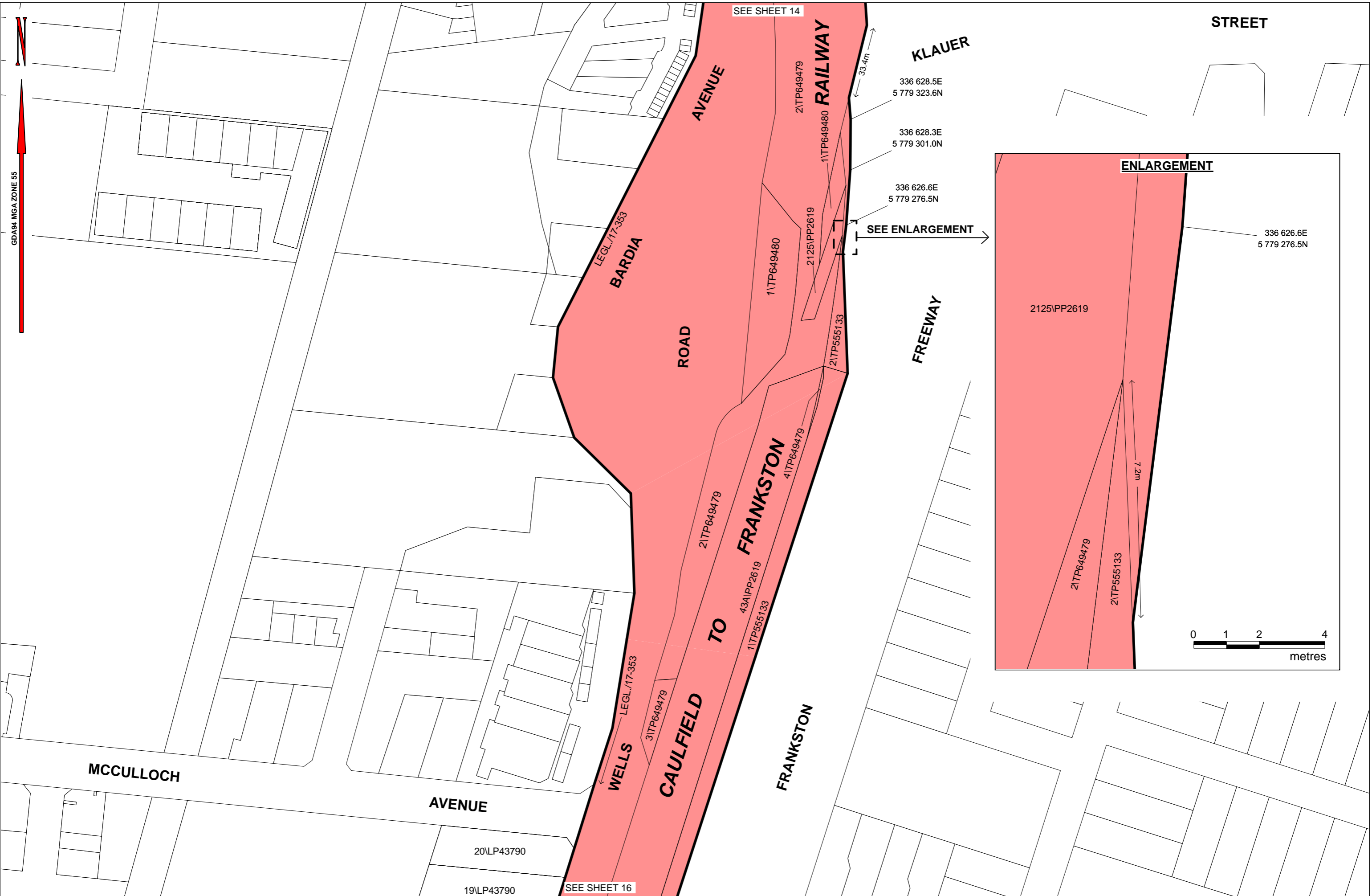

SEE SHEET 14

KLAUER

336 628.5E
5 779 323.6N

336 628.3E
5 779 301.0N

336 626.6E
5 779 276.5N

SEE ENLARGEMENT

ENLARGEMENT

336 626.6E
5 779 276.5N

2125\PP2619

7.2m

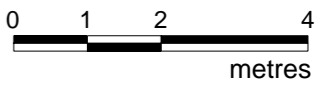

LEGEND
PROJECT AREA

SEAFORD ROAD, SEAFORD



LEVEL CROSSING REMOVAL PROJECT

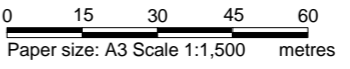

Sheet 15 of 22
LEGL./17-354

Doc No: SPA-043-D-LXA-MAP-00-CGS-XGS-0001 Version 4-00

GDA94 MGA ZONE 55



SEE SHEET 15

20\LP43790

19\LP43790

18\LP43790

CP159723

1\PS439381

2\PS439381

13\LP43790

1\LP142345

2\LP142345

CP103202

ROAD

RAILWAY

FREEWAY

STREET

HADLEY STREET

FRANKSTON

1\TP555133

TO

FRANKSTON

CLAUDE

HANNAH

STREET

BUNA AVENUE

BOUNDARY IN LEGL./17-338
WELLS

43A\PP2619

CAULFIELD

SEE SHEET 17

LEGEND
PROJECT AREA

SEAFORD ROAD, SEAFORD

Doc No: SPA-043-D-LXA-MAP-00-CGS-XGS-0001 Version 3-00



LEVEL CROSSING REMOVAL PROJECT

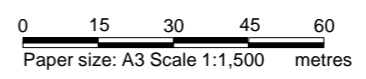

Sheet 16 of 22
LEGL./17-354

GDA94 MGA ZONE 55



SEE SHEET 16



BOONONG

AVENUE

FRANKSTON

RAILWAY

FREEWAY

JUBILEE

AVENUE

NEVILLE

AVENUE

GRANT

AVENUE

CAULFIELD

TO

FRANKSTON

SEE SHEET 18

LEGEND
PROJECT AREA

SEAFORD ROAD, SEAFORD

Doc No: SPA-043-D-LXA-MAP-00-CGS-XGS-0001 Version 3-00



LEVEL CROSSING REMOVAL PROJECT

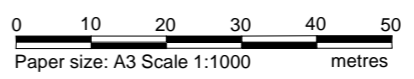

Sheet 17 of 22
LEGL./17-354

GDA94 MGA ZONE 55



SEE SHEET 17

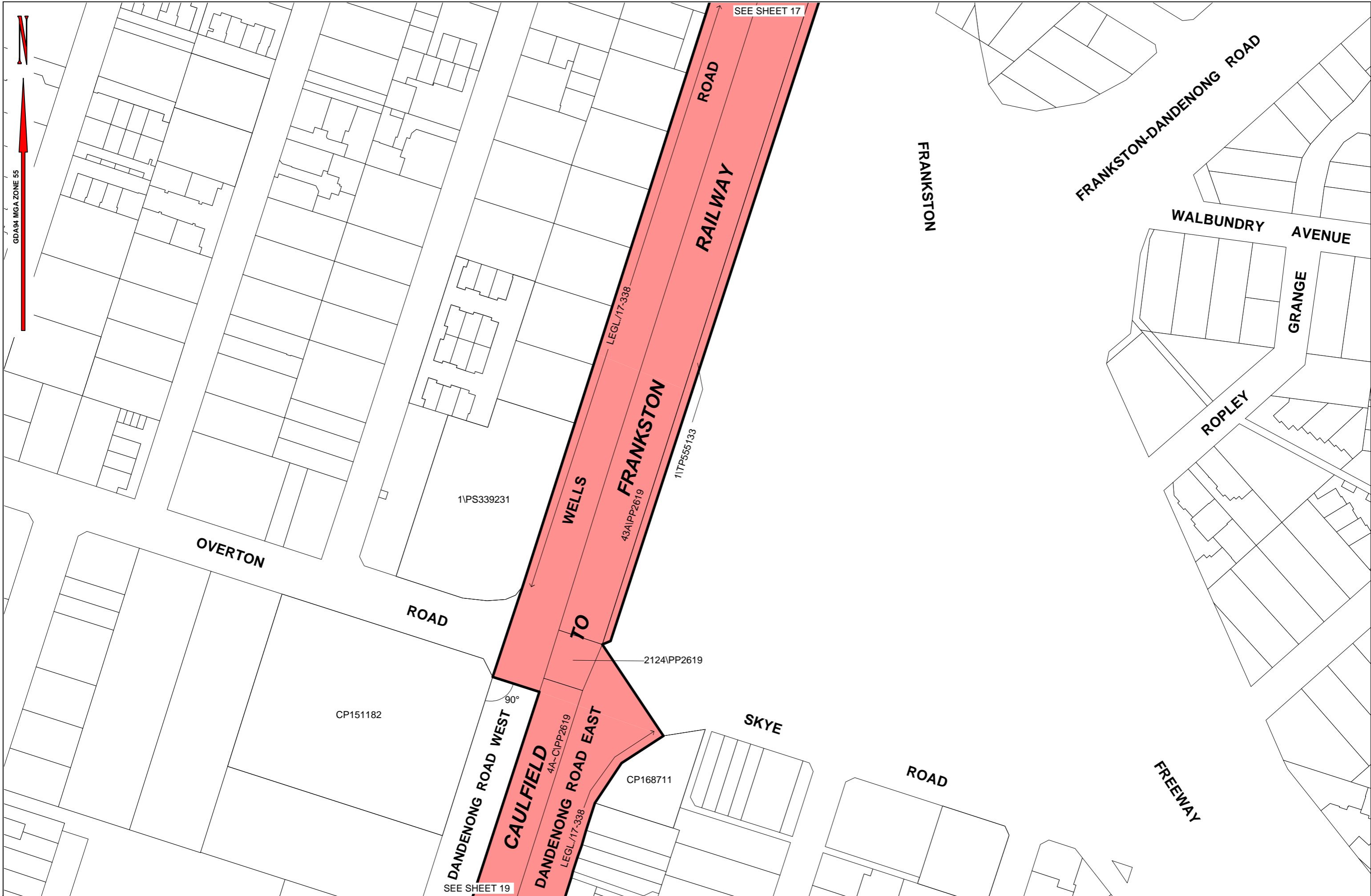

LEGEND
PROJECT AREA

SEAFORD ROAD, SEAFORD

Doc No: SPA-043-D-LXA-MAP-00-CGS-XGS-0001 Version 3-00



LEVEL CROSSING REMOVAL PROJECT

0 15 30 45 60
Paper size: A3 Scale 1:1,500 metres

Sheet 18 of 22
LEGL./17-354

GDA94 MGA ZONE 55



SEE SHEET 18

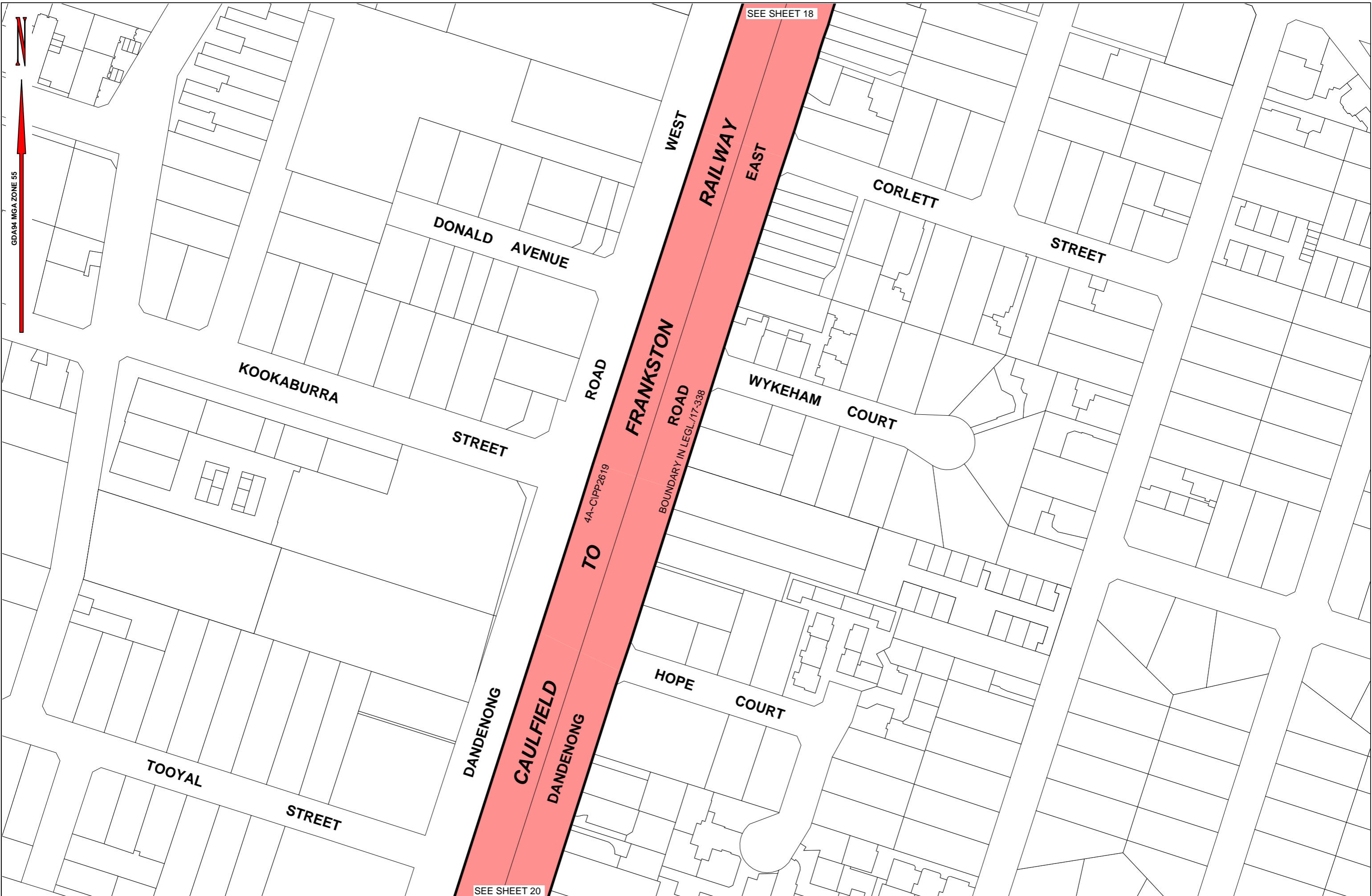

4A-CIPP2619

BOUNDARY IN LEGL./17-338

SEE SHEET 20

LEGEND
PROJECT AREA

SEAFORD ROAD, SEAFORD

Doc No: SPA-043-D-LXA-MAP-00-CGS-XGS-0001 Version 3-00



LEVEL CROSSING REMOVAL PROJECT

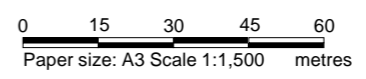

GDA94 MGA ZONE 55



SEE SHEET 19

4A-C/PP2619

90°

MEREWEATHER AVENUE

AVENUE

SHERIDAN AVENUE

AVENUE

DANDENONG

CAULFIELD DANDENONG ROAD

TO ROAD

FRANKSTON

RAILWAY

BOUNDARY IN LEGL./17-338

EAST

COLIN AVENUE

AVENUE

RAYMOND AVENUE

AVENUE

CRICKLEWOOD AVENUE

AVENUE

RODNEY COURT

SEE SHEET 21

LEGEND
PROJECT AREA

SEAFORD ROAD, SEAFORD

Doc No: SPA-043-D-LXA-MAP-00-CGS-XGS-0001 Version 3-00



LEVEL CROSSING REMOVAL PROJECT

0 15 30 45 60
Paper size: A3 Scale 1:1,500 metres

Sheet 20 of 22
LEGL./17-354

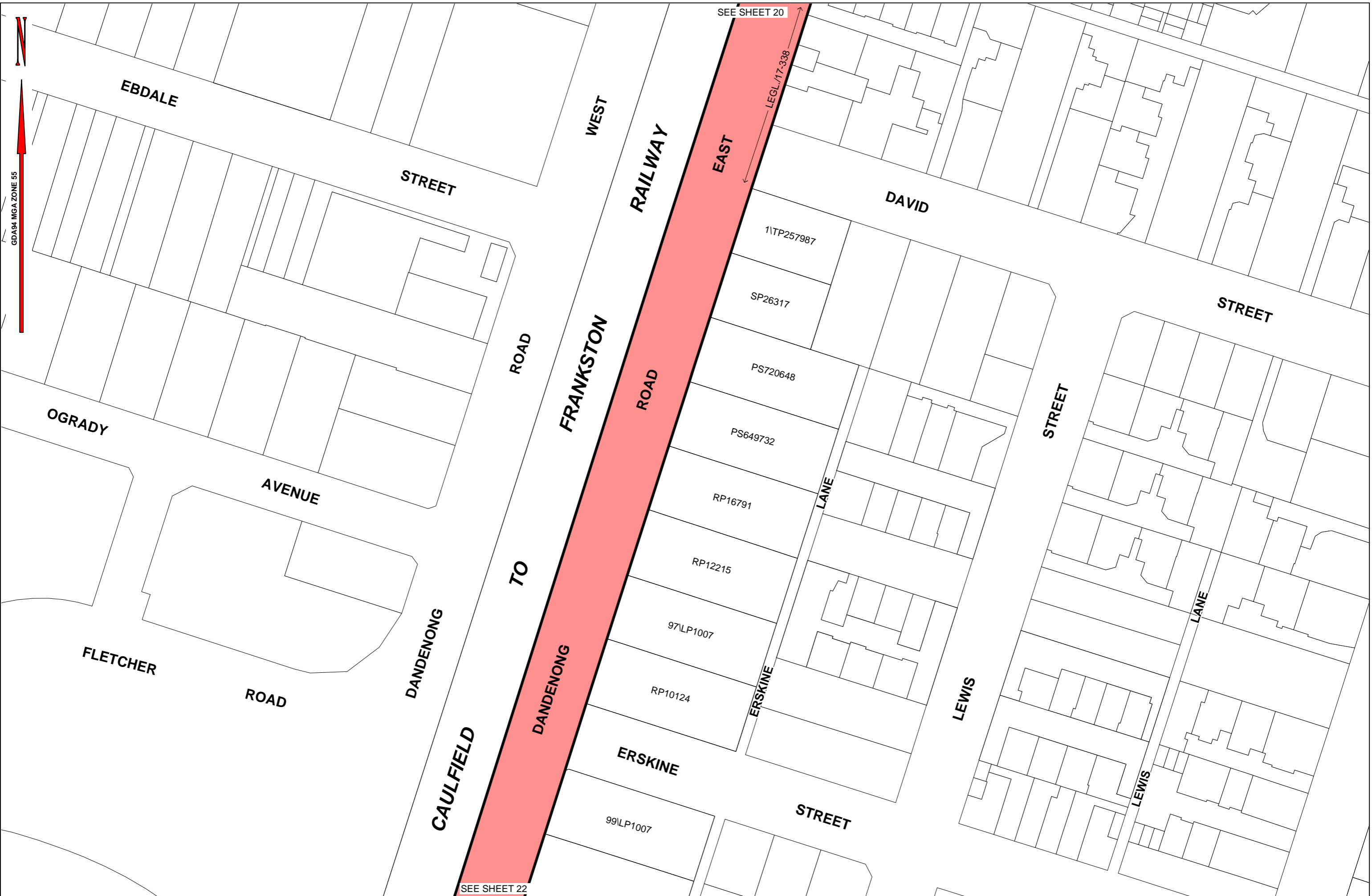

LEGEND
 PROJECT AREA

SEAFORD ROAD, SEAFORD
 Doc No: SPA-043-D-LXA-MAP-00-CGS-XGS-0001 Version 3-00

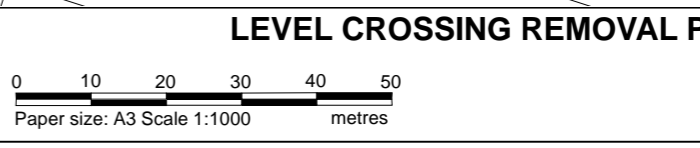

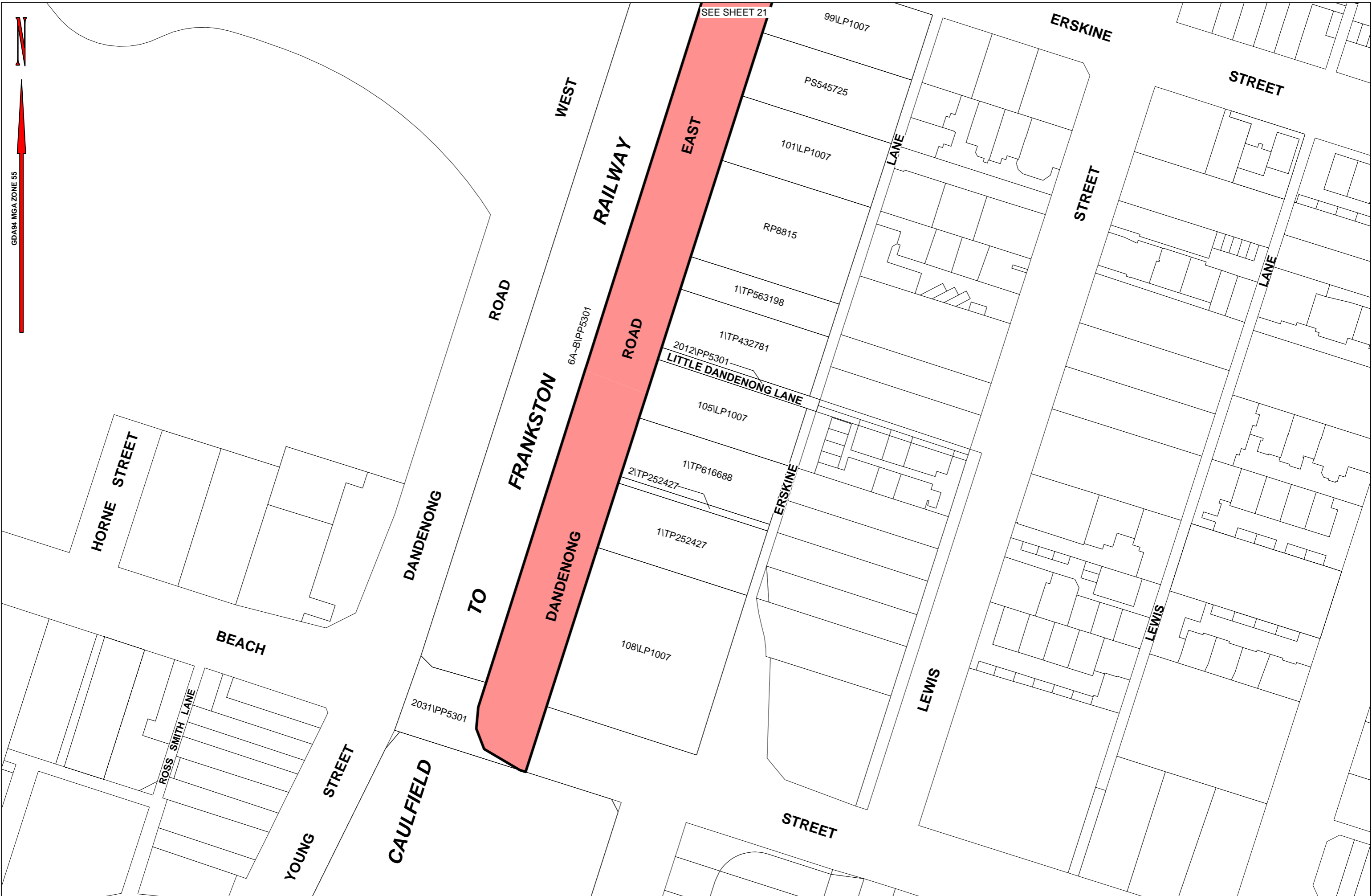

LEGEND
 PROJECT AREA

SEAFORD ROAD, SEAFORD
 Doc No: SPA-043-D-LXA-MAP-00-CGS-XGS-0001 Version 3-00

