

The project

The Caulfield to Dandenong Level Crossing Removal Project is transforming rail and rock into kilometres of new parks, paths and open space, improving the reliability of train services and reducing congestion on local roads.

We are:

- Removing nine level crossings
- Rebuilding five new stations
- Creating 11 MCG's worth of new parkland
- Linking 17kms of shared pedestrian and bicycle paths
- Upgrading 72kms of rail between Southern Cross Station to Cranbourne and Pakenham to support High Capacity Metro Trains

FAQs

Where is the best place to see the straddle carrier?

The recommended viewing path (shown on the map overleaf) shows the best places to currently see the construction. As the straddle carrier moves updates on facebook, our website and at our info hub will tell you where it is working.

What can I see at Murrumbeena Station?

Murrumbeena Station is the construction assembly area where the gantry cranes are located and the straddle carrier will be housed when it is not operational. The assembly area is also where the elevated rail spans are formed from concrete segments.

What else can I do in the area?

Carnegie, Murrumbeena and Hughesdale all have vibrant local communities and shops that are perfect to pause and enjoy some local refreshments and conversation. We've marked out the key shopping precincts on the viewing map.

Murrumbeena Info Hub

Here you can get information about the project, talk to our team, and view a lego model of the assembly area. We also have video animations and lots of photos and fact sheets about the project.

Murrumbeena Info Hub

444 Neerim Rd, Murrumbeena

Monday and Wednesday:
9.00am to 5.00pm

Thursday:
9.00am to 12noon and
3.00pm to 7.00pm

Saturday:
9.00am to 1.00pm



CAULFIELD TO DANDENONG

See the elevated rail in construction

See Australia's first straddle carrier to be operational in a rail corridor. Learn more about the project at our info hub, and enjoy some local hospitality on the way!

 **SIGN UP FOR PROJECT UPDATES**
levelcrossings.vic.gov.au

@ contact@levelcrossings.vic.gov.au
☎ 1800 762 667
🌐 levelcrossings.vic.gov.au



Translation service
For languages other than English, please call 9280 0780.

Please contact us if you would like this information in an accessible format.



murrumbeenavillage.com.au



Authorised and published by the Victorian Government, 1 Treasury Place, Melbourne



Our vision

New stations

Carnegie and Murrumbeena stations will be rebuilt in their current locations, and Hughesdale station will be rebuilt in a new location west of Poath Road. The new elevated railway stations have been designed with safety and convenience in mind, and offer many new features.

Open spaces

The project will create 22.5 hectares of community open space, transforming an ugly rail corridor into one of the biggest parks Melbourne has seen.



Murrumbeena forecourt

What can I see?

Gantry cranes

Two 30 metre high gantry cranes at the Murrumbeena Station assembly area assemble concrete segments into spans, which form the elevated rail deck. The cranes move back and forth within the assembly area and lift the spans onto the rail deck.

Straddle carrier

The straddle carrier is controlled by two specialist operators who are located at the front and rear of the carrier. The straddle carrier collects the span from the Murrumbeena Station assembly area and transports it along the elevated rail deck to the required location.

View an animation on the how the equipment works together to build the elevated rail:
levelcrossings.vic.gov.au/crossings/caulfield-to-dandenong

Support beams

There are two 94 metre long support beams on top of the rail deck, that progressively move along the corridor as the elevated rail deck is built. They are used to temporarily support the straddle carrier as the span is lowered into place.

Assembly area

The assembly area is next to Murrumbeena Station and is where the spans are formed by tensioning 8-14 concrete segments together. When it is not operational, the straddle carrier is housed at the assembly area.

High level view

Iron Henry cafe in Murrumbeena has a first floor balcony that offers a great place to view the works from.

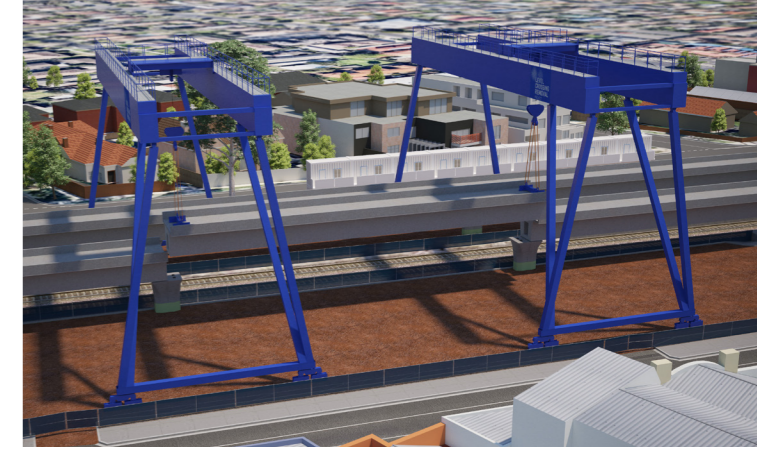

Gantry cranes

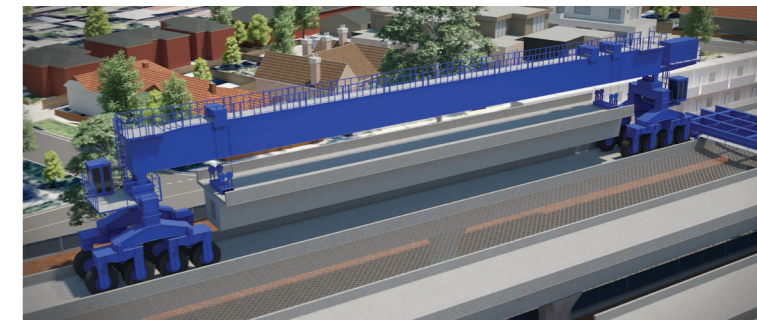

Straddle carrier

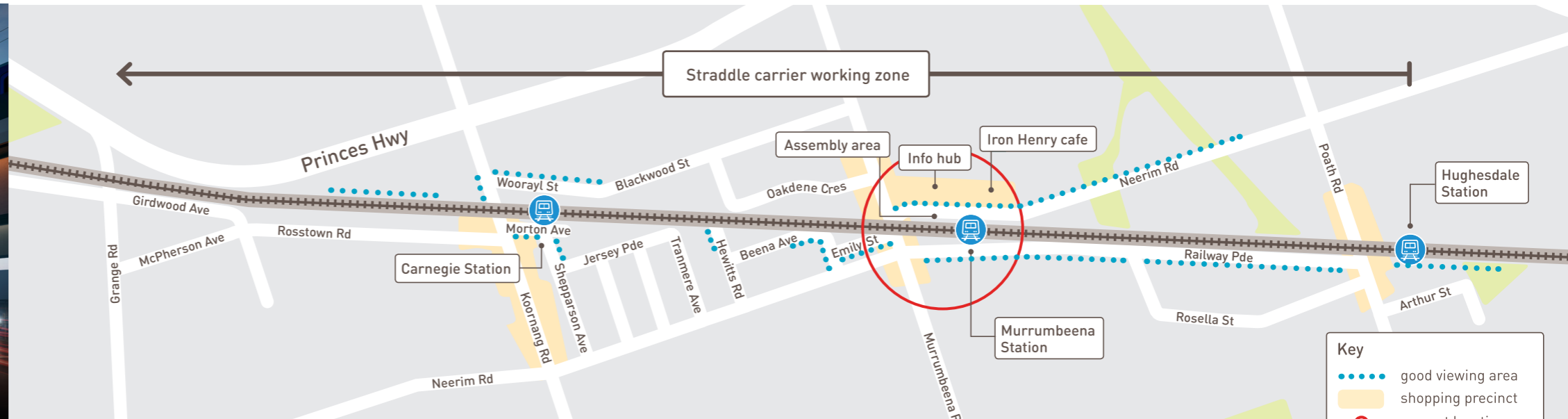

Straddle carrier and gantry crane viewing map

Key

- good viewing area
- Shopping precinct
- current location of straddle carrier