

# Pakenham's a hoot! Say hello to your new artwork

**Meet me at the  
Pakenham Owl  
developed by  
James and Eleanor  
Avery is the newest  
addition to the  
Pakenham community.**

Standing 3.2 metres tall and 2.7 metres wide, the artwork will become an iconic addition to Pakenham Station. Nesting in the northern section of the station precinct near Main Street, the owl will be a dynamic meeting point for locals and visitors.

Meet me at the Pakenham Owl is a contemporary sculpture referencing the Greater Sooty Owl, a species known to frequent the local area. The architectural features of the new Pakenham Station such as the V-shaped staircase, bronze finish, and curved roof inspired the sculpture's shape and colour.

The owl is fabricated from laser-cut aluminium and will be securely set in concrete.

Following installation in spring, the new Pakenham Owl will be right at home with the other beloved local creature, the Yakkerboo, which sits just down the road in Main Street.

**You'll be able to  
say Meet me at  
the Pakenham Owl  
to friends and family!**

## Meet the artists

Having previously worked with the Level Crossing Removal Project on the Bonbeach Station project, James and Eleanor are no strangers to creating artworks that connect to the community and the native creatures that reside within.

*"We chose an Owl because of the protected Greater Sooty Owl local to the Cardinia shire, and because of the symbolism attached to an owl as a spiritual guide, a widespread traveller, always returning to its nesting spot."* – **Eleanor Avery**

To see more of James and Eleanor Avery's artwork, visit [jamesandeleonoravery.com](http://jamesandeleonoravery.com)

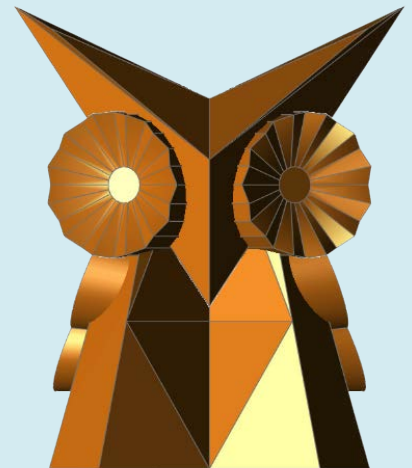

**Meet me at the Pakenham Owl in the Pakenham Station precinct near Main Street. Artist impression, subject to change.**

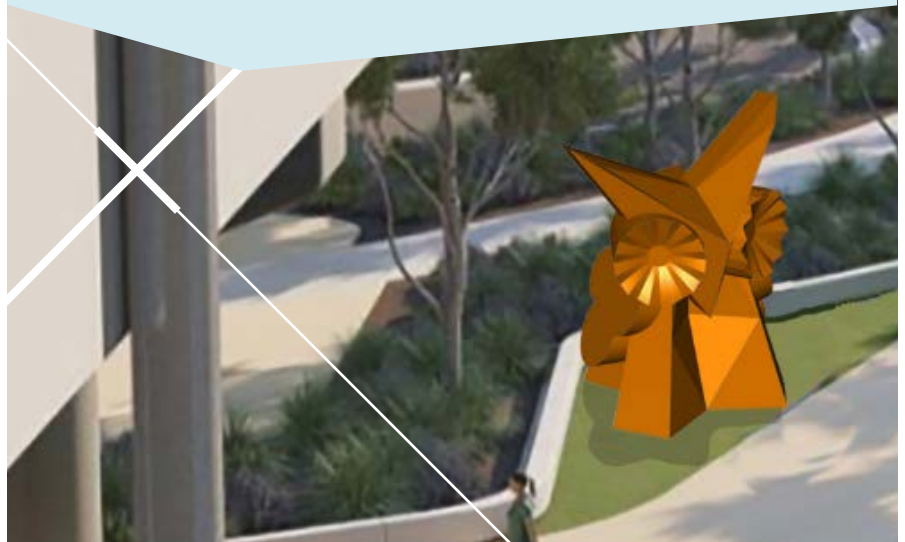

[levelcrossings.vic.gov.au](http://levelcrossings.vic.gov.au)

1800 105 105 (call anytime)

[contact@levelcrossings.vic.gov.au](mailto:contact@levelcrossings.vic.gov.au)



For languages other than English, please call 9209 0147.



Please contact us if you would like this information in an accessible format. If you need assistance due to a hearing or speech impairment, visit [relayservice.gov.au](http://relayservice.gov.au)

