

# Upcoming works

## Bulleen, Balwyn North, Doncaster, Mont Albert North

March / April 2026

Works are progressing along the Eastern Freeway with new flyover ramps forming in Bulleen and the second half of the Doncaster Road bridge underway.

After a successful weekend closure of the citybound freeway lanes in early February, we've now shifted traffic to establish a major worksite

in the middle of the freeway between Doncaster and Bulleen roads.

We've now lifted more than 30 of 188 steel beams that will form the elevated ramps connecting the Eastern Freeway to the North East Link tunnels.

We're continuing to build noise walls in 2026, with some completed panels now up between Estelle Street bridge and Elgar Road, south of the freeway.

**BIG BUILD**  
**EASTERN FREEWAY**

### We're here to help

We understand that construction in your local area can be challenging.

Call **1800 105 105** anytime or visit the Project Information Centre at **284 Doncaster Road, Balwyn North**, Tuesday to Thursday, 9am to 3pm.



### When we are working

- Day works**  
7am to 6pm from Monday to Friday and 7am to 3pm Saturdays and Sundays
- Night works**  
6pm to 7am from Monday to Saturday 3pm to 6am Saturdays and Sundays
- Day / night works** - at times during day and night works hours
- 24-hour works (at times)**  
Notification provided before works

### Upcoming disruptions in Bulleen

We'll close the Eastern Freeway in both directions between Bulleen and Doncaster roads from 10pm, Friday 27 March to 5am, Monday 30 March.

We'll also close sections of the Eastern Freeway overnight in March and April as we continue to build the new interchange at Bulleen Road.

As part of construction of the Manningham Road interchange, there'll be lane and road closures on Bulleen Road between Bridge and Avon streets for up to two weeks in April to complete critical drainage works.

To stay up to date visit [northeastlink.vic.gov.au](http://northeastlink.vic.gov.au)

We use water carts and noise mitigation measures wherever possible to reduce dust and noise while we work.

We'll be in touch with impacted residents regarding specific times for construction activities and to offer support.

[contact@bigbuild.vic.gov.au](mailto:contact@bigbuild.vic.gov.au)

Schedule is subject to change. Visit [bigbuild.vic.gov.au/roads](http://bigbuild.vic.gov.au/roads) for changes.

Please contact us if you would like this information in an accessible format. If you need assistance due to a hearing or speech impairment, visit [relayservice.gov.au](http://relayservice.gov.au)

For languages other than English please call 9209 0147

如需获取英语以外的其它语言的协助, 请致电9209 0147。

Για γλώσσες εκτός της αγγλικής Καλέστε το 9209 0147

Per lingue diverse dall'inglese Chiamare il numero 9209 0147



# Zone 1: Burke to Bulleen roads and Bulleen Road interchange

## Ongoing and existing works



- |                          |                          |                      |                                 |
|--------------------------|--------------------------|----------------------|---------------------------------|
| Earthworks               | Concrete foundation      | Oversize deliveries  | Lighting and on-road technology |
| Piling / foundation work | Bridge beam installation | Utility works        | Day works                       |
| Demolition               | Noise wall construction  | Drainage works       | Night works                     |
| Site investigations      | Roadworks                | Traffic signal works | Day / night works               |

## New works starting March / April 2026

| Where   | Activity  | What to expect   |
|---|---|--|
| <b>1</b><br>Bulleen Road between Carey Bulleen Sports Complex and Leonis Avenue | <ul style="list-style-type: none"> <li> Piling in freeway centre median and next to Koonung Creek.</li> <li> Delivery and installation of concrete and steel beams.</li> <li>Tree clearing, earthworks and drainage.</li> <li> Bridge strengthening works on Bulleen Road bridge.</li> </ul>  | <ul style="list-style-type: none"> <li>- Overnight lane and ramp closures</li> <li>- Pedestrian and shared path detours</li> <li>- Medium to low night time levels of noise, dust and vibration</li> <li>- Use of directional lighting</li> <li>- Delivery of heavy machinery and vehicles</li> </ul>                                    |
| <b>2</b><br>Thompsons Road  | <ul style="list-style-type: none"> <li> Asphaltting, line marking and removal of traffic islands.</li> <li>Earthworks and drainage.</li> </ul>  | <ul style="list-style-type: none"> <li>- Overnight lane and ramp closures</li> <li>- Use of directional lighting</li> </ul>  |
| <b>3</b><br>Bulleen Road citybound entry and exit ramps                         | <ul style="list-style-type: none"> <li> Piling works to build retaining and noise walls, underpass connections and bridge foundations.</li> <li>Drainage, asphaltting, permanent barrier construction and line marking.</li> <li>Traffic signal and drainage relocation works near Bulleen Road citybound entry ramp.</li> <li>Switching traffic onto temporary citybound exit ramp.</li> <li> Installation of cabling for new on-road technology.</li> </ul> | <ul style="list-style-type: none"> <li>- Overnight lane and ramp closures</li> <li>- Medium to low night time levels of noise, dust and vibration</li> <li>- Heavy machinery and vehicles</li> <li>- Traffic controllers and signage</li> <li>- Increase in heavy vehicles and machinery accessing site via Highview Road</li> </ul>     |
| <b>4</b><br>Between Burke and Bulleen roads                                     | <ul style="list-style-type: none"> <li> Piling works to build retaining wall and noise walls.</li> <li> Drainage works under freeway.</li> <li>Installation of cabling for new on-road technology.</li> <li> Asphaltting, earthworks, barrier realignment and line marking.</li> <li>Installation of noise wall panels along freeway citybound.</li> </ul>  | <ul style="list-style-type: none"> <li>- Overnight freeway, ramp and lane closures</li> <li>- Traffic and shared path changes between Musca Reserve and Columba Street</li> <li>- Medium to low night time levels of noise, dust and vibration</li> <li>- Use of directional lighting</li> <li>- Heavy machinery and vehicles</li> </ul> |

# Zone 2: Bulleen to Doncaster roads and Koonung Creek Reserve

## Ongoing and existing works



- |                          |                     |                                 |                   |
|--------------------------|---------------------|---------------------------------|-------------------|
| Earthworks               | Concrete foundation | Utility works                   | Day works         |
| Piling / foundation work | Roadworks           | Drainage works                  | Night works       |
| Noise wall construction  | Oversize deliveries | Lighting and on-road technology | Day / night works |
| Site investigations      |                     |                                 | 24-hour works     |

## New works starting March / April 2026

| Where  | Activity   | What to expect  |
|--|--|---|
| <b>1</b><br>Between Bulleen and Doncaster roads, Koonung Creek Reserve | <ul style="list-style-type: none"> <li>Construction of sewer shafts and pipe installation on Estelle Street.</li> <li>Construction of ramp at Bulleen Park and Ride.</li> <li>Construction of retaining wall at Kampman Street.</li> <li>Earthworks and installation of underground supports to build retaining wall at Estelle Street.</li> <li>Piling to build retaining wall at Park Avenue.</li> <li>Concrete barrier installation near the Ringwood-bound exit ramp.</li> <li>Piling for Ringwood-bound freeway retaining walls.</li> <li>Finishing works on Estelle Street bridge.</li> <li>Earthworks and removal of concrete pipes as part of sewer works.</li> <li>Concrete and steel fixing works for new freeway ramps and barriers.</li> <li>Installation of cabling for new on-road technology under freeway.</li> <li>Site and freeway investigations, asphaltting, barrier realignment and line marking.</li> <li>Installation of noise wall panels along freeway citybound.</li> </ul> | <ul style="list-style-type: none"> <li>Partial closure of Estelle Street, with detours in place</li> <li>Medium to low night time levels of noise, dust and vibration</li> <li>Use of directional lighting</li> <li>24/7 operation of pump system at Willow Bend and Park Avenue</li> <li>Access and use of Koonung Creek Reserve worksite day and night</li> <li>Overnight citybound freeway closures</li> </ul> |
| <b>2</b><br>Doncaster Road interchange                                 | <ul style="list-style-type: none"> <li>Piling works for new overhead signage and structures.</li> <li>Relocating, decommissioning and installing utilities.</li> <li>Foundation and piling works for new express busway underpass.</li> <li>Earthworks, drainage, pavement and retaining wall works.</li> <li>Foundation and piling works for Ringwood side of new Doncaster Road bridge.</li> <li>Installation of footings near High Street for Sentinel statue.</li> <li>Piling for shared path underpass.</li> <li>Concrete formwork and pours for overhead signage near Ringwood-bound exit ramp.</li> <li>Earthworks near Doncaster Road citybound entry ramp.</li> </ul>   | <ul style="list-style-type: none"> <li>Overnight lane and ramp closures</li> <li>Pedestrian and shared path detours</li> <li>Medium to low night time levels of noise, dust and vibration</li> <li>Use of directional lighting</li> <li>Heavy machinery and vehicles</li> <li>Traffic controllers and signage</li> </ul>  |

# Zone 3: Doncaster to Tram roads and Valda Wetlands

## Ongoing and existing works

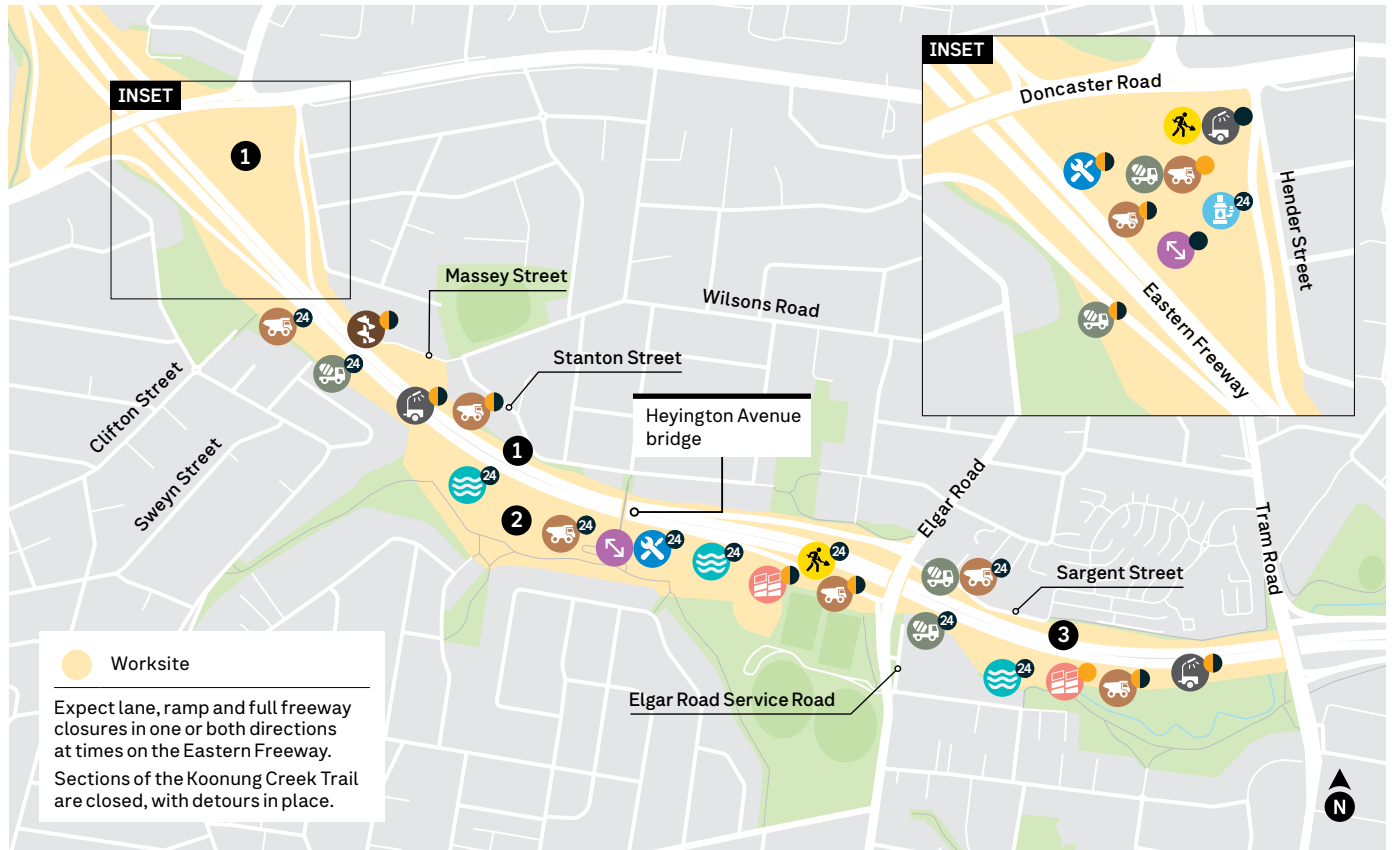

- 🚧 Earthworks
- 🚧 Roadworks
- 🌊 Creek bypass pumping
- 🟡 Day works
- 🚧 Piling / foundation work
- 🚧 Oversize deliveries
- 🚰 Pumping operation
- 🌑 Night works
- 🚧 Noise wall construction
- 🚧 Utility works
- 🚰 Lighting and on-road technology
- 🟡 Day / night works
- 🏠 Concrete foundation
- 🕒 24-hour works

## New works starting March / April 2026

| Where  | Activity  | What to expect   |
|--|---|--|
| <b>1</b><br>Between Doncaster and Elgar roads, Doncaster Park and Ride | <ul style="list-style-type: none"> <li>🟡 Construction of hardstand near Massey Street.</li> <li>🟡 Piling, concreting, steel works, earthworks, and installation of underground supports and concrete safety barriers to build retaining walls.</li> <li>Installation of concrete structures to protect creek.</li> <li>Concrete foundations to build new Doncaster Park and Ride.</li> <li>Installation of cabling for new on-road technology.</li> <li>Installation of water pipes and hydrant mains.</li> <li>Construction of retaining and noise walls.</li> <li>🟡 Earthworks and installation of traffic barriers.</li> <li>Remove and install asphalt for new freeway lanes.</li> <li>🕒 Concrete and steel fixing works to build new traffic safety barriers.</li> </ul> | <ul style="list-style-type: none"> <li>- Overnight lane and ramp closures</li> <li>- Medium night time levels of noise, dust and vibration</li> <li>- Heavy vehicles and machinery accessing site via Wilsons Road and Stanton Street</li> <li>- Traffic controllers and signage</li> <li>- Access to Doncaster Park and Ride site day and night</li> <li>- Overnight machinery and material deliveries via freeway</li> </ul> |
| <b>2</b><br>Valda Wetlands   | <ul style="list-style-type: none"> <li>🟡 Earthworks, and installation of traffic barriers.</li> <li>Installation of cabling for new on-road technology.</li> <li>🕒 Barrier realignment near Elgar Road citybound entry ramp.</li> <li>Installation of drainage under freeway.</li> <li>Installation of stairs, seats, lighting and handrails, painting and finishes on the Heyington Avenue bridge.</li> <li>Piling, concreting and steel works to support installation of retaining walls, noise walls and concrete structures.</li> </ul>   | <ul style="list-style-type: none"> <li>- Overnight freeway, lane and ramp closures</li> <li>- Shared path detours</li> <li>- Medium to low night time levels of noise, dust and vibration</li> <li>- Heavy vehicles and machinery accessing site via Clifton and Sweyn streets</li> <li>- Overnight machinery and material deliveries via freeway</li> </ul>   |
| <b>3</b><br>Between Elgar and Tram roads                               | <ul style="list-style-type: none"> <li>🟡 Remove base of existing noise wall along Sargent Street.</li> <li>🟡 Installation of cabling for new on-road technology.</li> <li>Installation of water pipes and hydrant mains.</li> <li>Installation of drainage at Sargent Street.</li> <li>🕒 Installation of concrete structures.</li> <li>Installation of underground supports, piling, concreting, steel works and earthworks.</li> <li>Construction of retaining and noise walls.</li> </ul>   | <ul style="list-style-type: none"> <li>- Medium to high night time levels of noise, dust and vibration</li> <li>- Heavy vehicles and machinery entering via Elgar Road Service Road and exiting via Doncaster Road citybound exit ramp</li> </ul>  |