

# Upcoming works

## Bulleen, Balwyn North, Doncaster, Mont Albert North

April / May 2026

Construction continues across multiple worksites along the Eastern Freeway. In late March, crews carried out one of the largest crane lifts ever done on an Australian project, installing over 1000 tonnes of structural beams at the Bulleen Road interchange. Crews are preparing to lift more beams over the freeway to form the new elevated ramps that will connect to the North East Link tunnels.

In Doncaster, the Ringwood side of the new Doncaster Road bridge is taking shape, with concrete works underway

to form the bridge walls on the sides of the freeway. Work on the busway underpass is also progressing well.

We'll close the Elgar Road citybound entry ramp for six weeks from the end of April to widen the freeway in this area and realign the ramp into its final position.

Noise walls between Burke and Bulleen roads on the southern side of the freeway are underway, with the supporting posts and some panels now visible from the freeway.

**BIG BUILD**  
**EASTERN FREEWAY**

### We're here to help

We understand that construction in your local area can be challenging.

Call **1800 105 105** anytime or visit the **Project Information Centre** at:

284 Doncaster Road, Balwyn North  
Tuesday to Thursday  
9am to 12 midday and 1pm to 3pm.



### When we are working

- Day works**  
7am to 6pm from Monday to Friday and 7am to 3pm Saturdays and Sundays
- Night works**  
6pm to 7am from Monday to Saturday 3pm to 6am Saturdays and Sundays
- Day / night works** - at times during day and night works hours
- 24-hour works (at times)**  
Notification provided before works

### Upcoming disruptions in Bulleen

As part of construction of the future Manningham Road interchange, there'll be lane and road closures on Bulleen Road, between Bridge Street and Manningham Road, from Thursday 9 April to Monday 20 April.

**Delays of up to 15 minutes are expected.**

To stay up to date visit [northeastlink.vic.gov.au](http://northeastlink.vic.gov.au)

We use water carts and noise mitigation measures wherever possible to reduce dust and noise while we work.

We'll be in touch with impacted residents regarding specific times for construction activities and to offer support.

[contact@bigbuild.vic.gov.au](mailto:contact@bigbuild.vic.gov.au)



Schedule is subject to change. Visit [bigbuild.vic.gov.au/roads](http://bigbuild.vic.gov.au/roads) for changes.

Please contact us if you would like this information in an accessible format. If you need assistance due to a hearing or speech impairment, visit [relayservice.gov.au](http://relayservice.gov.au)



For languages other than English please call 9209 0147

如需获取英语以外的其它语言的协助, 请致电9209 0147。

Για γλώσσες εκτός της αγγλικής Καλέστε το 9209 0147

Per lingue diverse dall'inglese Chiamare il numero 9209 0147



# Zone 1: Burke to Bulleen roads and Bulleen Road interchange

## Ongoing and existing works



- |                          |                          |                      |                                 |
|--------------------------|--------------------------|----------------------|---------------------------------|
| Earthworks               | Concrete foundation      | Oversize deliveries  | Lighting and on-road technology |
| Piling / foundation work | Bridge beam installation | Utility works        | Day works                       |
| Creek bypass pumping     | Noise wall construction  | Drainage works       | Night works                     |
| Site investigations      | Roadworks                | Traffic signal works | Day / night works               |

## New works starting April / May 2026

Where	Activity	What to expect
<b>1</b> Bulleen Road between Carey Bulleen Sports Complex and Leonis Avenue	<ul style="list-style-type: none"> <li> Piling in freeway centre median and next to Koonung Creek.</li> <li> Earthworks for underpass construction.</li> <li> Delivery and installation of concrete and steel beams.</li> <li> Tree clearing, earthworks and drainage.</li> <li> Bridge strengthening and widening works on Bulleen Road bridge, including bridge concrete works.</li> </ul>	<ul style="list-style-type: none"> <li>– Overnight lane and ramp closures</li> <li>– Pedestrian and shared path detours</li> <li>– Medium to low levels of noise, dust and vibration</li> <li>– Use of directional lighting</li> <li>– Delivery of heavy machinery and vehicles</li> </ul>
<b>2</b> Thompsons Road	<ul style="list-style-type: none"> <li> Asphalting, traffic signal works, line marking and removal of traffic islands.</li> <li> Earthworks and drainage.</li> <li> Asphalt investigation works on Ringwood-bound exit ramp.</li> <li> Installation of steel beams over Thompsons Road.</li> </ul>	<ul style="list-style-type: none"> <li>– Overnight lane and ramp closures</li> <li>– Use of directional lighting</li> <li>– Medium to low night time levels of noise, dust and vibration</li> </ul>
<b>3</b> Bulleen Road citybound entry and exit ramps	<ul style="list-style-type: none"> <li> Piling works to build foundations for elevated ramps.</li> <li> Switching traffic onto permanent citybound entry ramp.</li> <li> Noise wall demolition.</li> <li> Installation of cabling for new on-road technology.</li> <li> Traffic signal and drainage relocation works near citybound entry ramp.</li> <li> Installation of steel beams and traffic barriers.</li> </ul>	<ul style="list-style-type: none"> <li>– Overnight lane and ramp closures</li> <li>– Medium to low night time levels of noise, dust and vibration</li> <li>– Heavy machinery and vehicles</li> <li>– Traffic controllers and signage</li> <li>– Increase in heavy vehicles and machinery accessing worksite via Highview Road</li> </ul>
<b>4</b> Between Burke and Bulleen roads	<ul style="list-style-type: none"> <li> Drainage works under freeway.</li> <li> Excavation, steel fixing and concrete pours.</li> <li> Installation of cabling for new on-road technology.</li> <li> Earthworks and landscaping.</li> <li> Construction of retaining walls.</li> <li> Installation of noise wall panels along freeway citybound.</li> <li> Asphalting, barrier realignment and line marking.</li> </ul>	<ul style="list-style-type: none"> <li>– Overnight ramp and lane closures</li> <li>– Traffic and shared path changes between Musca Reserve and Columba Street</li> <li>– Medium to low levels of noise, dust and vibration</li> <li>– Use of directional lighting</li> <li>– Heavy machinery and vehicles</li> </ul>

# Zone 2: Bulleen to Doncaster roads and Koonung Creek Reserve

## Ongoing and existing works



## New works starting April / May 2026

Where	Activity	What to expect
<b>1</b> Between Bulleen and Doncaster roads, Koonung Creek Reserve	<ul style="list-style-type: none"> <li>Construction of ramp at Bulleen Park and Ride.</li> <li>Earthworks and installation of underground supports to build retaining wall at Estelle Street.</li> <li>Piling to build retaining wall at Park Avenue.</li> <li>Installing concrete barriers within worksites near Doncaster Road entry and exit ramps.</li> <li>Installation of noise wall panels along freeway citybound.</li> <li>Finishing works on Estelle Street bridge.</li> <li>Concrete and steel fixing works for new freeway ramps and barriers.</li> <li>Retaining wall construction and drainage works within centre median.</li> <li>Asphalting and pavement works on freeway near Doncaster Road interchange.</li> <li>Earthworks and landscaping.</li> <li>Installation of cabling for new on-road technology under freeway.</li> <li>Site and freeway investigations, asphalting, barrier realignment and line marking.</li> </ul>	<ul style="list-style-type: none"> <li>Partial closure of Estelle Street, with detours in place</li> <li>Medium to low levels of noise, dust and vibration</li> <li>Use of directional lighting</li> <li>24/7 operation of pump system at Willow Bend and Park Avenue</li> <li>Access and use of Koonung Creek Reserve worksite day and night</li> <li>Overnight freeway, ramp and lane closures</li> </ul>
<b>2</b> Doncaster Road interchange	<ul style="list-style-type: none"> <li>Installing drainage and utilities.</li> <li>Foundation and piling works for express busway, shared path overpass and Ringwood side of new Doncaster Road bridge.</li> <li>Earthworks, drainage, pavement and retaining wall works.</li> <li>Demolishing old bridge elements.</li> <li>Concrete formwork and pours.</li> </ul>	<ul style="list-style-type: none"> <li>Overnight lane and ramp closures</li> <li>Pedestrian and shared path detours</li> <li>Medium to low levels of noise, dust and vibration</li> <li>Use of directional lighting</li> <li>Heavy machinery and vehicles</li> <li>Traffic controllers and signage</li> </ul>

# Zone 3: Doncaster to Tram roads and Valda Wetlands

## Ongoing and existing works

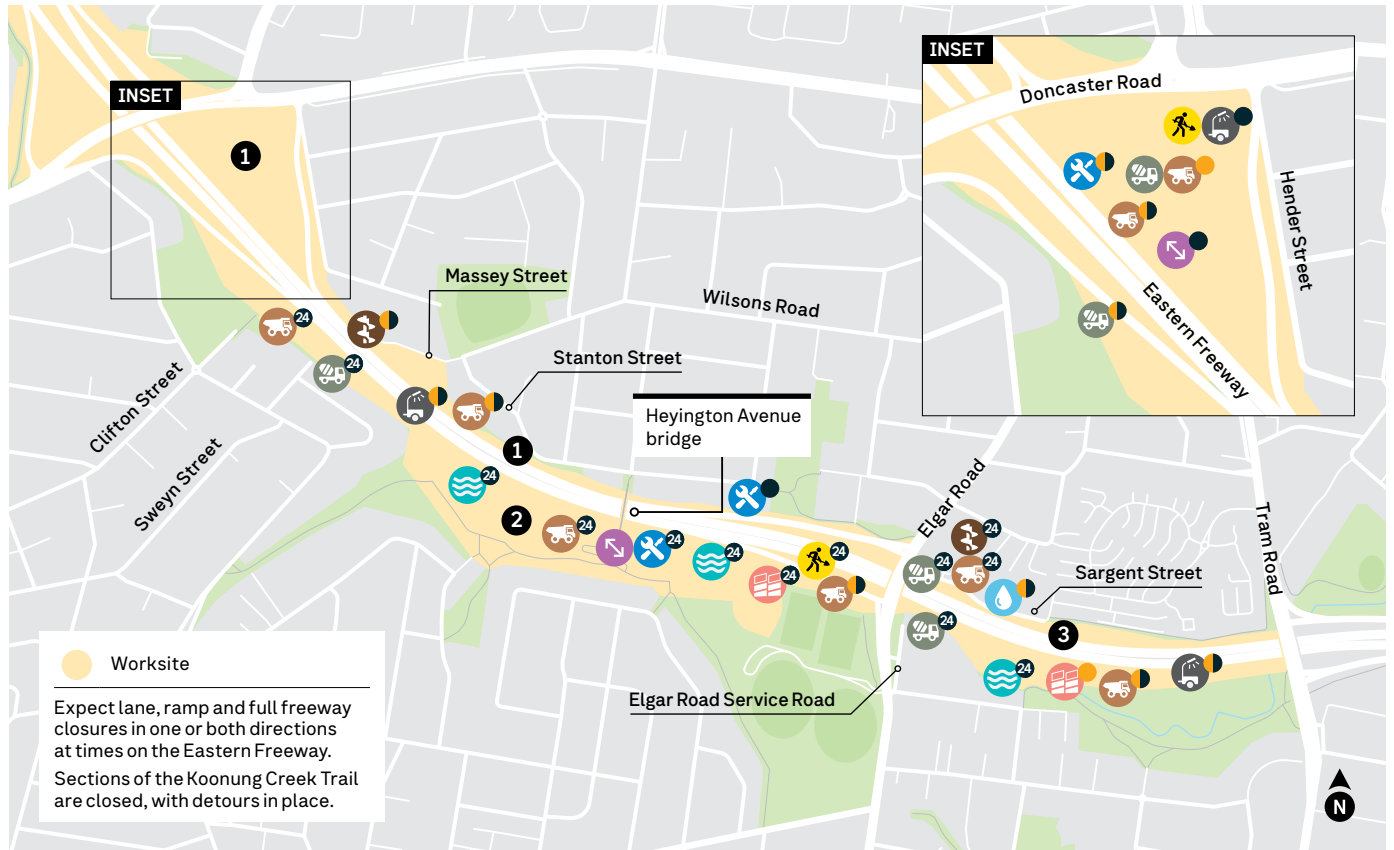

- Earthworks
- Roadworks
- Drainage works
- Day works
- Piling / foundation work
- Oversize deliveries
- Creek bypass pumping
- Night works
- Noise wall construction
- Utility works
- Lighting and on-road technology
- Day / night works
- Concrete foundation
- 24-hour works

## New works starting April / May 2026

Where	Activity	What to expect
<b>1</b> Between Doncaster and Elgar roads, Doncaster Park and Ride	<ul style="list-style-type: none"> <li> Construction of hardstand near Massey Street.</li> <li> Installation of water pipes and hydrant mains.</li> <li> Construction of access roads for large vehicles and heavy machinery within our worksite.</li> <li> Earthworks and installation of traffic barriers.</li> <li> Remove and install asphalt for new freeway lanes.</li> <li> Concrete and steel fixing works to build new traffic safety barriers.</li> <li> Piling and installation of retaining and noise walls.</li> </ul>	<ul style="list-style-type: none"> <li>- Overnight lane and ramp closures</li> <li>- Medium levels of noise, dust and vibration</li> <li>- Heavy vehicles and machinery accessing worksite via Wilsons Road and Stanton Street</li> <li>- Traffic controllers and signage</li> <li>- Access to Doncaster Park and Ride worksite day and night</li> <li>- Overnight machinery and material deliveries via freeway</li> </ul>
<b>2</b> Valda Wetlands	<ul style="list-style-type: none"> <li> Concrete and steel works for retaining and noise walls and concrete structures.</li> <li> Piling for retaining and noise walls and concrete structures.</li> <li> Earthworks, and installation of traffic barriers.</li> <li> Installation of cabling for new on-road technology.</li> <li> Barrier realignment near Elgar Road citybound entry ramp.</li> <li> Installation of drainage under freeway.</li> <li> Finishing works for Heyington Avenue bridge.</li> <li> Earthworks to realign Koonung Creek.</li> </ul>	<ul style="list-style-type: none"> <li>- Overnight freeway, lane and ramp closures</li> <li>- Shared path detours</li> <li>- Medium to low levels of noise, dust and vibration</li> <li>- Heavy vehicles and machinery accessing worksite via Clifton and Sweyn streets</li> <li>- Overnight machinery and material deliveries via freeway</li> </ul>
<b>3</b> Between Elgar and Tram roads	<ul style="list-style-type: none"> <li> Earthworks and landscaping.</li> <li> Remove base of existing noise wall along Sargent Street.</li> <li> Piling for retaining and noise walls.</li> <li> Installation of new noise wall acrylic panels.</li> <li> Installation of cabling for new on-road technology.</li> <li> Installation of water pipes and hydrant mains.</li> <li> Installation of concrete structures, underground supports, piling, concreting, steel works and earthworks.</li> <li> Construction of retaining and noise walls.</li> </ul>	<ul style="list-style-type: none"> <li>- Medium to high levels of noise, dust and vibration</li> <li>- Heavy vehicles and machinery entering via Elgar Road Service Road and exiting via Doncaster Road citybound exit ramp</li> <li>- Overnight and weekend freeway, lane and ramp closures</li> </ul>