

## Transforming road and rail travel

More than \$18 billion is being invested into major road and rail projects in Melbourne's north and north east as part of Victoria's Big Build.

These projects will reduce congestion, cut travel times and provide more trains more often making getting to work, school and health services quicker and easier.



North East Link interchange at Lower Plenty Road, Yallambie (concept image)

## Building Victoria's longest ever tunnels

North East Link is more than just Victoria's biggest road project, it will change the way people move around Melbourne by bringing our road, bus and bike network together.

Last month we released the winning design for the project, with the tunnels extended by 1.9 kilometres in response to community feedback.

Twin six-and-a-half kilometre tunnels will be the longest ever built in Victoria, creating more space for parklands and wetlands above.

The Ring Road and Eastern Freeway will be improved with extra lanes and smart on-road technology, connecting seamlessly with North East Link.

Getting to and from the city on public transport will be quicker and easier on the Eastern Express Busway, with park and rides at Bulleen and Doncaster and a bus every minute in peak travel times.

More than 34 kilometres of new and upgraded walking and cycling paths will link the north east to Yarra River trails and parklands.

Before we start major construction, there will be an opportunity to comment on the detailed design in your local area – starting with the North East Link tunnels in 2022.



Up to 135,000 trips a day



18 traffic lights skipped from the Eastern Freeway to the Ring Road



35 minutes slashed between Melbourne's north and east



15,000 trucks off local roads a day



10,000 jobs for Victorians



Three new parklands and wetlands in Balwyn North, Bulleen and Yallambie



Find out more details about projects in your area by scanning the QR code or visiting [bigbuild.vic.gov.au/north](http://bigbuild.vic.gov.au/north)



Check out upcoming disruptions on the back



## More trains more often on the Hurstbridge Line

The Hurstbridge Line Duplication will deliver more trains, less crowding in peak times and better connections to public transport in Melbourne's north east.

As part of the upgrade, we're building new stations at Greensborough and Montmorency to improve safety and access.

The tracks will be doubled for about two kilometres between Greensborough and Montmorency and one-and-a-half kilometres between Diamond Creek and Wattle Glen.



Trains will run in the peak every:

- 7 mins From Greensborough
- 10 mins From Eltham and Montmorency
- 20 mins From Diamond Creek, Wattle Glen and Hurstbridge



View the new designs for Greensborough and Montmorency stations by scanning the QR code or visiting [bigbuild.vic.gov.au/hludesigns](http://bigbuild.vic.gov.au/hludesigns)



The new Greensborough Station (concept image)

## Keeping the north in the loop

Suburban Rail Loop (SRL) will connect every major rail line from Cheltenham to Werribee, making journeys to jobs, retail, education and health services quicker and more convenient.

Construction starts next year on SRL East from Cheltenham to Box Hill which is due to be complete by 2035.

Planning is also underway on SRL North from Box Hill to Melbourne Airport and SRL West from the airport to Werribee. SRL North will have stops at Doncaster, Heidelberg, Bundoora, Reservoir, Fawkner and Broadmeadows.

Broadmeadows Station will be transformed into a superhub, providing an interchange for V/Line services as well as a connection to the Craigieburn Line.

26 kms

SRL East: 26km of rail tunnels between Cheltenham and Box Hill

6 mins

Trains every six mins at peak times, increasing to about every two mins over time

22 mins

Travel time from Cheltenham to Box Hill



Find out more about the Suburban Rail Loop by scanning the QR code or visiting [bigbuild.vic.gov.au/srl](http://bigbuild.vic.gov.au/srl)

## Keon Park among ten extra level crossings to go by 2025

More level crossing removals have been added to our hit list, thanks to the entire program being well ahead of schedule.

An extra ten level crossing removals means we'll now remove 85 dangerous and congested level crossings in Victoria

A new elevated station is planned for Keon Parade at Keon Park to make it easier and safer to get to the station, as well as easing congestion on the Mernda Line.

We're also making steady progress on level crossing removals in Preston with beams and parts of the station being lifted into place.

More than 230 giant L-shaped beams will create the base for where we lay train tracks.

This will form part of the two-and-a-half kilometre rail bridge, spanning from Murray Road to Oakover Road, which will include new elevated stations at Preston and Bell.

The level crossings at Oakover Road, Bell Street, Cramer Street and Murray Road will be gone for good by the end of 2022.



15 level crossings to go in the north and north east

2022  
Glenroy Road, Glenroy  
Bell Street, Preston  
Cramer Street, Preston  
Murray Road, Preston  
Oakover Road, Preston

2025  
Keon Parade, Keon Park



Part of the new Preston Station platform being lifted into place



# Eastern Express Busway

11 kms

11km of dedicated bus lanes from Doncaster towards the city



New Bulleen park and ride and upgraded Doncaster park and ride



A bus every minute during the peak

100 km/h

100km/h travel speeds

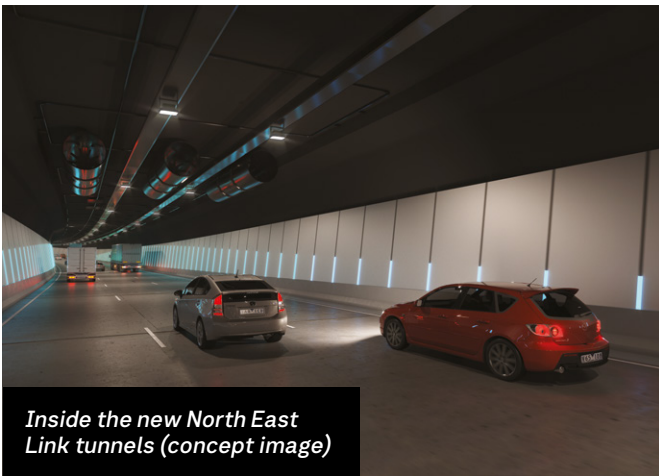

Inside the new North East Link tunnels (concept image)



Greensborough and Lower Plenty roads in Yallambie (concept image)



Sign up for email updates about projects in the north and north east by scanning the QR code or visiting [bigbuild.vic.gov.au/subscribe](https://bigbuild.vic.gov.au/subscribe)



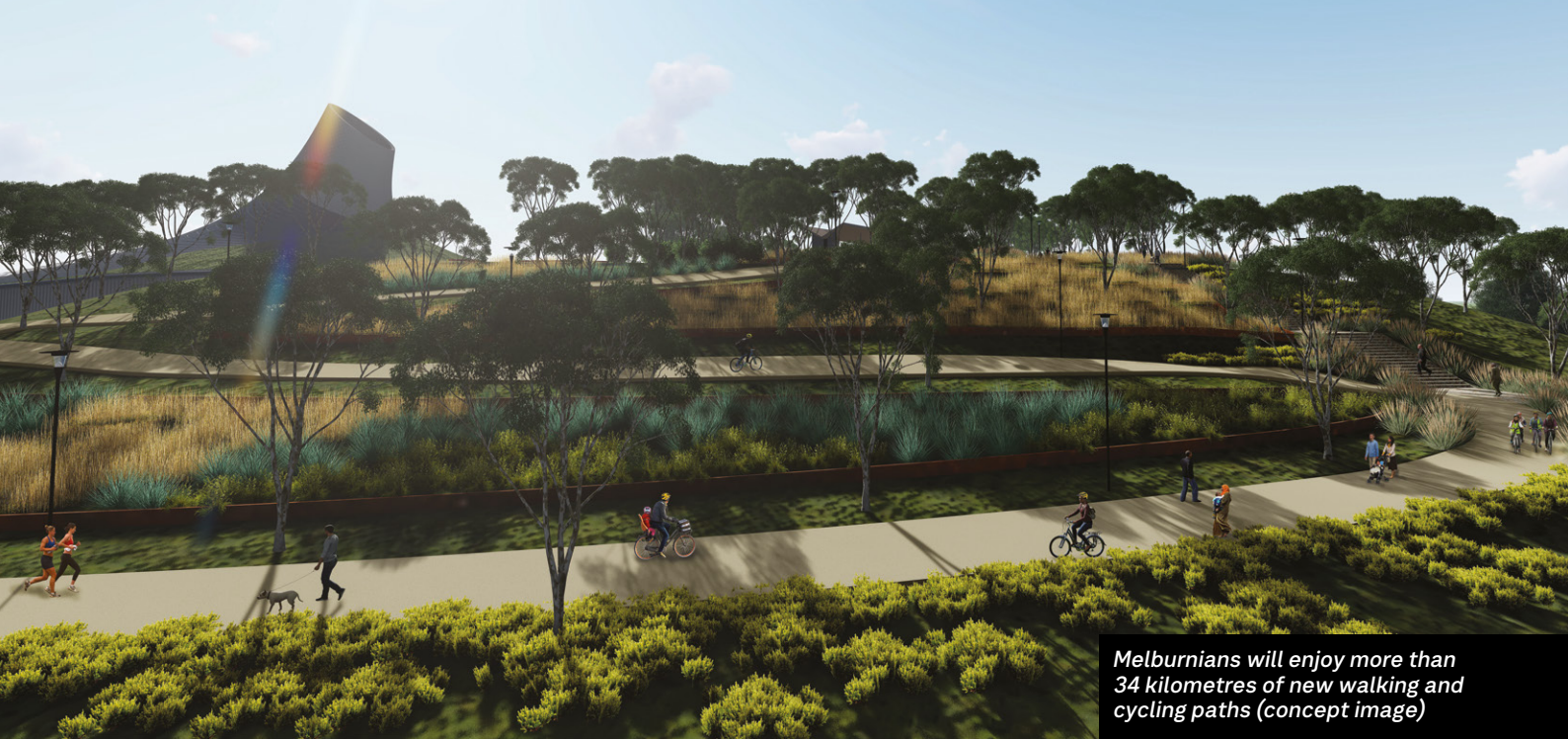

Melburnians will enjoy more than 34 kilometres of new walking and cycling paths (concept image)

## North East Link combines five major projects in one

Half a million Victorians live within two kilometres of a planned North East Link interchange, making it a great way to improve the way you move around Melbourne, whether by car, bus or bike.

### North East Trail



34km of new and upgraded walking and cycling paths in 16 suburbs



40 new and upgraded bridges and crossings



Eight main trails linked to create 100km of continuous trail around Melbourne

### Ring Road Completion



Five new lanes with up-to-date technology



Two green bridges at Elder Street and Watsonia Road



New multi-level parking at Watsonia Station

### North East Link Tunnels



6.5km tunnels with parklands and wetlands



Three simpler interchanges at Lower Plenty Road, Manningham Road and the Eastern Fwy

### Eastern Freeway Upgrades



45km+ of new and upgraded lanes where they're needed most



Six express lanes for faster, smoother trips between Middleborough Road and Chandler Highway

## Work continues on the M80 Ring Road

We're upgrading the M80 Ring Road from Laverton North to Greensborough, with work currently focused on the section between Sydney Road and Edgars Road.

We'll add new lanes, upgrade key interchanges, install a smart freeway management system and build new on and off ramps to provide safer and more reliable journeys for drivers in Melbourne's north.

Since the start of the year, we've upgraded the Blaxland Avenue walking and cycling overpass, started building new entry and exit ramps at Edgars Road and continued to build new lanes on the freeway.



Extra lanes will be added to the M80 Ring Road between Sydney Road and Edgars Road

## Fitzsimons Lane Upgrade to improve safety

Traffic flow and safety will improve for the 60,000 people who drive through an upgraded Fitzsimons Lane, one of the busiest main roads in Melbourne's north east.

With the limited number of crossing points, road users who want to cross the Yarra River are funnelled through the Fitzsimons Lane and Main Road intersection, creating congestion.

Construction is expected to be complete by 2023

The upgrade will be crucial for those who rely on the crossing to connect them safely to their homes, workplaces and schools.

Construction has been ramping up in recent months with the relocation of services along Porter Street near the Templestowe Reserve and northern end of Hawtin Street now complete.

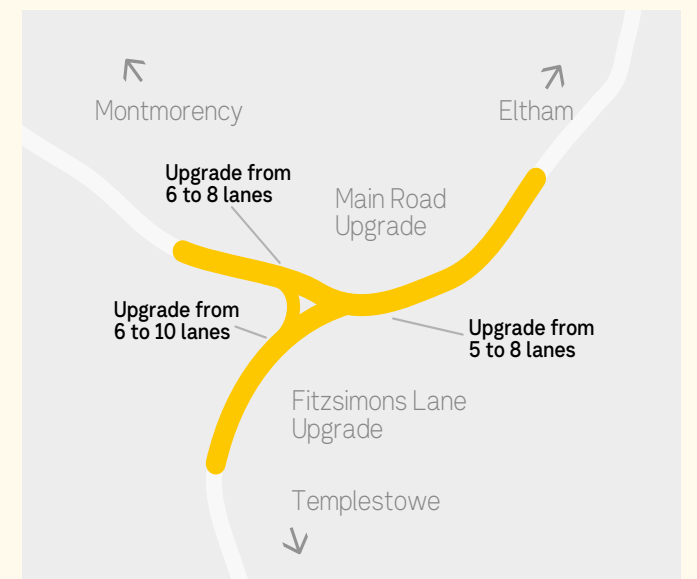

Scan here to read more about how we've refined the design of the Fitzsimons Lane Upgrade at [bigbuild.vic.gov.au/fitzsimons](https://bigbuild.vic.gov.au/fitzsimons)

## Did you know?

More than 30,000 trees will be planted for North East Link



Cycling 'superhighway' alongside the Eastern Express Busway (concept image)



Find out more details on North East Link by scanning the QR code or visiting [bigbuild.vic.gov.au/northeastlink](https://bigbuild.vic.gov.au/northeastlink)





## Upcoming disruptions

We're working hard to build a better transport network. While we work, road and public transport disruptions could affect your travel.

### Getting ready for major construction on North East Link

Lane closures on Bulleen Road and the Eastern Freeway will be ongoing at various times during summer as we continue to relocate utility services.

### Fitzsimons Lane upcoming closures

Lanes will be closed as required at the Fitzsimons Lane and Main Road intersection, Porter Street junction and on Williamsons Road at Foote Street.

### M80 Ring Road

There will be ongoing lane and ramp closures on the M80 Ring Road at Edgars Road and overnight closures of the freeway between Sydney Road and Edgars Road throughout summer.

### Local roads and lanes closed in your area

Be prepared for reduced speed limits on Childs Road and Craigieburn Road as we continue upgrade works, as well as during finishing works for the Plenty Road and O'Herns Road upgrades.

### Works on the Hurstbridge and Mernda lines

At times during December and January buses will replace trains as we work to remove level crossings on the Mernda Line and duplicate sections of the Hurstbridge Line.

### Melbourne's freeway network

Over summer, there'll be major road works on the West Gate Bridge, West Gate Freeway, Monash Freeway and Princes Freeway. We'll be closing key sections of the freeway network for road maintenance and resurfacing, as well as building new lanes and ramps.



Find out more about disruptions in Melbourne's north and north east by scanning the QR code or visiting [bigbuild.vic.gov.au/disruptions](http://bigbuild.vic.gov.au/disruptions)



## Add disruptions directly to your calendar and you'll always be up to date

1. Visit [bigbuild.vic.gov.au/calendar](http://bigbuild.vic.gov.au/calendar)
2. Select your train line
3. Click Subscribe to calendar
4. Select your calendar type

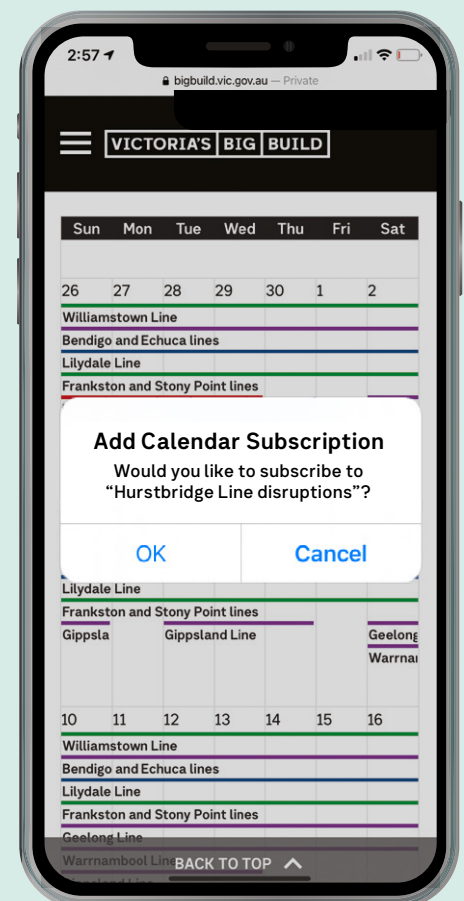

Find out how we're building big in the north and north east at [bigbuild.vic.gov.au/north](http://bigbuild.vic.gov.au/north) or call **1800 105 105** any time.

If you're deaf, or have a hearing or speech impairment, contact us through the National Relay Service – for more information, visit [relayservice.gov.au](http://relayservice.gov.au)



For other languages call 9209 0147



@bigbuildvic



Victoria's Big Build



MIX  
Paper from  
responsible sources  
FSC® C010983