

Works notice

Reinstatement and public realm works

Laurens Street, between Arden and Queensberry streets

Thursday 29 June to late August 2023

From Thursday 29 June until late August 2023, there will be public realm and reinstatement works on the eastern side of Laurens Street.

On Thursday 29 June, there will be a temporary day closure of Laurens Street between Barwise and Queensberry streets between 7am and 6pm. This will support the shifting of construction barriers to the eastern side of Laurens Street for public realm works.

What we are doing

- Shifting construction barriers from the western side of Laurens Street to the eastern side of Laurens Street between Arden and Queensberry streets
- Removing a section of the existing eastern footpath on Laurens Street, between Arden and Queensberry streets which includes non-destructive digging, excavating and saw cutting
- Resurfacing the eastern footpath which involves constructing new kerbs and installing new asphalt pavement.

What to be aware of

- To safely shift construction barriers, **Laurens Street will close to vehicles and cyclists between Barwise and Queensberry streets on Thursday 29 June from 7am to 6pm**
- During the one-day closure, the northbound and southbound bicycle lane on Laurens Street will be closed between Arden and Queensberry streets and cyclists will be detoured via Munster Terrace and Dryburgh Street
- The eastern footpath on Laurens Street between Arden and Queensberry streets will be closed to pedestrians once the barriers are in place
- Pedestrians access will be maintained on the western side of Laurens Street
- Local access to properties will be maintained at all times

- During reinstatement works, the northbound bicycle lane will be open and southbound cyclists will continue to be diverted via Dryburgh Street.
- Traffic management and signage will be in place to safely direct vehicles, cyclists, and pedestrians around the work site during construction
- These works are expected to generate periods of medium to high level noise and some vibration.

When

- Traffic barrier installation: 7am-6pm, Thursday 29 June
- Construction works: 7am to 6pm Monday to Friday, 7am to 1pm Saturdays.

Further information on these works can be found at metrotunnel.vic.gov.au

Construction partner:



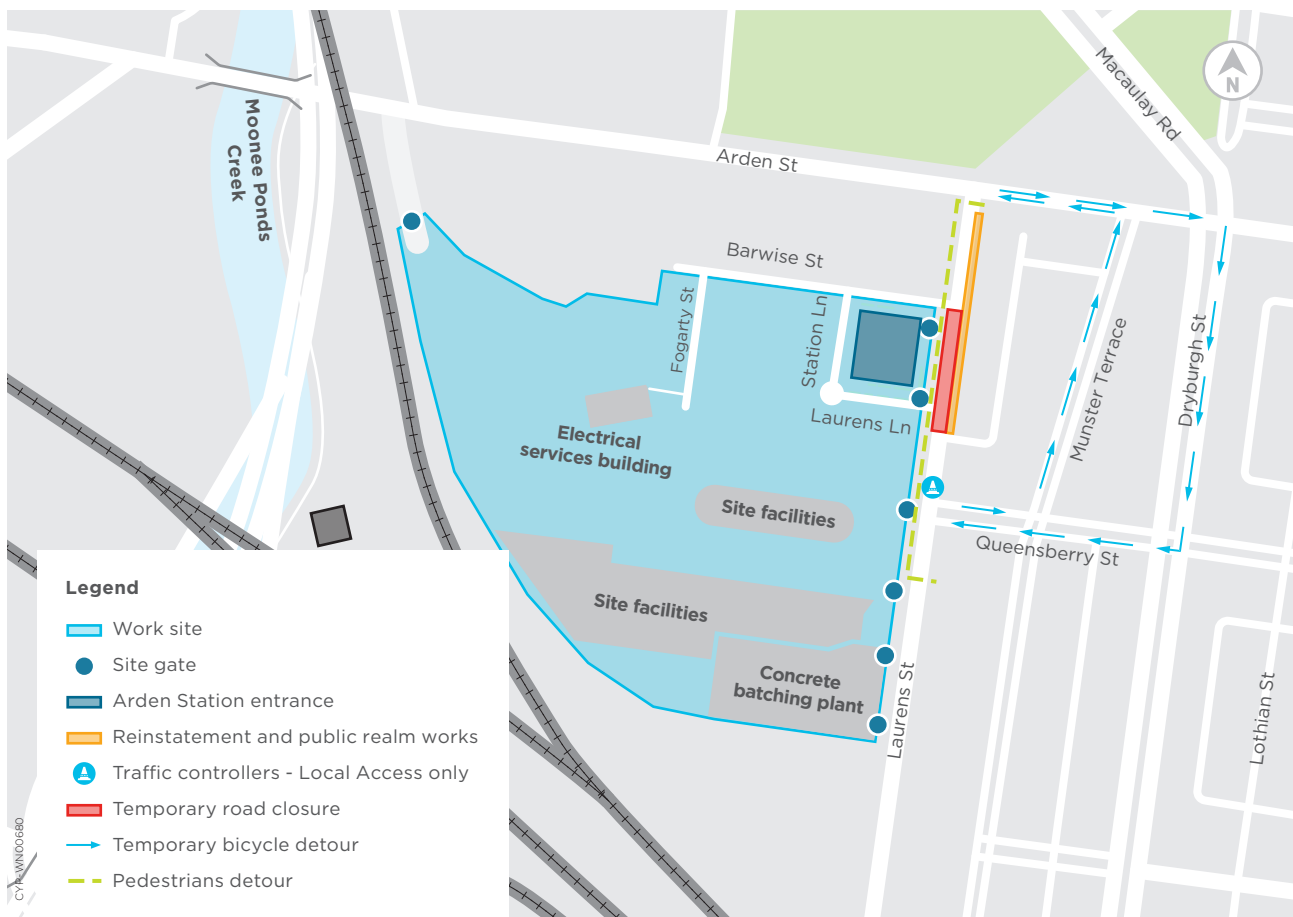

Indicative Only

More information

[metrotunnel.vic.gov.au](https://www.metrotunnel.vic.gov.au)

1800 105 105
(24 hours a day, 7 days a week)

Rail Projects Victoria
PO Box 2392, Melbourne, VIC 3001



Interpreter Service (03) 9209 0147

It should be noted that this information is current at the time of printing, however due to unforeseen circumstances, changes may occur. Please visit railprojects.vic.gov.au for the latest updates.