

Upcoming works

Bulleen, Balwyn North, Doncaster, Mont Albert North

June / July 2025

BIG BUILD
EASTERN FREEWAY

Works are progressing across all of our sites with foundations for structures and bridges beginning to form on the freeway shoulders and centre median

Construction snapshot

We're edging closer to opening new lanes on Bulleen Road with the bridge between the Eastern Freeway and Carey Sports Complex ready to open late next month.

In Doncaster, we've moved traffic onto temporary entry and exit ramps, creating more space to progress Doncaster Road interchange works.

We're here to help

We understand that construction in the local area can be challenging.

Call **1800 105 105** anytime or visit the Project Information Centre at **284 Doncaster Road, Balwyn North**, Tuesday to Thursday, 9am to 3pm



Scan the QR code for more details

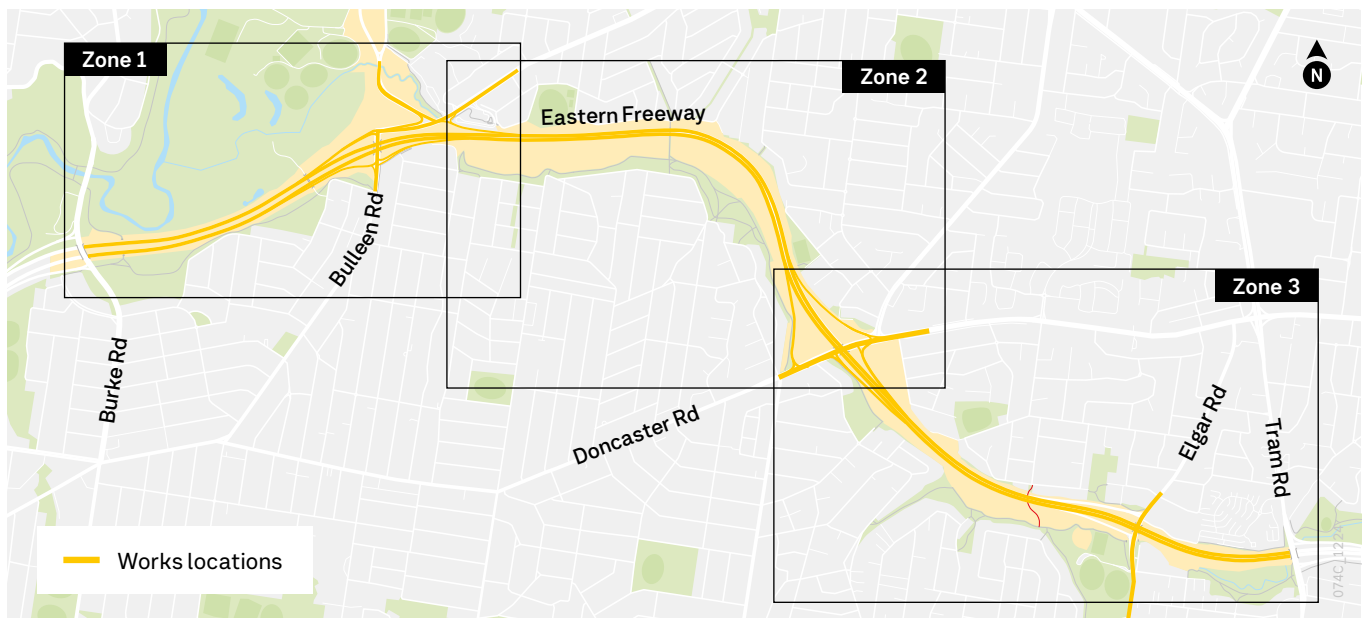

When are we working?

- Day works** 7am to 7pm from Monday to Friday and 7am to 3pm Saturdays and Sundays
- Night works** 7pm to 7am from Monday to Saturday
- Day / night works** at times during day and night works hours
- 24-hour works (at times)** Notification provided before works

North East Link Tunnels and future Manningham Road interchange

As part of works to build the North East Link tunnel entrance, Bulleen Road will be closed: Northbound in sections between Manningham Road and Thompsons Road from 13 to 21 July; Southbound overnight from 18 to 21 July.

Detours will be in place and local access will be maintained.

Traffic management will be in place to guide road users through the area. Please observe on road signage, plan your travel, and allow additional time.

Visit bigbuild.vic.gov.au for the latest information.

contact@bigbuild.vic.gov.au



Schedule is subject to change. Visit bigbuild.vic.gov.au/roads for changes.

Please contact us if you would like this information in an accessible format. If you need assistance due to a hearing or speech impairment, visit relayservice.gov.au



Australian Government
BUILDING AUSTRALIA



For languages other than English please call 9209 0147

如需获取英语以外的其它语言的协助, 请致电9209 0147。

Για γλώσσες εκτός της αγγλικής Καλέστε το 9209 0147

Per lingue diverse dall'inglese Chiamare il numero 9209 0147



Zone 1: Burke to Bulleen roads, Eastern Freeway interchange

Ongoing / existing works

Earthworks	Site establishment	Utility works	Day works
Piling / foundation work	Concrete foundation	Drainage works	Night works
Demolition	Roadworks	Vegetation removal	Day / night works
Lighting and smart on-road technology	Oversize deliveries	Traffic signal works	

New works

Where	Activity	What to expect
1 Bulleen Road between Carey Bulleen Sports Complex and Leonis Avenue	<ul style="list-style-type: none"> Sheet piling to support construction of bridge structures near Bulleen citybound entry ramp. Earthworks in the Leonis Reserve work site for new compounds. Driven and bored piling works to build bridge foundations for tunnel connection and busway bridges and retaining walls. Site investigations on Bulleen Road near Leonis Reserve work site. Demolition of sections of the existing Bulleen Road bridge. Asphalting, barrier placement, line marking, noise panel installation and traffic signal works for the new Bulleen Road bridge. Drainage north and south of Koonung Creek. Bulk earthworks to construct piling pads. Demobilisation of site compound buildings. 	<ul style="list-style-type: none"> Delivery of heavy machinery and vehicles Medium to high levels of noise Use of directional lighting Changes to pedestrian and shared paths Reduced speeds and lane closures on Bulleen Road and Eastern Freeway
2 Thompsons Road between Bulleen Road bridge and Bulleen Park and Ride	<ul style="list-style-type: none"> Sheet piling to support the construction of bridge structures. Soil nail retaining wall construction, reinforcement and concrete works. Telstra utility service relocations. 	<ul style="list-style-type: none"> Reduced speeds and lane closures on Bulleen and Thompsons roads Changes to pedestrian and shared paths Overnight ramp closures Use of directional lighting
3 Citybound exit ramp and between Koonung Creek Reserve and Bulleen Road	<ul style="list-style-type: none"> Sheet piling in our work site between the Bulleen citybound exit ramp and the Eastern freeway to support the construction of Bulleen Road bridge widening. Weekend blitz and ramp closure to realign the Bulleen Road citybound exit ramp. 	<ul style="list-style-type: none"> Heavy machinery and vehicles Medium levels of noise and use of directional lighting Reduced speeds and shared paths changes Overnight lane and ramp closures
4 Between Burke and Bulleen roads	<ul style="list-style-type: none"> Tree removal, noise wall removal and installing timber fencing to create a new work area within Musca Reserve. Building hardstands and piling to construct a retaining wall and installing golf ball netting at Freeway Golf Course. Asphalting and realigning barriers. 	<ul style="list-style-type: none"> Heavy machinery and vehicles Medium levels of noise Use of directional lighting Reduced speeds Overnight lane and ramp closures

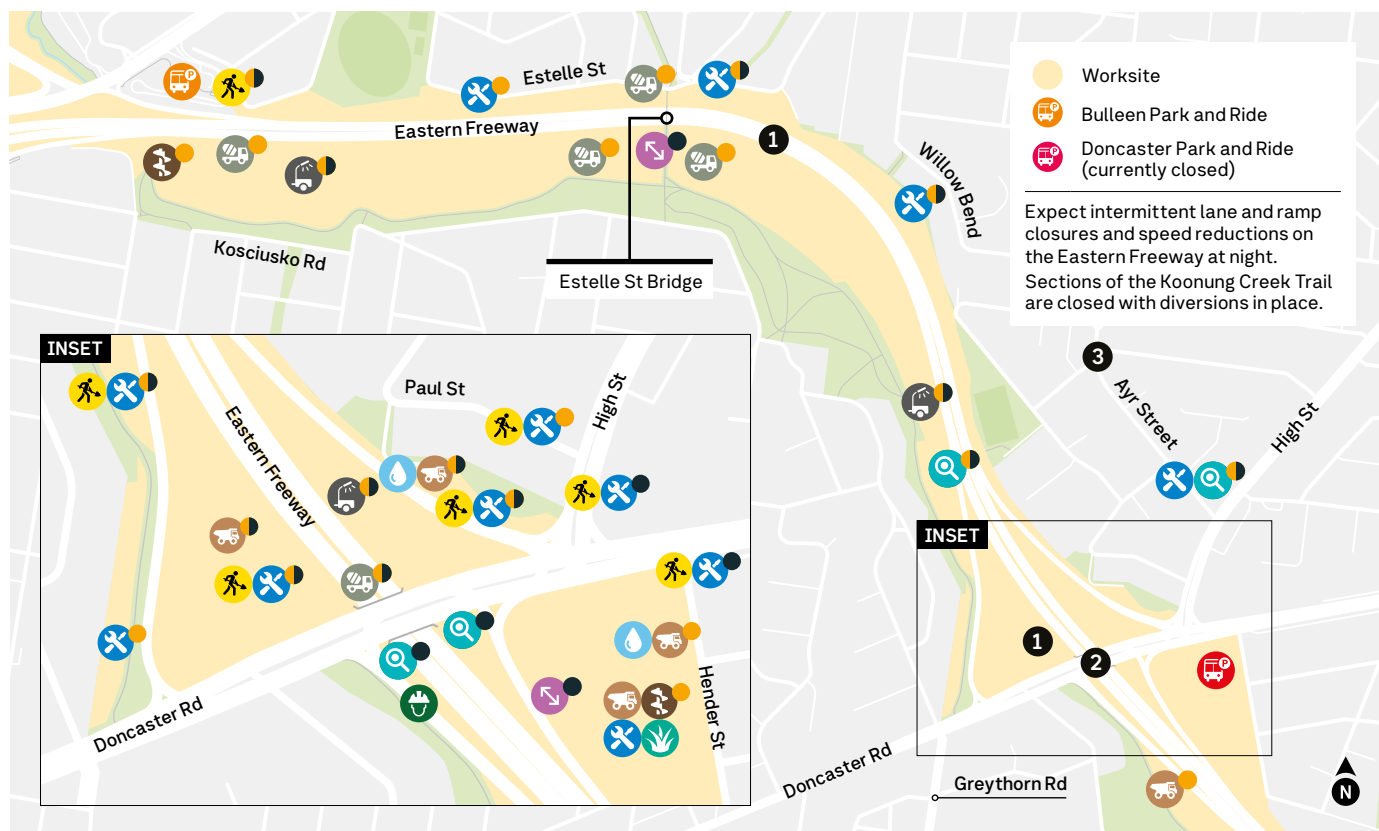

Zone 2: Bulleen to Doncaster roads, Koonung Creek Reserve

Ongoing / existing works

Earthworks	Site investigations	Utility works	Day works
Piling / foundation work	Concrete foundation	Drainage works	Night works
Lighting and smart on-road technology	Roadworks	Vegetation removal	Day / night works
	Oversize deliveries	Site establishment	

New works

Where	Activity	What to expect
1 Between Bulleen and Doncaster roads	<ul style="list-style-type: none"> Reinforcement and concrete works in the Koonung Creek Reserve and for the Doncaster Road bridge. Excavation and concrete works for new retaining walls. Constructing piling pads and delivery of piling rig for new Doncaster Road bridge. Crane delivery and installation of pre-cast panels for new retaining walls. Structural steel beam assembly and installation for the new Estelle Street Bridge. Constructing shafts next to Estelle Street and behind Willow Bend. Installing cables for lighting and smart on-road technology next to Kampman Street. Piling and foundation works for noise walls and Doncaster Busway bridge. Site investigations. 	<ul style="list-style-type: none"> Use of directional lighting Moderate to high levels of noise, dust and vibration Access and use of the Koonung Creek Reserve worksite day and night Overnight machinery and material deliveries via the freeway Working extended hours 24/7 operation of a pump system to remove groundwater out of sewer shafts at Estelle Street and Willow Bend Overnight ramp closures
2 Doncaster Road between Greythorn Road and Harcourt Street	<ul style="list-style-type: none"> Site establishment, vegetation removal and noise wall removal. Piling and foundation works for Doncaster Busway bridge. Oversized concrete Super T deliveries for the new Doncaster bridge. 	<ul style="list-style-type: none"> Heavy machinery and vehicles Medium to high levels of noise, dust and vibration Traffic controllers and signage Use of directional lighting Changes to pedestrian and shared paths Overnight ramp and lane closures
3 Ayr Street and Timber Ridge	<ul style="list-style-type: none"> Installing new water mains on Ayr Street and Timber Ridge. Site establishment and works commencement at Timber Ridge Reserve to construct a new pressure reducing station. 	<ul style="list-style-type: none"> Road detours Heavy machinery and vehicles Medium to high levels of noise, dust and vibration Traffic controllers and signage Use of directional lighting Boom gates controlling intersections at times



Zone 3: Doncaster to Tram roads, Valda Wetlands

Ongoing / existing works

	Earthworks		Concrete foundation		Utility works		Day works
	Piling / foundation work		Roadworks		24/7 creek bypass pumping		Night works
	Lighting and smart on-road technology		Oversize deliveries		Site establishment		Day / night works
							24-hour works

New works

Where	Activity	What to expect
1 Between Doncaster and Elgar roads	<ul style="list-style-type: none"> Delivery of cranes and installation of precast panels for new retaining walls and concrete arches for new creek protection structures. Hardstand construction on Freeway shoulder (near Massey Street) Tunnelling works to relocate a sewer main. Site investigations via drilling and using a high-pressure hose near the Doncaster Road Ringwood-bound entry and citybound exit ramp. Trenching to install drainage along the freeway Ringwood-bound. Operation of a pump system to remove groundwater out of sewer shafts at Hender and Massey streets. 	<ul style="list-style-type: none"> Moderate to high levels of noise, dust and vibration Heavy machinery and vehicles entering and exiting site via Wilsons Road and Stanton Street Access to the Doncaster Park and Ride site day and night Overnight machinery and material deliveries via the freeway
2 Valda Wetlands	<ul style="list-style-type: none"> Piling for the new Heyington Bridge abutments. Demolishing the southern ramp of the Heyington Bridge. Installing soil nails, steel reinforcement and concrete works as part of creek construction. Soil nail retaining wall construction. Site investigations. Delivery of steel beams for the new Heyington Avenue bridge. 	<ul style="list-style-type: none"> Moderate to high levels of noise, dust and vibration Construction vehicles entering and exiting via Clifton and Sweyn streets Heavy machinery and equipment Overnight lane and ramp closures Overnight machinery and material deliveries via the freeway
3 Between Elgar and Tram roads	<ul style="list-style-type: none"> Piling, concrete and steel works to build noise walls along Sargent Street. Soil nailing, piling, concrete and steel works and earthworks to build retaining walls along Sargent Street. 	<ul style="list-style-type: none"> Moderate to high levels of noise, dust and vibration Heavy machinery and vehicles Construction vehicles entering and exiting via Elgar Service Road