

Construction update



Kensington works update

July 2026

Completion activities are continuing in Kensington as part of the Metro Tunnel Project. This update provides an outline of current and upcoming works in your area throughout July 2026.

Works snapshot: July 2026

Construction works within the Kensington precinct during July 2026 will include:

- Completion works including 24-hour rail corridor works
- Use of Childers Street rail access point
- Permanent closure of flood wall gap at Childers Street
- Track alignment works
- Rail access point completion works
- Childers Street reinstatement works.

Further information on these works can be found overleaf or at metrotunnel.vic.gov.au.



24-hour rail corridor works May 2026

When are we working?



Normal construction hours

7am to 6pm, Monday to Friday
7am to 1pm, Saturdays



Out of hours

Some works are required to take place out of normal construction hours



24 hours

24 hour works are sometimes required during peak construction activities
We will notify if out of hours works are required



24-hour rail corridor works May 2026

Upcoming works in your area

24-hour rail corridor works

Rail corridor between Footscray Station and McLennan Drive, Kensington



8pm Tuesday 7 July to 3am Monday 13 July 2026

- Removal of redundant track and signalling equipment
- Trenching for installation of new signalling assets and drainage
- Foundation removal
- Installation of wiring
- Track formation works
- Track alignment works

Use of rail access point

Childers Street, Kensington



8pm Tuesday 7 July to
3am Monday 13 July 2026

- The rail access point will be used during the 24-hour rail corridor works for equipment to enter and exit the rail corridor
- A single lane closure will be in place on Childers Street between Bakehouse Road and South Kensington Station with traffic management onsite to assist vehicles, cyclists and pedestrians
- On-street parking on the rail corridor side of Childers Street between Bakehouse Road and South Kensington Station will be temporarily unavailable during this time
- Lighting towers will be required while we complete night works. Where possible, we will use battery powered lights, and lights will be positioned to face away from residential properties.

Tennyson Street truncation and speed hump

- Please note, the permanent truncation on Tennyson Street will be reinstated in August as part of Metro Tunnel Project completion works
- The Project will also remove the temporary speed hump on Tennyson Street in the coming months
- More information will be provided in a future works notification.

Works area map July 2026

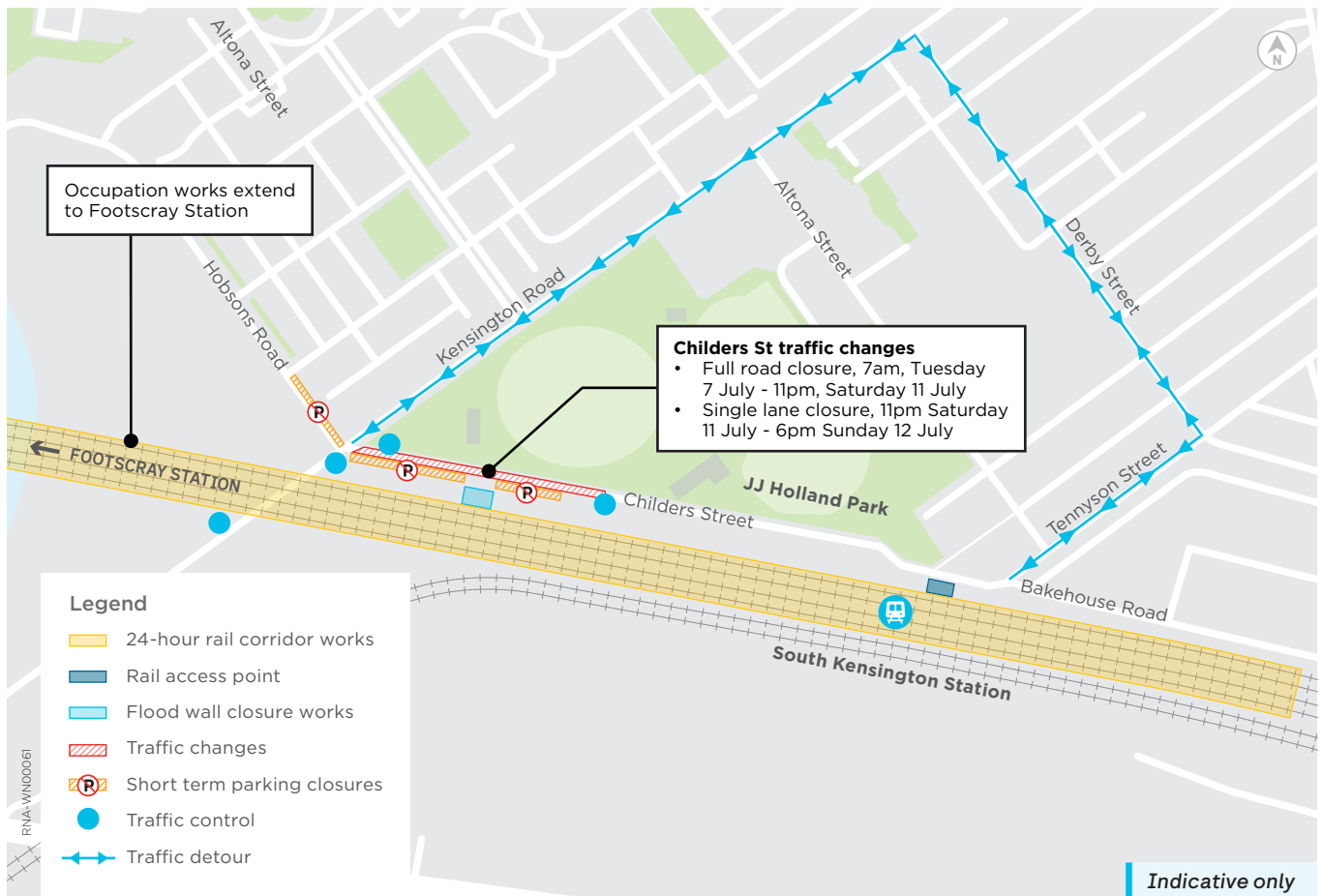

Flood wall closure

Childers Street between Kensington Road and South Kensington Station, Kensington



8pm Tuesday 7 July to 12am Sunday 12 July 2026

- The opening in the flood wall will be closed using precast panels during the 24-hour rail corridor works
- An excavator, telehandler, cranes, franna and hand tools will be used to undertake the works
- A single lane closure will be in place on Childers Street between Kensington Road and South Kensington station from 11pm, Saturday 11 July to 6pm Sunday 12 July 2026
- A full road closure of Childers Street between Kensington Road and the Bill Vanina Pavilion at JJ Holland Park will be in place from 7am, Tuesday 7 July to 11pm Saturday 11 July 2026. Traffic management will be in place help assist with traffic
- During the full road closure of Childers Street, a detour will be in place via Kensington Road, Derby Street, Tennyson Street into Childers Street. The concrete blocks on Tennyson Street will be removed from 7am on Thursday 9 July and will be returned to block access following these works on 11pm Friday 10 July 2026
- During the transportation of precast panels from the Hobsons Road site to the opening in the flood wall on Childers Street, between 7am on Thursday 9 July to 11pm on Friday 10 July 2026, stop and hold traffic arrangements on Hobsons Road and across Kensington Road will be in place with traffic management to assist
- During this time, 8 car park spaces will be temporarily unavailable on Hobsons Road opposite the entrance into site near Kensington Road to assist with the transportation of precast panels to Childers Street
- A section of the southern footpath, between Kensington Road and South Kensington Station, will be closed and pedestrians will be detoured to JJ Holland Park
- Works are expected to generate medium levels of noise
- Traffic management will be in place to assist with vehicle, cyclist and pedestrian movements
- Car parking spaces on either side of the flood wall opening will be temporarily closed during these works.

Works area in July after rail corridor works

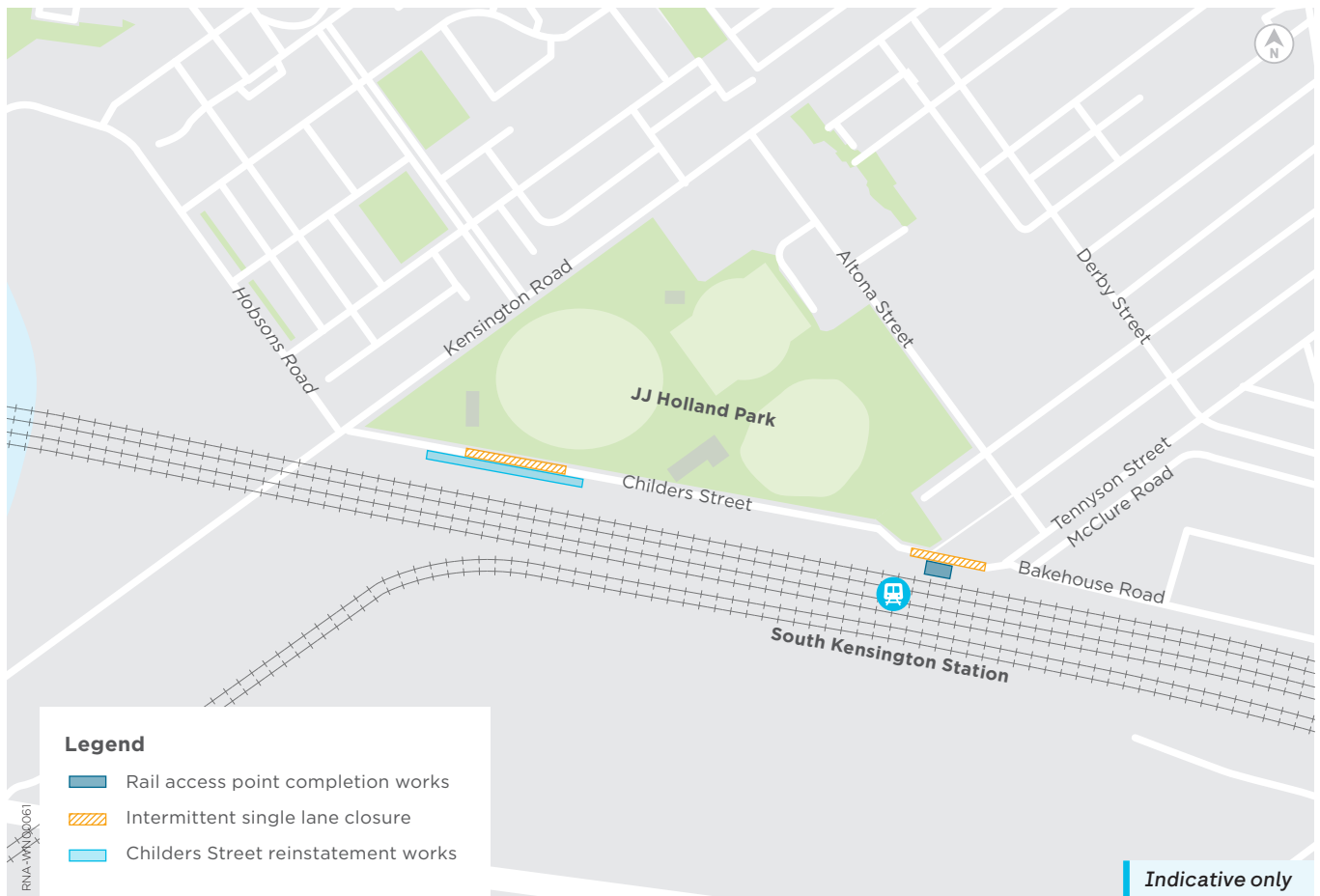

Track alignment works above Kensington Road



Thursday 9 July 2026, 4.15am – 12.15pm

- Track alignment works will take place along the rail corridor including on the rail bridge, above Kensington Road
- There will be intermittent stop and holds as the tamper machine moves across the bridge. For the safety of drivers, cyclists and pedestrians, all movements under the bridge will be stopped for around 60 seconds at a time between **4.15am and 12.15pm**
- Traffic management will be in place to assist with stop and hold arrangements.

Rail access point completion works



Childers Street between Bakehouse Road and South Kensington Station, Kensington

Friday 14 July to Friday 31 July 2026, 7am – 6pm

- Completion works for the rail access point including removing crushed rock, formwork, concrete, fence and gate and kerbing installation
- These works will require an excavator, NDD machine, concrete truck and hand tools
- Works are expected to generate medium levels of noise with intermittent periods of high noise levels
- Intermittent single lane closures will be in place on Childers Street between Bakehouse Road and South Kensington Station, with traffic management onsite to assist vehicles, cyclists and pedestrians
- On-street parking on the rail corridor side of Childers Street between Bakehouse Road and South Kensington Station will be intermittently closed for short periods.



24-hour rail corridor works May 2026

Childers Street reinstatement works



Childers Street between South Kensington Station and Kensington Road, Kensington

Friday 14 July to Friday 31 July 2026, 7am- 6pm

- These works include installation of utilities, profiling, hydrant relocation, pavement and kerbing works and landscaping
- These activities require NDD trucks, excavators, elevated work platform and hand tools
- This work is expected to generate medium to high levels of noise
- An intermittent single lane closure will be in place at various times on Childers Street between South Kensington Station and Kensington Road, with traffic management in place to assist with vehicle, cyclist and pedestrian movements.

24-hour rail corridor works

- For the safety of passengers and our workers, these activities can only occur when trains are not running
- During the 24-hour rail corridor works, generator-powered lighting towers may be required near your area while works are being completed. Where possible, lights will be positioned to face away from residential properties.

Look ahead for 2026

	July	August
24-hour rail corridor works		
Completion works in Kensington		

Traffic and transport impacts

In addition to the traffic changes outlined in this notice, there will be:

- Increased construction vehicles and trucks at the Childers Street, Hobsons Road and Kensington Road during the 24-hour rail corridor works to facilitate delivery of materials and equipment.
- An increase in vehicle movements including trucks around Derby Street and Tennyson Street between 7am on Thursday 9 July to 11pm on Friday 10 July.
- An increase in larger vehicles delivering equipment to the Hobsons Road site.

Buses replacements

- Buses will replace trains at various times in July. Please allow for extra travel time.
- To learn more about station impacts along the Werribee and Williamstown lines, visit transport.vic.gov.au/werribee

Find out more

metrotunnel.vic.gov.au

1800 105 105 (call anytime)



For languages other than English please call (03) 9209 0147



Please contact us if you would like this information in an accessible format. If you need assistance due to a hearing or speech impairment, visit relayservice.gov.au

