



DOMAIN PRECINCT COMMUNITY REFERENCE GROUP

Presentation by CYP

26 February 2025



OFFICIAL: Sensitive

ACTIONS AND ISSUES

ACTIONS AND ISSUES



#	ACTION / ISSUE	OWNER
A59-1	CYP to provide an update on the matter of cars entering the footpath area at Albert Road South.	CYP
A59-2	MTPO to explore temporary signage options to prevent pedestrians entering the bike path when approaching Albert Road station entrance from the north.	MTPO
A59-3	CoM to provide an update on the reopening of Edmund Herring Oval in early 2025.	CoM
A59-4	MTPO to confirm details of the February 2025 CRG meeting.	MTPO
A59-5	CYP to provide an update on the review of skateboarders using the pavement outside Domain Hill.	CYP
A59-6	CYP to investigate use of temporary traffic bollards for defect works outside the Domain building and any subsequent impacts to visibility at the intersection of Albert Road south and St Kilda Road.	CYP

WORKS UPDATE

WORKS UPDATE

ALBERT ROAD FOOTPATH WORKS



- Rectification works on the pedestrian ramp on the corner of St Kilda Road and Albert Road commenced yesterday
- This involves replacing a section of the existing footpath
- The Albert Road north pedestrian crossing, at St Kilda Road, will remain closed
- These works will continue until Saturday 8 March
- A handrail will then be installed separately in mid-March



WORKS UPDATE

ALBERT ROAD SOUTH WORKS



- Works to widen the passing bay on Albert Road, in front The Domain, will take place from mid-March to late March
- A granite bench will be removed and the garden bed will be adjusted as part of these works
- Traffic arrangements for these works are being confirmed
- Separate notification will be provided prior to works commencing



WORKS UPDATE

ALBERT ROAD NORTH WORKS



- An additional section of kerb and linemarking will be installed at Albert Road north from late March to early April
- During these works, Albert Road northbound will be closed to general traffic. Local access to buildings will be maintained
- Separate notification will be provided prior to works commencing

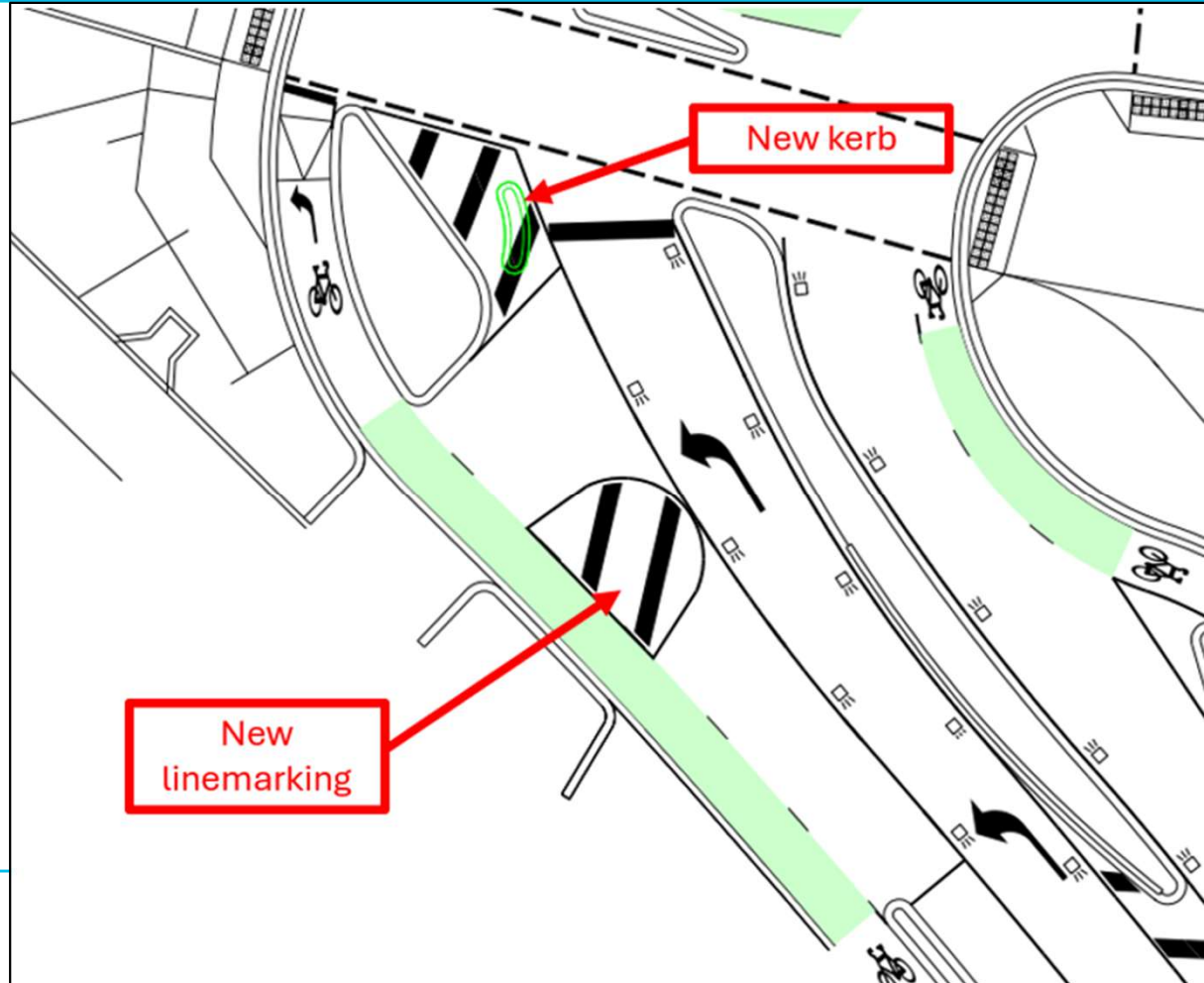

ANZAC STATION SITE MAP



ST KILDA ROAD

TEMPORARY LANE SEPARATOR INSTALLATION



- As part of monitoring the St Kilda Road, Albert Road and Domain Road intersection we have identified some traffic are making illegal U-turns from the southbound St Kilda Road lanes
- As an initial measure a temporary lane separator will be installed to manage this issue.

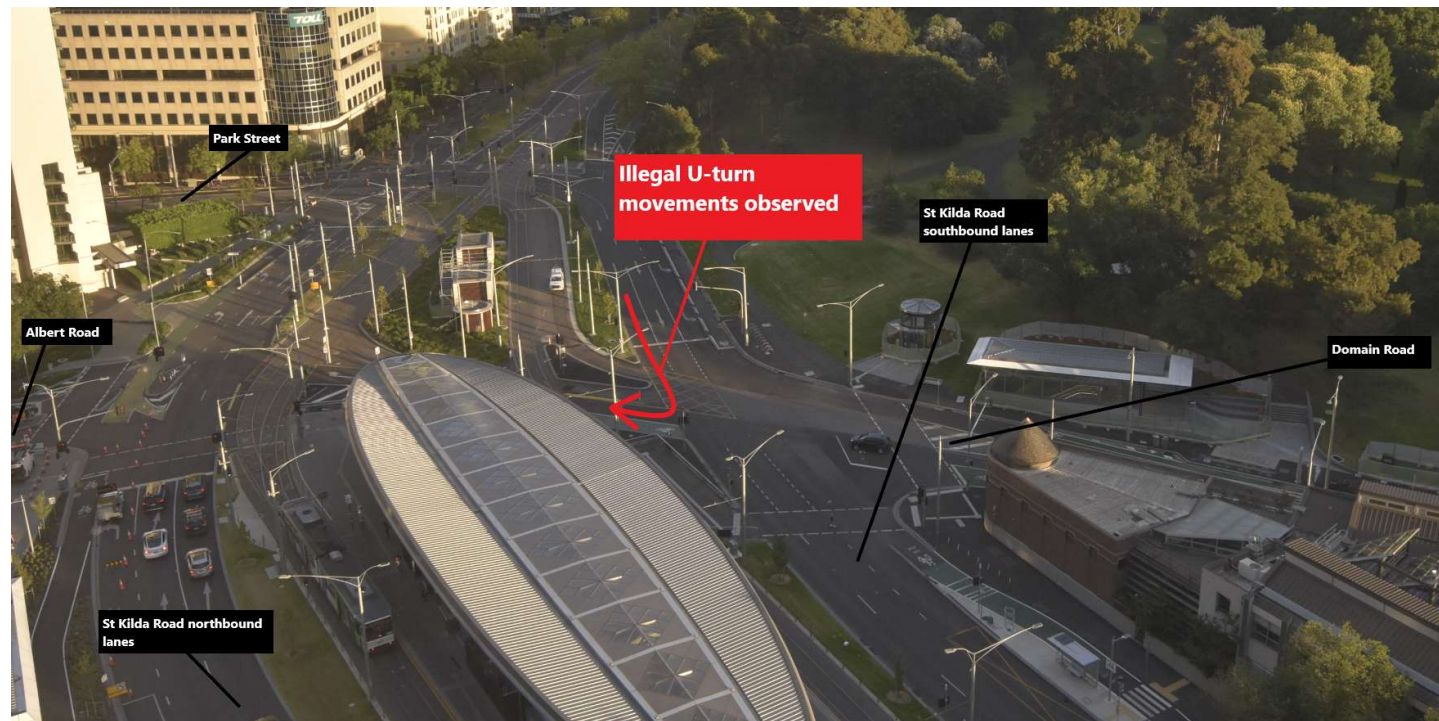

MAINTENANCE RESPONSIBILITY MAP

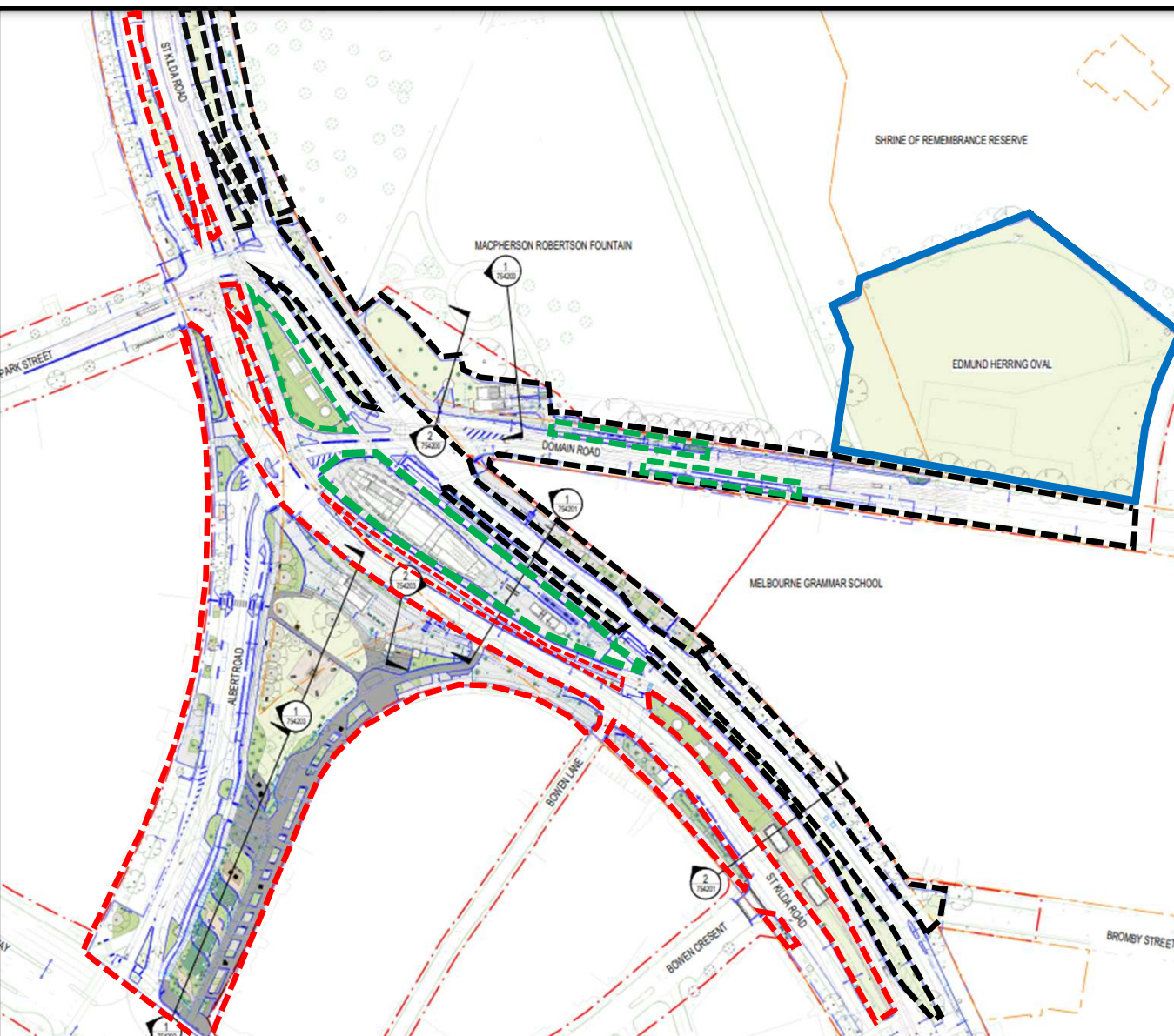

Maintenance responsibility map

- CYP
- City of Port Phillip
- City of Melbourne
- Yarra Trams

Key areas:

Roads

- St Kilda Road – Dept of Transport
- Albert Road – City of Port Phillip
- Domain Road – City of Melbourne

Operational Infrastructure

- Tram platform (incl. rubbish bins)
Yarra Trams
- Station infrastructure
(Including vents, chiller plant and entrances)
Metro Trains Melbourne

PROJECT WIDE UPDATE



TRIAL OPERATIONS

TRIAL OPERATIONS



- In late 2024 MTP started Trial Operations, which is the final phase of project delivery
- Trial Operations is the ‘dress rehearsal’ for the Metro Tunnel. These simulate a range of possible real-life scenarios, including station and train evacuation and is the first-time station staff, operators, maintenance staff, drivers and volunteer passengers will be involved – a really important step before the project welcomes passengers
- Trial Operations are underway in preparation ahead of Day 1 operations of the Metro Tunnel and we will continue to keep you updated on this.

OTHER BUSINESS