

# Upcoming works

## Bulleen, Balwyn North, Doncaster, Mont Albert North

July / August 2026



### Construction snapshot

We're continuing major works along the Eastern Freeway including building new lanes, noise walls and overhead structures.

We've reopened the Elgar Road citybound entry ramp after significant works to realign the ramp into its final position.

We recently closed the freeway to lift large beams into place as part of works to upgrade the Bulleen Road interchange. Soon, we'll also start lifting bridge beams at Doncaster Road as part of the bridge upgrade.

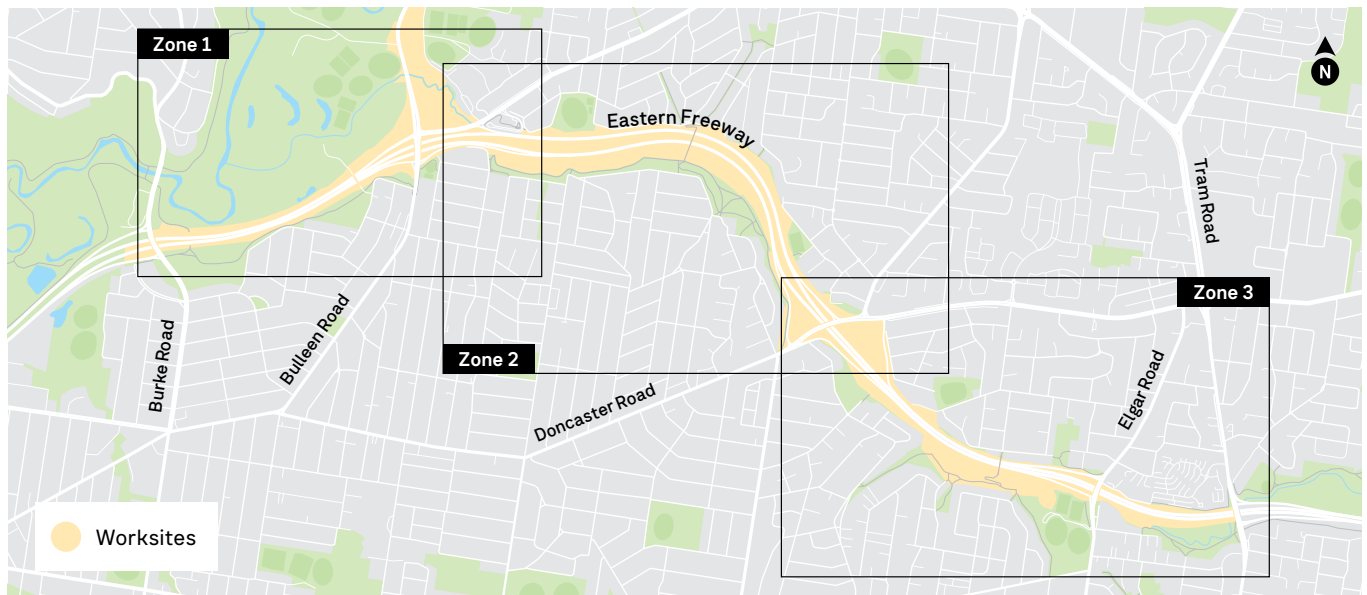
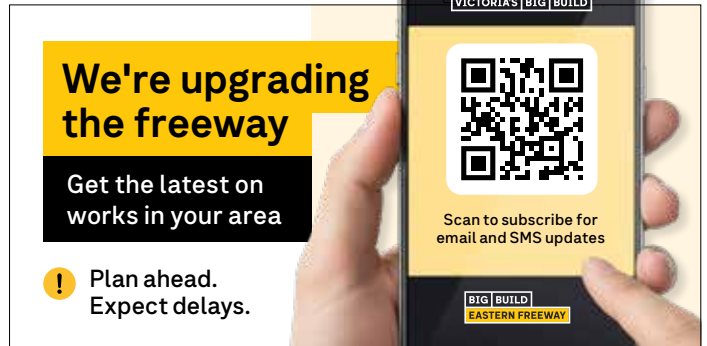

### When we are working

- Day works** 7am to 6pm from Monday to Friday and 7am to 3pm, Saturdays and Sundays
- Night works** 6pm to 7am from Monday to Saturday and 3pm to 7am, Saturdays and Sundays
- Day/night works** At times during day and night hours
- 24-hour works** At times  
Notification provided before works

**We use water carts and noise mitigation measures wherever possible to reduce dust and noise while we work. We'll be in touch with impacted residents regarding specific times for construction activities and to offer support.**

### Upcoming disruptions

Bulleen Road closed between Bridge Street and Manningham Road from 6am, Saturday 18 July to 7pm, Sunday 2 August.

Bulleen Road southbound closed between Manningham Road and Noelle Street from 7pm to 6am on Thursday 16 July and Saturday 18 July.

Manningham Road and Bulleen Road intersection will be closed from 7pm to 6am on Friday 17 July and Thursday 2 August.

The Bulleen Road citybound exit ramp closed from 10pm, Friday 3 July to early August.

To stay up to date visit [northeastlink.vic.gov.au](http://northeastlink.vic.gov.au)

[contact@bigbuild.vic.gov.au](mailto:contact@bigbuild.vic.gov.au)

Schedule is subject to change. Visit [bigbuild.vic.gov.au/roads](http://bigbuild.vic.gov.au/roads) for changes.

Please contact us if you would like this information in an accessible format. If you need assistance due to a hearing or speech impairment, visit [relayservice.gov.au](http://relayservice.gov.au)



For languages other than English please call 9209 0147

如需获取英语以外的其它语言的协助, 请致电9209 0147.

Για γλώσσες εκτός της αγγλικής Καλέστε το 9209 0147

Per lingue diverse dall'inglese Chiamare il numero 9209 0147

# Zone 1: Burke to Bulleen roads and Bulleen Road interchange

## Ongoing and existing works

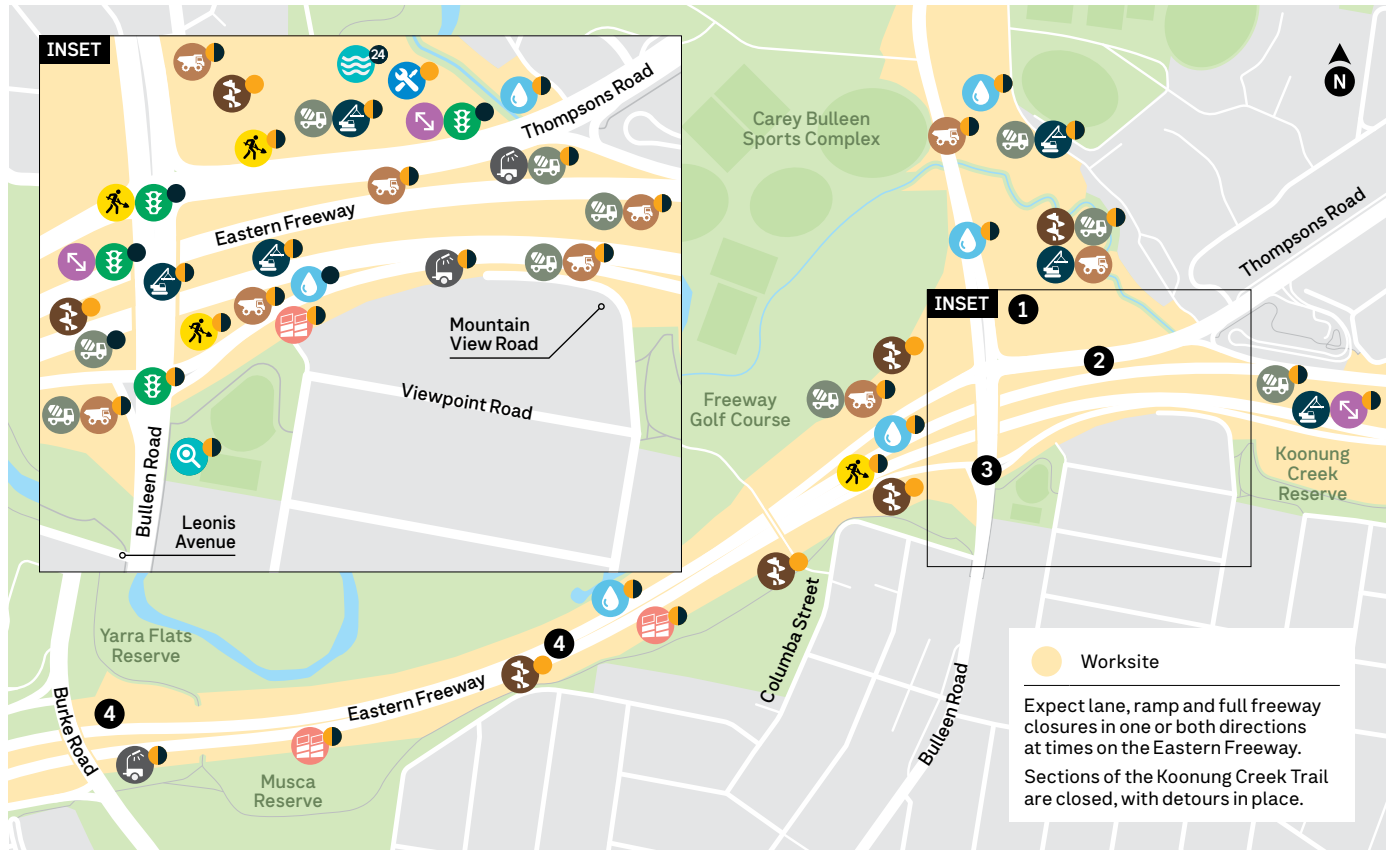

- |                          |                          |                      |                                 |
|--------------------------|--------------------------|----------------------|---------------------------------|
| Earthworks               | Concrete foundation      | Oversize deliveries  | Lighting and on-road technology |
| Piling / foundation work | Bridge beam installation | Utility works        | Day works                       |
| Creek bypass pumping     | Noise wall construction  | Drainage works       | Night works                     |
| Site investigations      | Roadworks                | Traffic signal works | Day / night works               |

## New works starting July / August 2026

Where	Activity	What to expect
<b>1</b> Bulleen Road between Carey Bulleen Sports Complex and Leonis Avenue	<ul style="list-style-type: none"> <li>Installation of concrete barriers on elevated ramps.</li> <li>Earthworks for busway, underpass, ramp and Koonung Creek works.</li> <li>Installation of retaining wall panels.</li> <li>Delivery and installation of beams.</li> <li>Bridge strengthening and widening works on Bulleen Road bridge, including barrier installation and concrete and steel fixing works.</li> </ul>	<ul style="list-style-type: none"> <li>Overnight lane and road closures</li> <li>Pedestrian and shared path detours</li> <li>Medium to low levels of noise, dust and vibration</li> <li>Use of directional lighting</li> <li>Delivery of heavy machinery and vehicles</li> </ul>
<b>2</b> Thompsons Road	<ul style="list-style-type: none"> <li>Cutting and removal of steel sheets.</li> <li>Asphalting, traffic signal works, line marking, vegetation removal and removal of traffic islands.</li> <li>Earthworks, drainage, steel fixing and concrete works for Thompsons Road realignment works.</li> </ul>	<ul style="list-style-type: none"> <li>Overnight lane and ramp closures</li> <li>Medium to low night time levels of noise, dust and vibration</li> <li>Traffic and lane configuration changes</li> <li>Use of directional lighting</li> </ul>
<b>3</b> Bulleen Road citybound entry and exit ramps	<ul style="list-style-type: none"> <li>Piling works to build foundations for shared path underpass.</li> <li>Earthworks, steel reinforcement and concrete pours to build shared path underpass and permanent traffic barriers.</li> <li>Noise wall removal.</li> <li>Installation of cabling for new on-road technology.</li> <li>Traffic signal and drainage works near citybound entry ramp.</li> <li>Installation of beams and traffic barriers.</li> </ul>	<ul style="list-style-type: none"> <li>Day and night closure of the citybound entry and exit ramps</li> <li>Medium to low night time levels of noise, dust and vibration</li> <li>Traffic controllers and signage</li> <li>Increase in heavy machinery and vehicles accessing site on Highview Road</li> </ul>
<b>4</b> Between Burke and Bulleen roads	<ul style="list-style-type: none"> <li>Earthworks, landscaping and installation of drainage along freeway.</li> <li>Installation of freeway lighting and cabling for new on-road technology.</li> <li>Building retaining walls.</li> <li>Installation of noise wall panels along the freeway citybound.</li> <li><b>Piling, steel and concrete works to build foundations for overhead structures and permanent barriers.</b></li> <li>Freeway investigations, asphalting, barrier realignment and line marking.</li> </ul>	<ul style="list-style-type: none"> <li>Overnight lane and ramp closures</li> <li>Traffic and shared path changes between Musca Reserve and Columba Street</li> <li>Medium to low levels of noise, dust and vibration</li> <li>Use of directional lighting</li> <li>Heavy machinery and vehicles</li> </ul>

# Zone 2: Bulleen to Doncaster roads and Koonung Creek Reserve

## Ongoing and existing works



## New works starting July / August 2026

Where	Activity	What to expect
<b>1</b> Between Bulleen and Doncaster roads, Koonung Creek Reserve	<ul style="list-style-type: none"> <li>Building of ramp at Bulleen Park and Ride for connection to busway.</li> <li>Piling for new noise walls behind Willow Bend, near Doncaster Road Ringwood-bound exit and near Bulleen Road citybound exit ramp.</li> <li>Piling for retaining wall foundations at Estelle Street and Park Avenue.</li> <li>Landscaping and installation of noise wall panels along freeway citybound.</li> <li>Finishing works for walking and cycling bridge at Estelle Street.</li> <li>Building temporary support towers in preparation for beam lifts.</li> <li>Earthworks, drainage and constructing permanent barriers in the centre median.</li> <li>Sewer and watermain relocation works along Estelle Street.</li> <li>Earthworks and panel installation for retaining walls on freeway near Bulleen Road and near Estelle Street.</li> <li>Installation of freeway lighting.</li> <li>Site and freeway investigations, asphaltting, barrier realignment and line marking.</li> <li>Sewer protection works near Estelle Street and Willow Bend.</li> </ul>	<ul style="list-style-type: none"> <li>Overnight freeway, lane and ramp closures</li> <li>Partial closure of Estelle Street, Kampman Street and Park Avenue, with detours in place</li> <li>Medium to low levels of noise, dust and vibration</li> <li>Use of directional lighting</li> <li>24/7 operation of pump systems at Willow Bend and Estelle Street</li> <li>Access and use of Koonung Creek Reserve worksite day and night</li> <li>Changes to shared paths on Estelle Street, with detours in place</li> <li>Increase in overnight and weekend activities</li> </ul>
<b>2</b> Doncaster Road interchange	<ul style="list-style-type: none"> <li>Earthworks and concrete pours.</li> <li>Delivery and installation of beams for new Doncaster Road bridge.</li> <li>Building concrete abutments and piers in freeway centre median and worksites near Doncaster Road.</li> <li>Building and installing retaining walls on the entry and exit ramps.</li> <li>Installation of drainage, utility works and new on-road smart technology on Doncaster Road.</li> </ul>	<ul style="list-style-type: none"> <li>Overnight lane and ramp closures</li> <li>Pedestrian and shared path detours</li> <li>Medium to low levels of noise, dust and vibration</li> <li>Use of directional lighting</li> <li>Heavy machinery and vehicles</li> <li>Traffic controllers and signage</li> </ul>

# Zone 3: Doncaster to Tram roads and Valda Wetlands

## Ongoing and existing works



- Earthworks
- Piling / foundation work
- Noise wall construction
- Concrete foundation
- Roadworks
- Oversize deliveries
- Utility works
- Drainage works
- Creek bypass pumping
- Lighting and on-road technology
- Day works
- Night works
- Day / night works
- 24-hour works

## New works starting July / August 2026

Where	Activity	What to expect
<b>1</b> Between Doncaster and Elgar roads, Doncaster Park and Ride	<ul style="list-style-type: none"> <li> Steel reinforcement and concrete pours at Doncaster Park and Ride. Piling and installation of retaining and noise walls. Steel reinforcement installation, concrete pours and earthworks to construct busways at Doncaster Park and Ride.</li> <li> Installation of water pipes, drainage, hydrants and noise walls. Construction of access roads within worksite.</li> <li> Earthworks and installation of traffic barriers. Earthworks, steel fixing, concreting at Massey Street for noise walls. Asphalt removal and installation for new freeway lanes. Sewer installation works near Doncaster Road interchange.</li> <li> Concrete and steel reinforcement works to build new traffic barriers.</li> </ul>	<ul style="list-style-type: none"> <li>- Overnight lane and ramp closures</li> <li>- Medium levels of noise, dust and vibration</li> <li>- Heavy vehicles and machinery accessing worksite via Wilsons Road and Stanton Street</li> <li>- Traffic controllers and signage</li> <li>- Day an night access to Doncaster Park and Ride worksite</li> <li>- Overnight deliveries via freeway</li> </ul>
<b>2</b> Valda Wetlands	<ul style="list-style-type: none"> <li> Concrete, steel works and piling for retaining and noise walls and concrete structures. Earthworks, sewer realignment and connection works to realign Koonung Creek.</li> <li> Earthworks and installation of traffic barriers, drainage, noise walls and cabling for new on-road technology. Sewer realignment and connection works.</li> </ul>	<ul style="list-style-type: none"> <li>- Overnight freeway, lane and ramp closures</li> <li>- Pedestrian and shared path detours</li> <li>- Medium to low levels of noise, dust and vibration</li> <li>- Heavy vehicles and machinery accessing worksite via Clifton and Sweyn streets</li> <li>- Overnight deliveries via freeway</li> <li>- New Eastern Freeway lanes</li> </ul>
<b>3</b> Between Elgar and Tram roads	<ul style="list-style-type: none"> <li> Piling and installation of retaining and noise walls. Earthworks and landscaping.</li> <li> Installation of concrete structures, underground supports, piling, steel works and earthworks. Construction of retaining and noise walls. Asphalting and pavement works to build new freeway lanes. Installation of cabling for new on-road technology.</li> </ul>	<ul style="list-style-type: none"> <li>- Overnight and weekend freeway, lane and ramp closures</li> <li>- Medium to high levels of noise, dust and vibration</li> <li>- Heavy vehicles and machinery entering via Elgar Road Service Road and exiting via Doncaster Road citybound exit ramp</li> <li>- New Eastern Freeway lanes</li> </ul>