



LEVEL CROSSING REMOVAL PROJECT



Cars travelling along a boom-gate free Hallam Road

LEVEL CROSSING GONE, NEW HALLAM STATION OPEN

HALLAM ROAD
HALLAM
JUNE 2022

The dangerous and congested level crossing at Hallam Road is gone for good, and a brand-new Hallam Station is now open.

The Victorian Government has invested \$15 billion in removing every level crossing on the Pakenham Line by 2025, changing the way people live, work and travel, and paving the way for more services, more often, when the Metro Tunnel opens.

The new station has taken pride of place on Hallam's skyline, with commuters stepping onto the elevated platforms for the first time during the morning peak on Monday 2 May.

The modern Hallam Station offers improved accessibility with station entrances via lifts and stairs on either side of Hallam Road.

The station opening follows the removal of the dangerous and congested Hallam Road level crossing in early April, with a new elevated rail bridge carrying trains over the road, making it safer for drivers, pedestrians and cyclists.

Finishing works will continue over the coming months, including a new walking and cycling path that will connect Glencairn Avenue to the station's eastern entrance.

Why this level crossing had to go



20,000 vehicles travel along Hallam Road every day



The boom gates were down for 33 per cent of the morning peak



14 near misses at this level crossing in the past 10 years



SIGN UP FOR PROJECT UPDATES
levelcrossings.vic.gov.au

VICTORIA'S
BIG BUILD

VICTORIA
State Government

PROJECT MILESTONES

July 2020

We released initial concept designs and received more than 200 contributions of feedback from the community



Scan the QR code to hear what the community had to say about removing the level crossing at Hallam Road



Artist impression only, subject to change

October 2020

The site was established and early works began



January 2021

Major construction started



Scan the QR code to watch major works start on the new rail bridge and Hallam Station



September 2021

Massive concrete L-beams were lifted into place over Hallam Road



Scan the QR code to watch how the beams were lifted into place



November 2021 to February 2022

Station platform construction continued, lifts and architectural screens installed



March to April 2022

We worked around the clock to remove the boom gates and complete the new station



April to May 2022

The Hallam Road level crossing is gone, and the new Hallam Station opens



Artist impression only, subject to change

May to mid-2022

New station artwork by Australian artist, Rose Nolan, installed

We will continue to work on finishing touches around the station precinct, including a new walking and cycling path and landscaping

YOUR NEW HALLAM STATION

Responding to extensive community consultation, we have built a new Hallam Station designed to deliver better facilities that are easier for the community to access.

Bold and open design

White architectural screening helps people see the station as a landmark from afar, and when up close, commuters can enjoy clear sightlines and accessibility.

Safer access

You can access the station platforms from either side of Hallam Road via lifts or stairs.

Two entrances

Two station entrances allows people who walk, cycle or catch the bus to safely enter the station from either side of Hallam Road, without needing to cross at the pedestrian lights.

Better facilities

The new station forecourt includes covered waiting areas, improved lighting and CCTV cameras, more bike storage, public toilets, and stairs and lifts for accessing the elevated platforms.

Upgrading the car park

You can safely move about the car park with a signalised entry and exit point. Works are continuing to mid-2022 to complete the car park, with new drop-off zones, more accessible parking, and a taxi rank with five spaces.

Local family waiting on the new platform



Upgraded north-west car park



New forecourt at western entrance



Passengers boarding citybound train

Train to Pakenham arrives on the new platform 2



Scan the QR code to hear from Nuray from local business, Mardini Bakery and Kebabs, on how the Hallam Road level crossing removal will help the local area



THE NEW HALLAM STATION PRECINCT

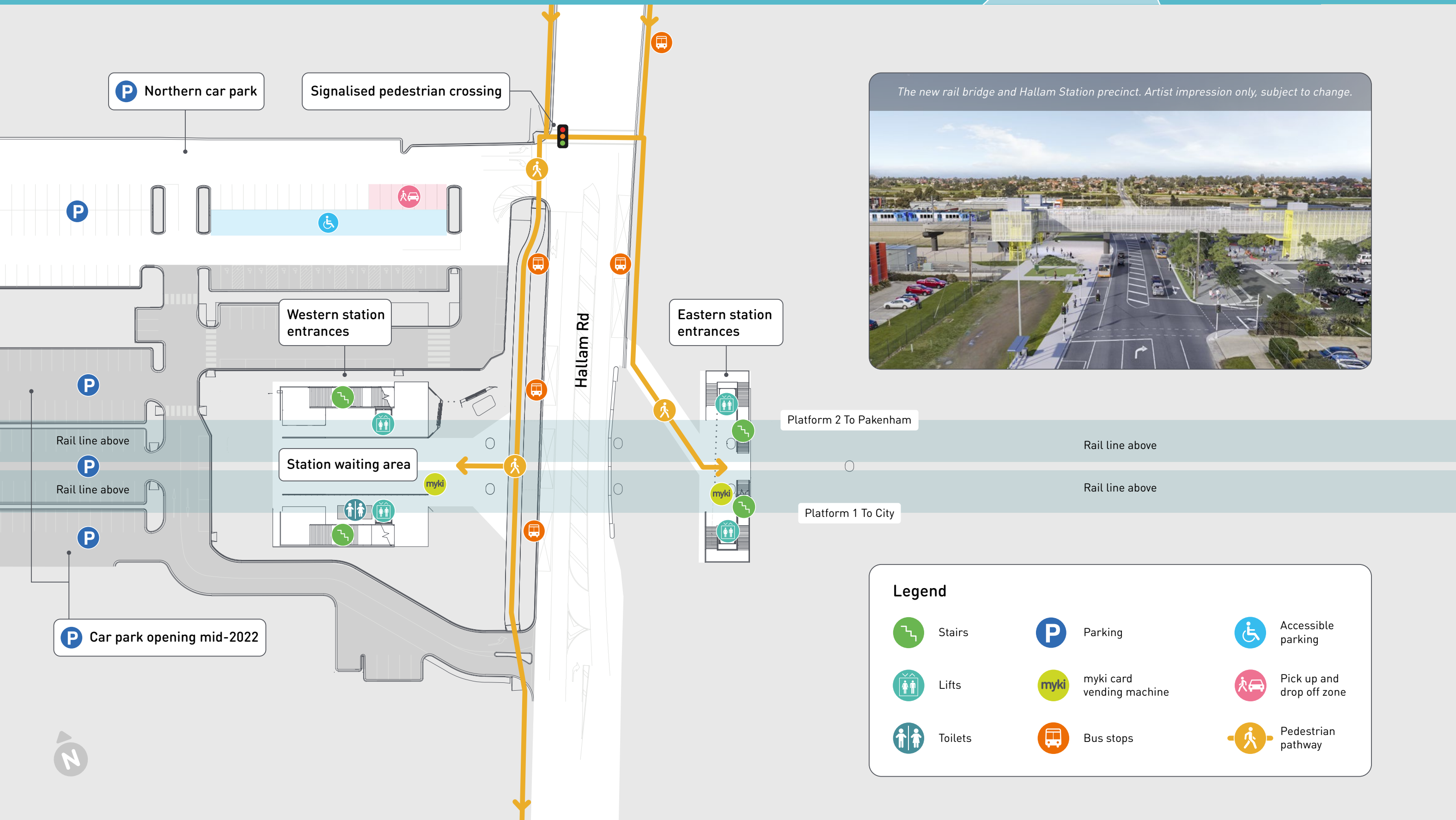

The new rail bridge and Hallam Station precinct. Artist impression only, subject to change.



Legend

- Stairs
- Lifts
- Toilets
- Parking
- myki card vending machine
- Bus stops
- Accessible parking
- Pick up and drop off zone
- Pedestrian pathway

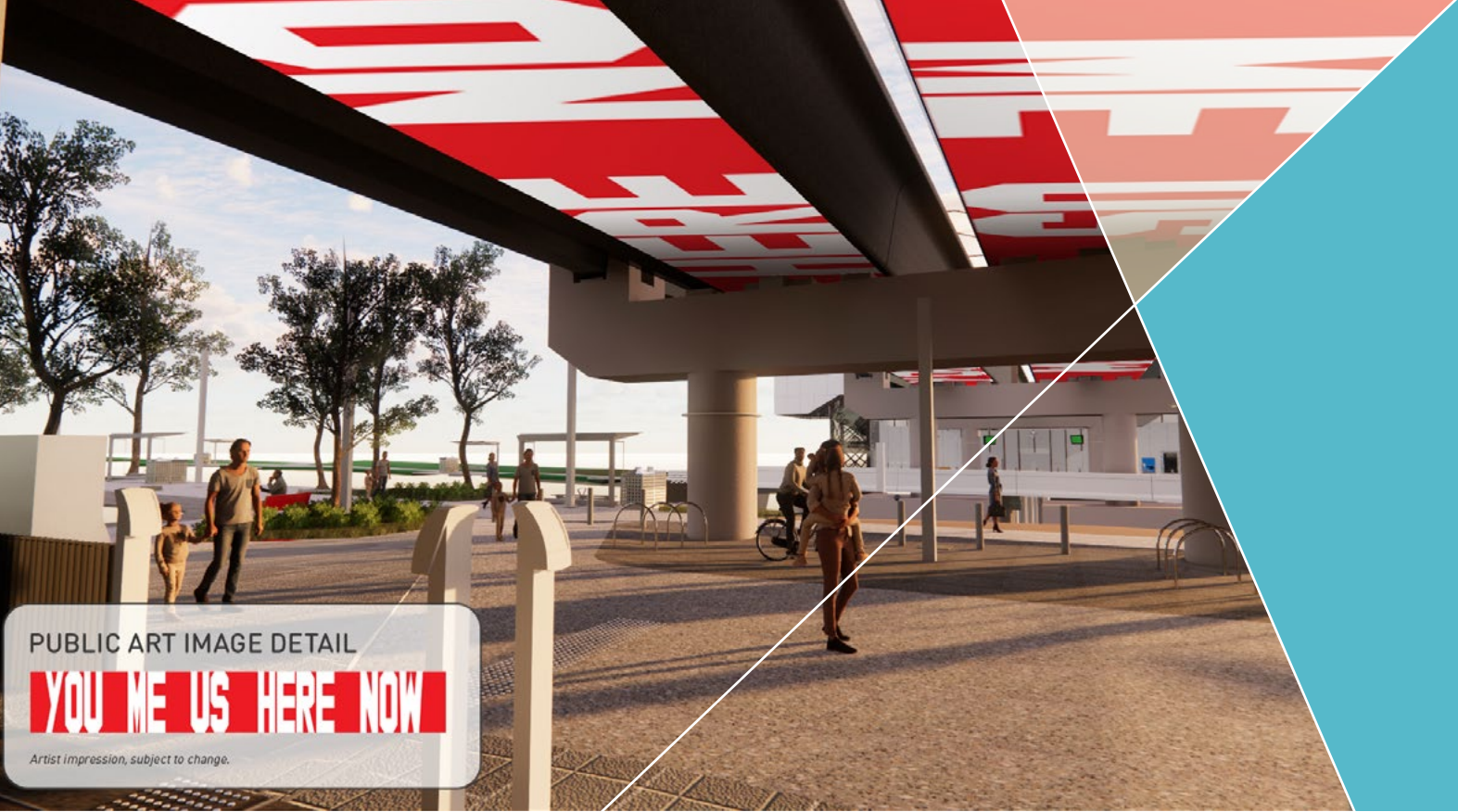

New station artwork by Australian artist, Rose Nolan. Artist impression only, subject to change

YOU ME US HERE NOW

The new rail bridge will be brought to life with a bold and vivid artwork by internationally-renowned Australian artist, Rose Nolan.

The artwork is titled *You Me Us Here Now* and provides a positive and unifying refrain that draws on the notion of shared journeys and the experience of travel and movement.

The bi-directional nature of the commuter's travel is reflected in the repeated phrase appearing underneath the rail bridge, in opposite directions.

Sustainability at Hallam



Solar-powered caravans on site saved about 2.7 tonnes of carbon emissions every week



Four water tanks each holding 40,000 litres of rainwater captured on site, which was then reused in construction processes



Grid-powered lighting, rather than diesel, saved thousands of litres of diesel fuel and several tonnes of carbon emissions

To find out more about the steps taken to manage the environment at Hallam, visit [levelcrossings.vic.gov.au/media/publications/hallam-road,-hallam-managing-the-environment-fact-sheet](https://www.levelcrossings.vic.gov.au/media/publications/hallam-road,-hallam-managing-the-environment-fact-sheet)



Scan the QR code to learn how we looked after the endangered Dwarf Galaxias fish



Georgia from the Environmental and Sustainability team testing the water quality of the Dwarf Galaxias' habitat

Thank you, Hallam

Thank you for your patience as we completed these important infrastructure works in your area.

Before the level crossing was removed, more than 20,000 vehicles travelled along Hallam Road each day, where the boom gates were down for more than a third of the morning peak.

Early works started in October 2020, the level crossing was removed in April 2022. The project will be fully completed in mid-2022.

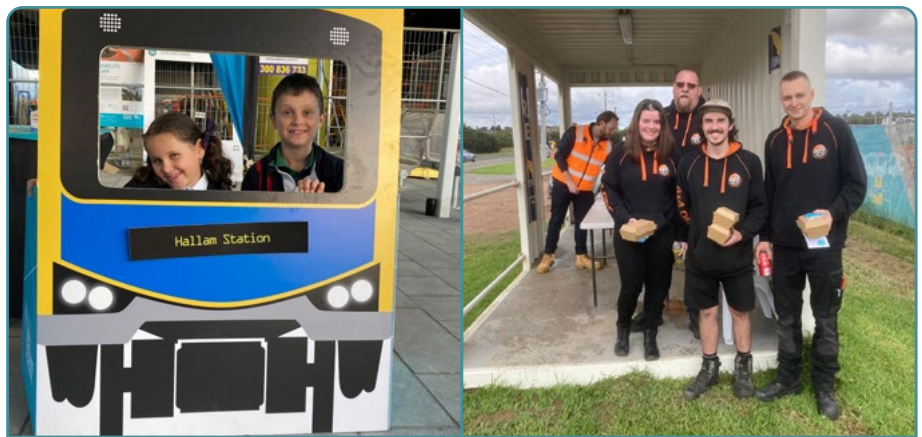

Thanks for being a part of the Hallam Road Level Crossing Removal Project

*Left: local children enjoy the activities on day one of the new Hallam Station opening
Right: local traders enjoy a free lunch to celebrate the new station opening*

New lifts being installed on both sides of Hallam Road



Project timeline

- ✓ **Late 2020**
 - Major works begin
- ✓ **Mid-2021**
 - Underground works complete
 - First deliveries of the main bridge structures
 - Bridge construction commences
- ✓ **Late-2021**
 - Rail bridge construction continues
 - Construction of the new Hallam Station begins
- ✓ **2022**
 - Level crossing gone for good
 - New station open

Timeline above subject to change

CONTACT US

contact@levelcrossings.vic.gov.au
1800 105 105
Level Crossing Removal Project
GPO Box 2392, Melbourne VIC 3001

Follow us on social media
@levelcrossings



Translation service – For languages other than English, please call 9209 0147.

Please contact us if you would like this information in an accessible format.

If you need assistance because of a hearing or speech impairment, please visit relayservice.gov.au