



DOMAIN PRECINCT COMMUNITY REFERENCE GROUP

Presentation by CYP

4 December 2024



OFFICIAL: Sensitive

ACTIONS AND ISSUES

ACTIONS AND ISSUES



#	DATE RAISED	ACTION / ISSUE	OWNER	STATUS	DATE CLOSED
A54-3	8 May 2024	CYP to provide an update on the handover of public spaces and their opening to the public.	CYP	Ongoing	
A55-1	5 June 2024	MTPO to continue monitoring the implemented design	MTPO	Ongoing	
A58-1	30 October 2024	CYP and MTPO to confirm if the 4 December 2024 CRG meeting will occur face-to-face.	CYP/MTPO	Closed. Post meeting note: The CRG meeting on 4 December 2024 will occur in-person. Further details to be provided by MTPO.	22 November 2024

WORKS UPDATE

STATION CONSTRUCTION

WORKS UPDATE

SHRINE OF REMEMBRANCE ENTRANCE



- Landscaping works around the Shrine of Remembrance entrance are complete
- The stairs from Domain Road to the Shrine parklands are now open
- Minor rectification works are ongoing



WORKS UPDATE

EDMUND HERRING OVAL



- Reinstatement works are complete at Edmund Herring Oval
- The area will remain fenced off pending grass establishment and handover to City of Melbourne



WORKS UPDATE

ALBERT ROAD RESERVE



- The Albert Road Reserve area was reopened to the public in late November, including the South African Soldier's Memorial and barbeque shelter
- Minor rectification works are ongoing





WORKS UPDATE

ST KILDA ROAD



- Hoarding on the tram stop has been reduced and is now in the long-term arrangement
- The existing hoarding will be removed prior to Day 1 operations
- Hoop fencing was installed last week along St Kilda Road, adjacent to the chiller and ventilation structures
- The temporary black fencing is being removed this week



WORKS UPDATE

ALBERT ROAD PAVEMENT WORKS



- Works to widen the passing bay on Albert Road, in front The Domain, are being arranged
- A granite bench will be removed and the garden bed will be adjusted as part of these works
- Traffic arrangements for these works are being confirmed



ANZAC STATION SITE MAP



MAINTENANCE RESPONSIBILITY MAP

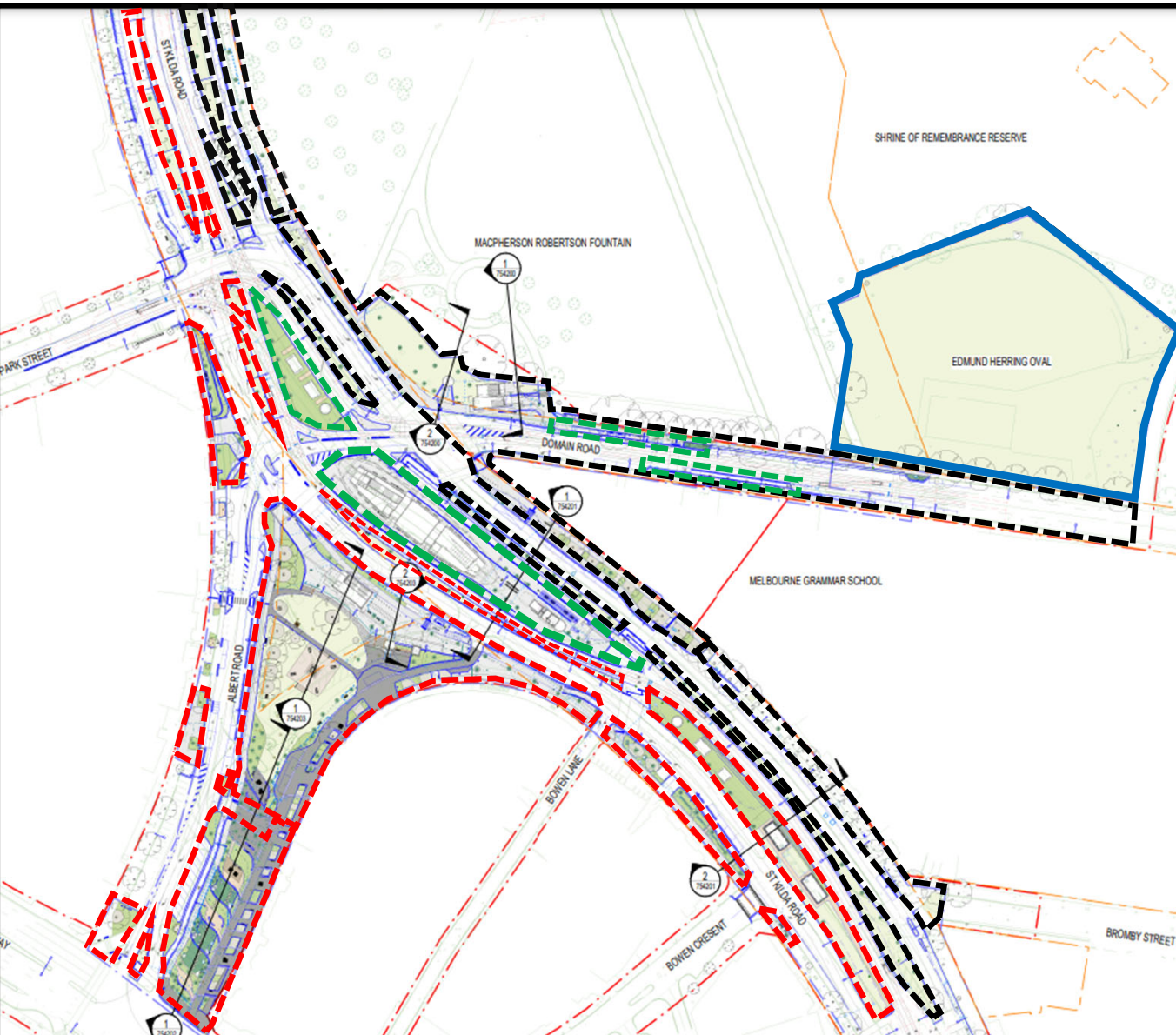

Maintenance responsibility map

- CYP
- - - City of Port Phillip
- - - City of Melbourne
- - - Yarra Trams

Key areas:

Roads

- St Kilda Road – Dept of Transport
- Albert Road – City of Port Phillip
- Domain Road – City of Melbourne

Operational Infrastructure

- Tram platform (incl. rubbish bins) Yarra Trams
- Station infrastructure (Including vents, chiller plant and entrances) Metro Trains Melbourne

PROJECT WIDE UPDATE



COMMUNICATIONS UPDATE

COMMUNICATIONS UPDATE



- Monthly construction update frequency
- Next Domain CRG
- Metro Tunnel in 2025

OTHER BUSINESS